

RICK ENGINEERING COMPANY ASSUMES NO RESPONSIBILITY FOR UTILITY LOCATIONS. THE UTILITIES SHOWN ON THIS DRAWING HAVE BEEN PLOTTED FROM THE BEST AVAILABLE INFORMATION. IT IS, HOWEVER, THE CONTRACTOR'S RESPONSIBILITY TO FIELD VERIFY THE LOCATION OF ALL UTILITIES PRIOR TO CONSTRUCTION.

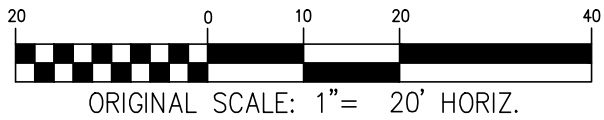

LEGEND:

- FIRE TRUCK BUMPER
- FIRE TRUCK TIRE PATH

HIGHLINE VILLAGE PLING NO 2  
LOT 2, BLOCK 1  
RECEPTION NO. B433720

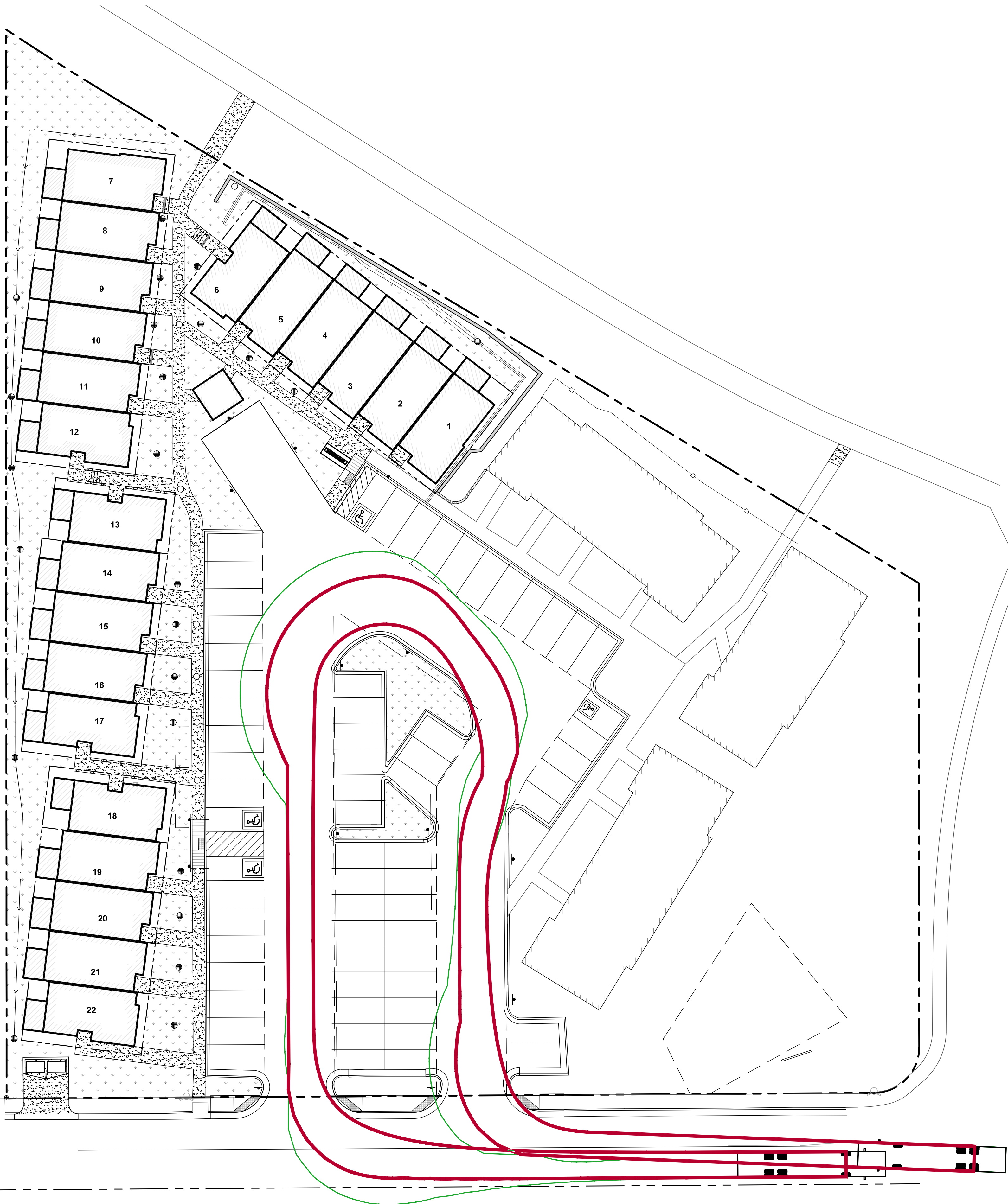

SITE PLAN AMENDMENT

HIGHLINE VILLAGE  
CITY OF AURORA

**RICK**  
ENGINEERING COMPANY

5690 WEBSTER ST  
ARVADA, CO 80002  
303.423.6036  
Tucson - San Diego - Riverside - Orange - Denver  
Sacramento - San Luis Obispo - Phoenix - Las Vegas  
rickengineering.com



REVISIONS		DATE:
NO.	DESCRIPTION	

SCALE: 1"=20'  
DATE: 07/15/2020  
DRAWN BY: RP  
CHECKED BY: DAK  
JOB NO: 1243

FIRE TRUCK  
TURNING  
EXHIBIT

DRAWING NAME 2020-06-02 Turning\_ex

SHEET NO. 1 OF 1