

A PARCEL OF LAND BEING A PART OF THE NORTHWEST QUARTER (NW 1/4) OF SECTION 26,
TOWNSHIP 4 SOUTH, RANGE 67 WEST OF THE 6TH PRINCIPAL MERIDIAN, CITY OF AURORA,
COUNTY OF ARAPAHOE, STATE OF COLORADO

[illegible]

SHEET 1 OF 2

A.L.T.A./N.S.P.S. Land Title Survey

A PARCEL OF LAND BEING A PART OF THE NORTHWEST QUARTER (NW 1/4) OF SECTION 26,
TOWNSHIP 4 SOUTH, RANGE 67 WEST OF THE 6TH PRINCIPAL MERIDIAN, CITY OF AURORA,
COUNTY OF ARAPAHOE, STATE OF COLORADO

SHEET 2 OF 2

LOT DETAILS

Scale: 1"=20'

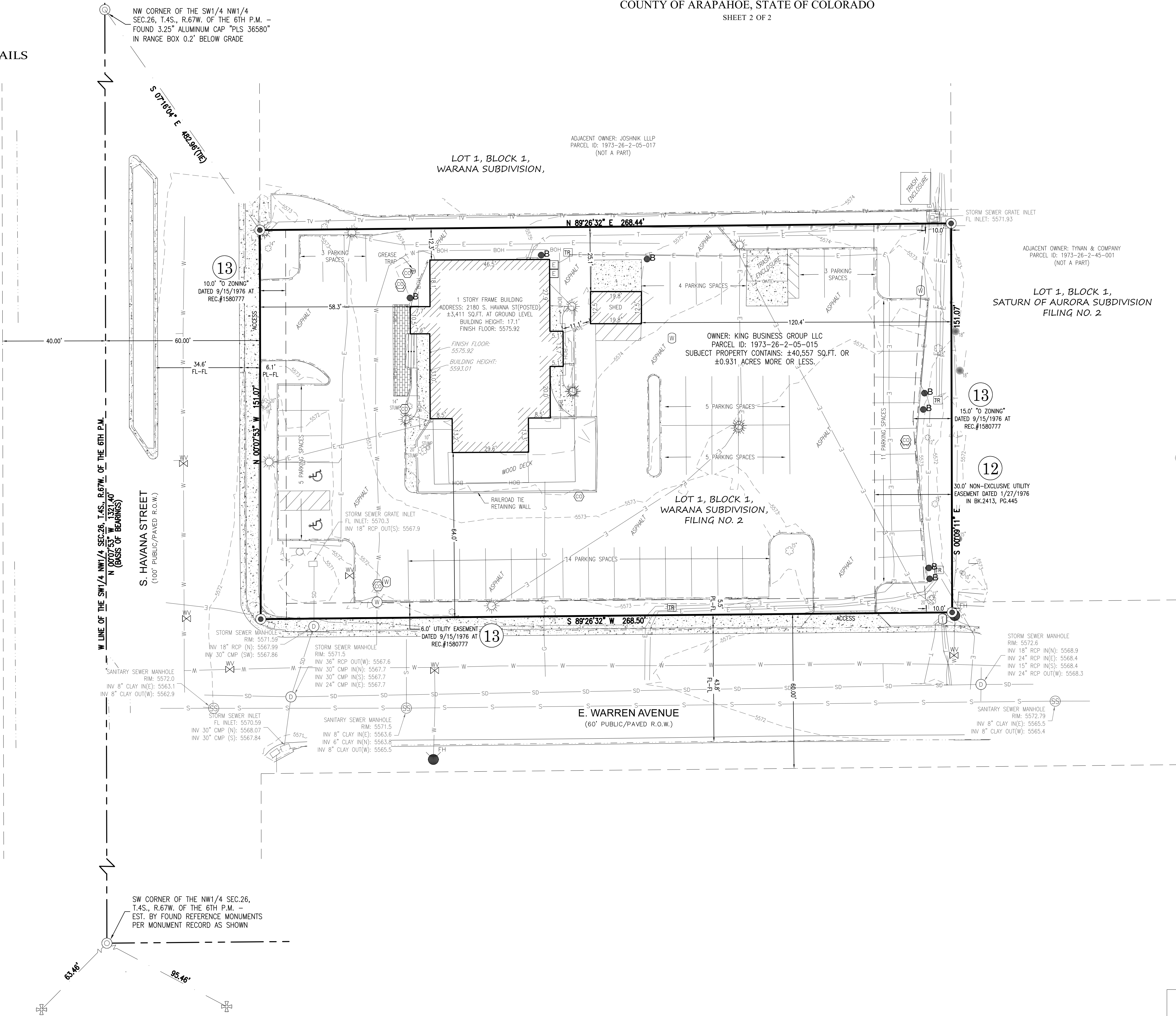

LEGEND - LINETYPE & SYMBOLS

- | | | |
|---|-----|---------------------|
| SET 1.25" YELLOW PLASTIC CAP OR 1" BRASS TAG STAMPED P.L.S. 37929 | BOH | PARKING STRIPING |
| FOUND MONUMENT AS NOTED | --- | BUILDING OVERHANG |
| FOUND CHISELED CROSS OR X | --- | LOT LINES |
| ELECTRIC BOX | --- | EASEMENT AS NOTED |
| CALLOUT | --- | 5' CONTOUR-MAJOR |
| TRANSFORMER | --- | 1' CONTOUR-MINOR |
| BOLLARD | --- | FLOW LINE |
| TELEPHONE PEDESTAL | --- | ELECTRIC LINE |
| LIGHT POLE | --- | FENCE-WROUGHT IRON |
| SIGN | --- | FENCE-WOOD |
| CLEANOUT | --- | GAS LINE |
| STORM SEWER MANHOLE | --- | GATE |
| TREE W/ CALIPER SIZE | --- | SECTION LINE |
| MONITORING WELL | --- | SANITARY SEWER LINE |
| WATER MANHOLE | --- | STORM SEWER LINE |
| WATER VALVE | --- | TELEPHONE LINE |
| FIRE HYDRANT | --- | TV LINE |
| MANHOLE-AS NOTED | --- | WATER LINE |
| SANITARY SEWER MANHOLE | --- | |

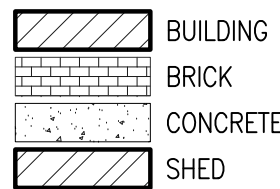

R.O.W. RIGHT-OF-WAY
EOA EDGE OF ASPHALT
OHU OVERHEAD UTILITY LINE
EOA EDGE OF ASPHALT
FL FLOWLINE
PL PROPERTY LINE

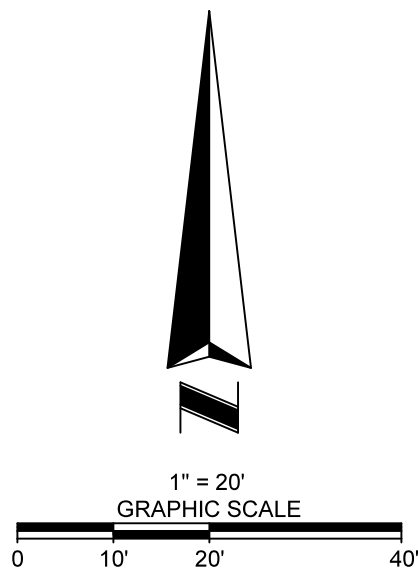

TYPE OF SUBMITTAL:	ALTA / NSPS
PREPARATION DATE:	DECEMBER 10, 2024
REVISION DATE:	
REVISION DATE:	
DRAWN BY: JRY	REVIEWED BY: RBG
JOB NO. 501-24-212	DWG: 24-212 ALTA.dwg

SHEET 2 OF 2