

900 south broadway  
suite 320  
denver, co 80209  
p 303.561.3333  
waremalcomb.com

WARE MALCOMB

CIVIL ENGINEERING & SURVEYING

FOR AND ON BEHALF  
OF WARE MALCOMB

PICADILLY CROSSING SUBDIVISION FILING NO. 1

21291 E. 6TH AVE.

AURORA, CO 80018

TRUCK TURN TEMPLATE

NO. DATE REMARKS

JOB NO.:	DEN22-0154
PA / PM:	MIN
DESIGNED:	TS
DATE:	09/13/2024
PLOT DATE:	09/27/24

SHEET

T1

Sheet of

NOT FOR CONSTRUCTION

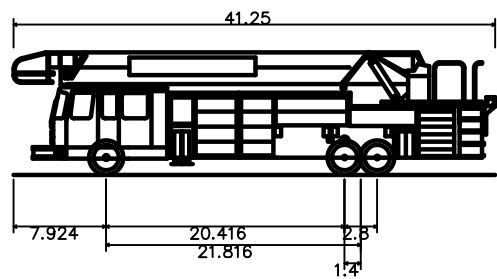

City of Aurora Firetruck  
Overall Length 41.250ft  
Overall Width 8.350ft  
Overall Body Height 10.489ft  
Min Body Ground Clearance 0.920ft  
Track Width 8.350ft  
Lock-to-lock time 6.00s  
Curb to Curb Turning Radius 47.000ft

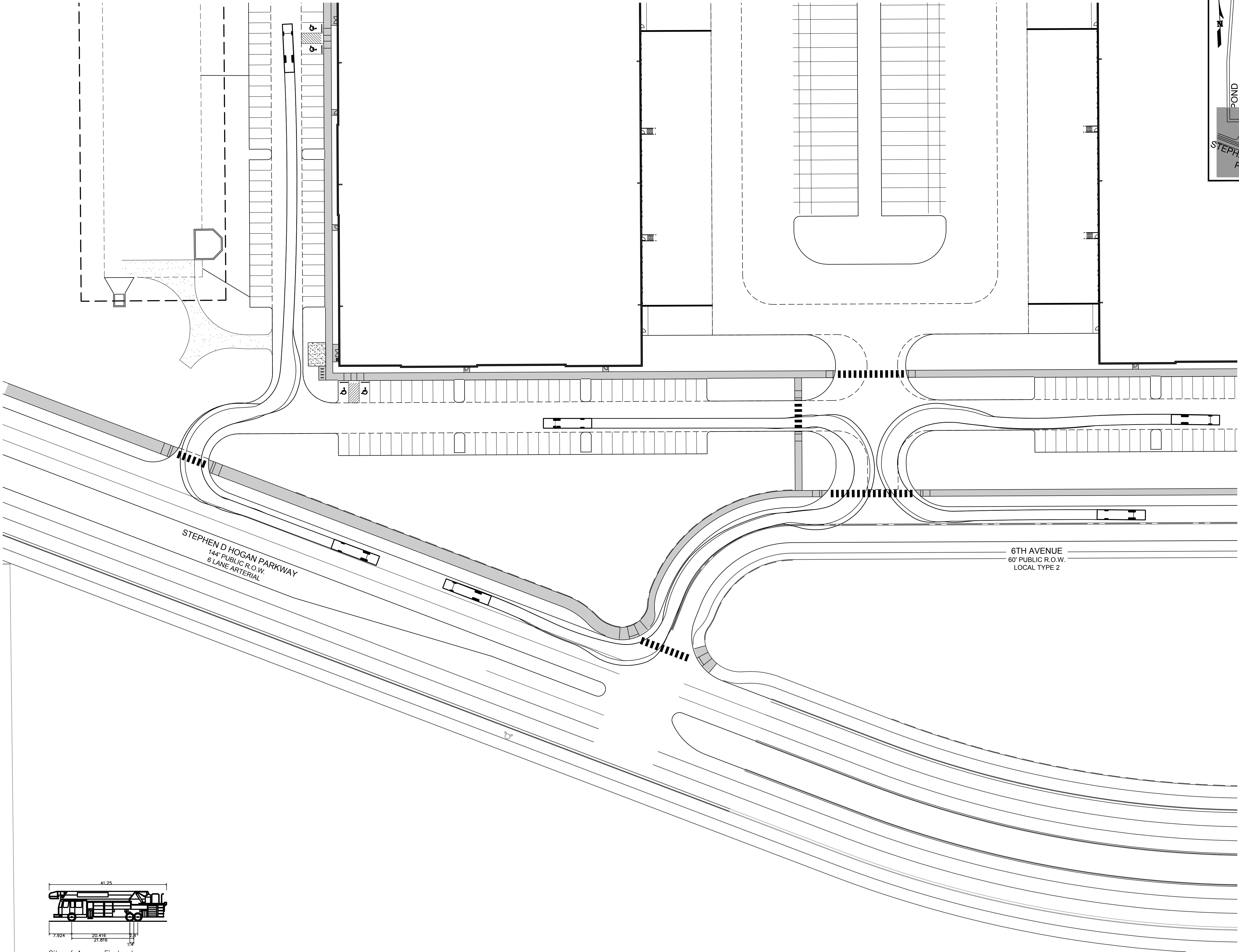
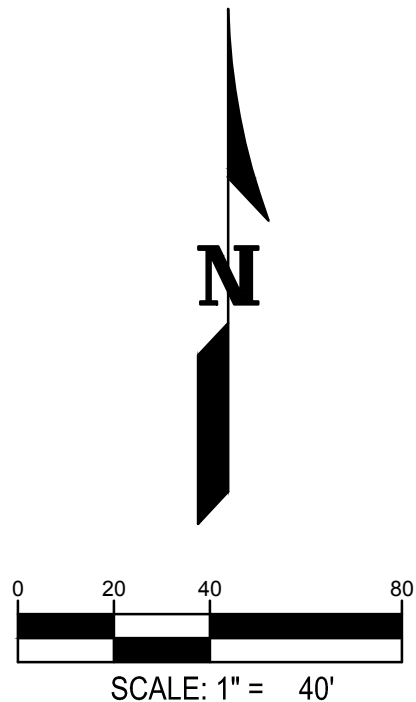

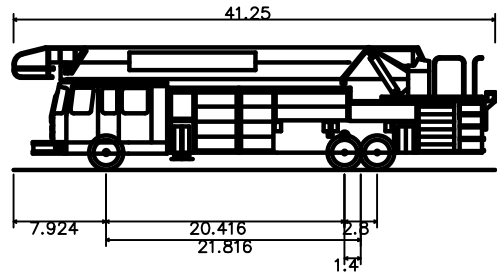
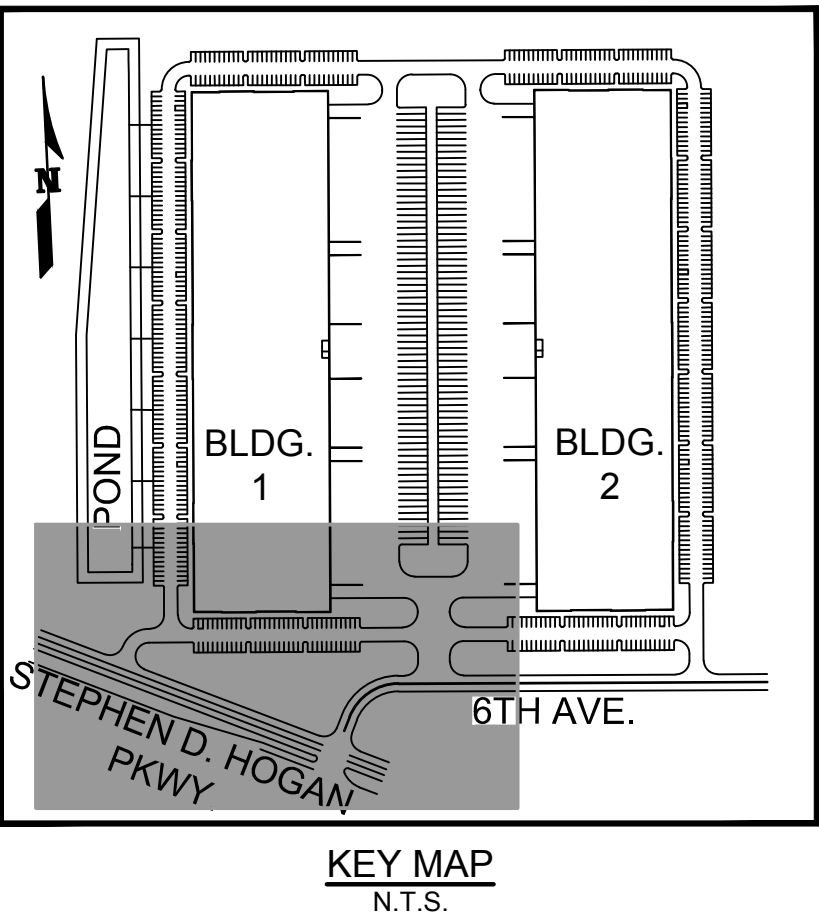
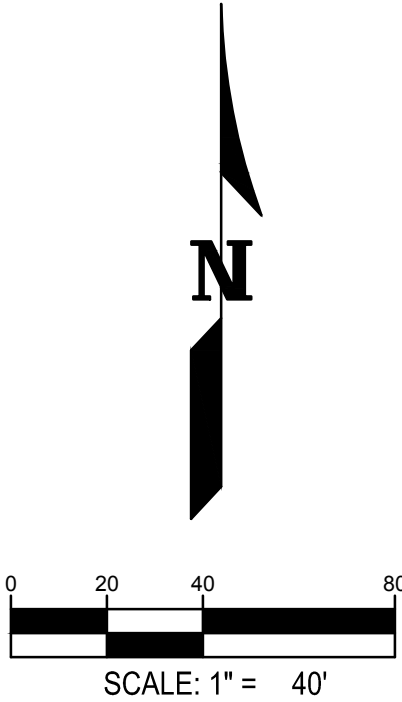
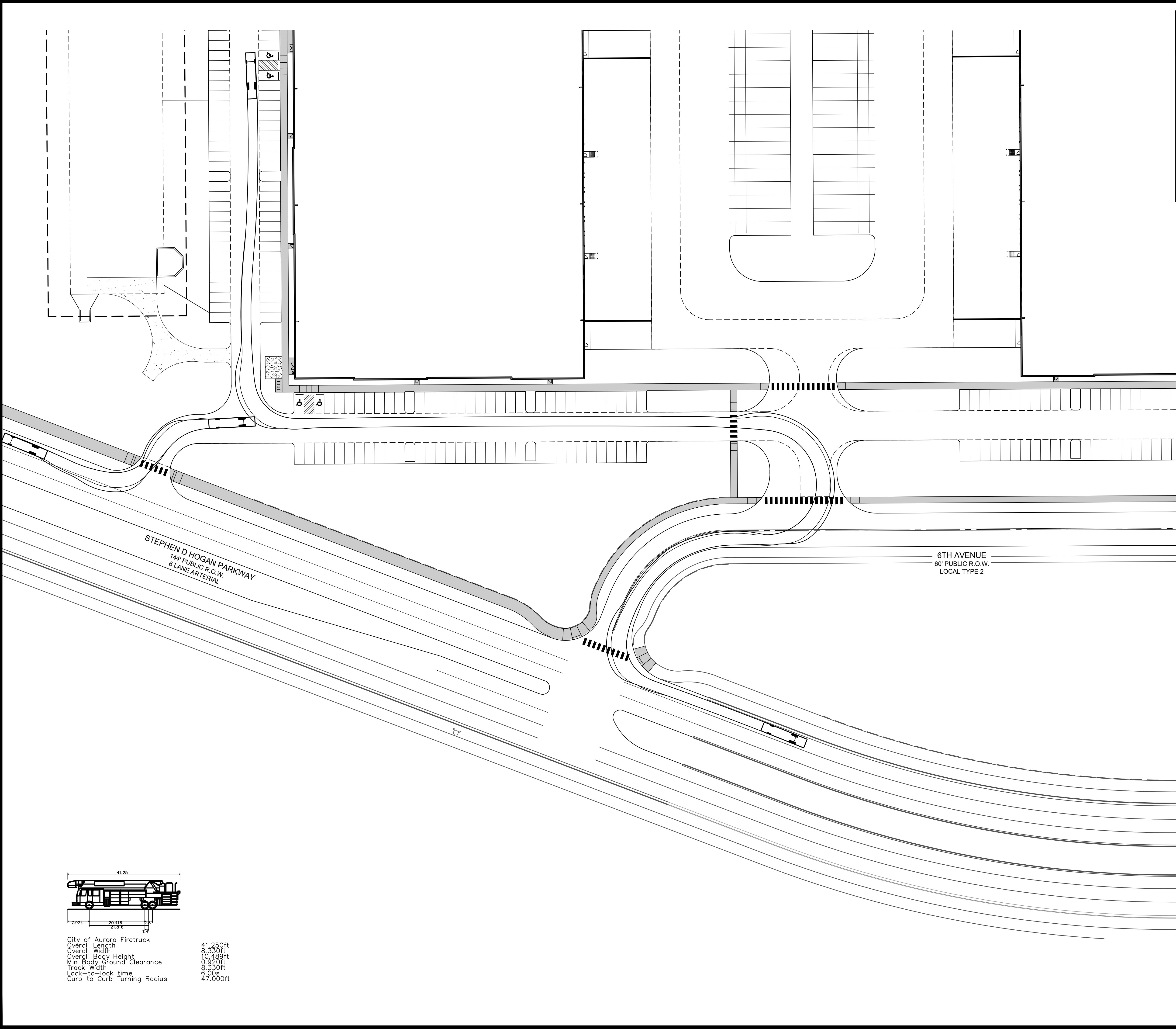

City of Aurora Firetruck  
Overall Length 41.250ft  
Overall Width 8.350ft  
Overall Body Height 10.489ft  
Min. Body Ground Clearance 0.920ft  
Track Width 8.350ft  
Lock-to-lock time 6.00s  
Curb to Curb Turning Radius 47,000ft

**WARE MALCOMB**  
CIVIL ENGINEERING & SURVEYING

900 south broadway  
suite 320  
denver, co 80209  
p 303.561.3333  
waremalcomb.com

FOR AND ON BEHALF  
OF WARE MALCOMB

PICADILLY CROSSING SUBDIVISION FILING NO. 1  
21291 E. 6TH AVE.  
AURORA, CO 80018  
TRUCK TURN TEMPLATE

NO.	DATE	REMARKS

JOB NO.:	DEN22-0154
PA / PM:	MIN
DESIGNED:	TS
DATE:	09/13/2024
PLOT DATE:	09/27/24

SHEET  
**T2**

Sheet of

THESE DRAWINGS AND SPECIFICATIONS ARE THE PROPERTY AND COPYRIGHT OF WARE MALCOMB AND SHALL NOT BE USED ON ANY OTHER WORK EXCEPT BY AGREEMENT WITH WARE MALCOMB. WRITTEN DIMENSIONS SHALL TAKE PRECEDENCE OVER SCALED DIMENSIONS AND SHALL BE VERIFIED ON THE JOB SITE. ANY DISCREPANCY SHALL BE BROUGHT TO THE NOTICE OF WARE MALCOMB PRIOR TO THE COMMENCEMENT OF ANY WORK.

NOT FOR CONSTRUCTION



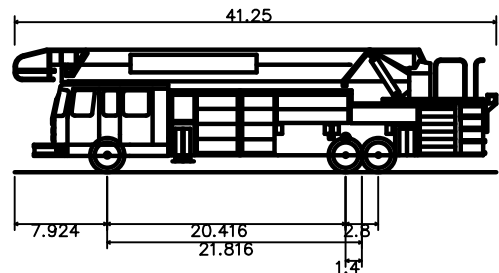

City of Aurora Firetruck  
Overall Length 41.250ft  
Overall Width 7.924ft  
Overall Body Height 20.416ft  
Min Body Ground Clearance 21.816ft  
Track Width 1.5ft  
Lock-to-lock time 6.00s  
Curb to Curb Turning Radius 47.000ft

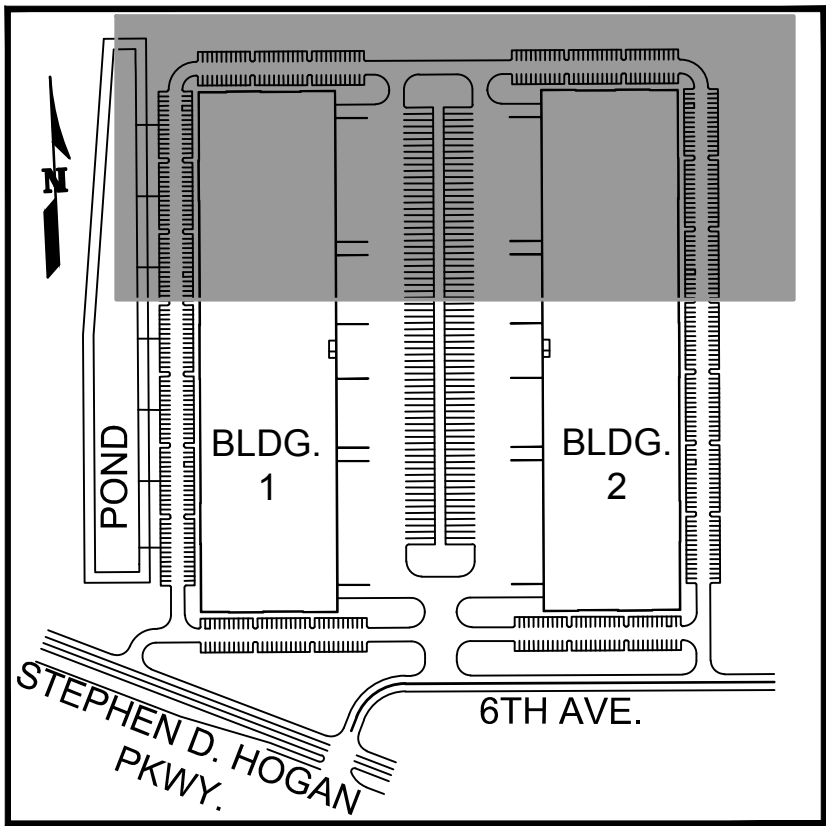
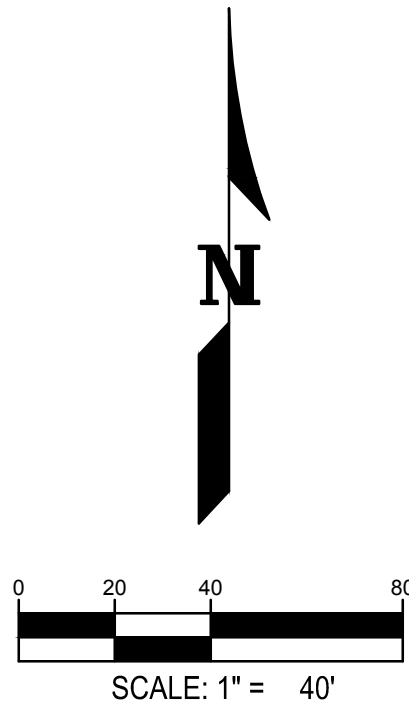

KEY MAP  
N.T.S.

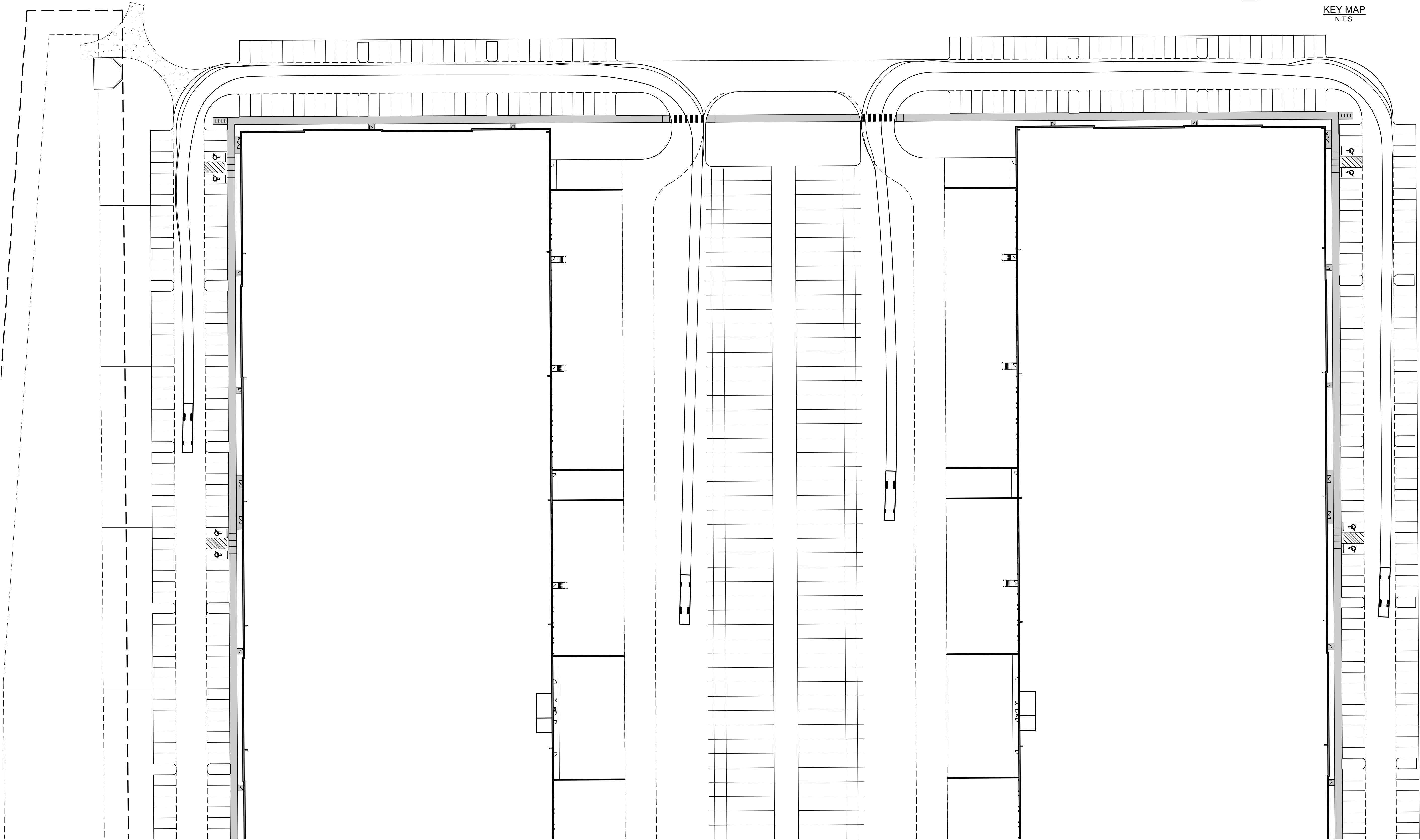

900 south broadway  
suite 320  
denver, co 80209  
p 303.561.3333  
waremalcomb.com

FOR AND ON BEHALF  
OF WARE MALCOMB

PICADILLY CROSSING SUBDIVISION FILING NO. 1  
21291 E. 6TH AVE.  
AURORA, CO 80018  
TRUCK TURN TEMPLATE

NO.	DATE	REMARKS

JOB NO.:	DEN22-0154
PA / PM:	MIN
DESIGNED:	TS
DATE:	09/13/2024
PLOT DATE:	09/27/24



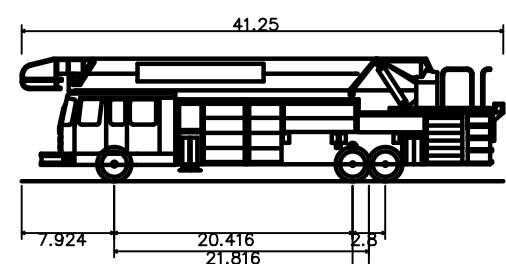

City of Aurora Firetruck	
Overall Length	41.250ft
Overall Width	8.330ft
Overall Body Height	10.489ft
Min Body Ground Clearance	0.920ft
Track Width	8.330ft
Lock-to-lock time	6.00s
Curb to Curb Turning Radius	47.000ft

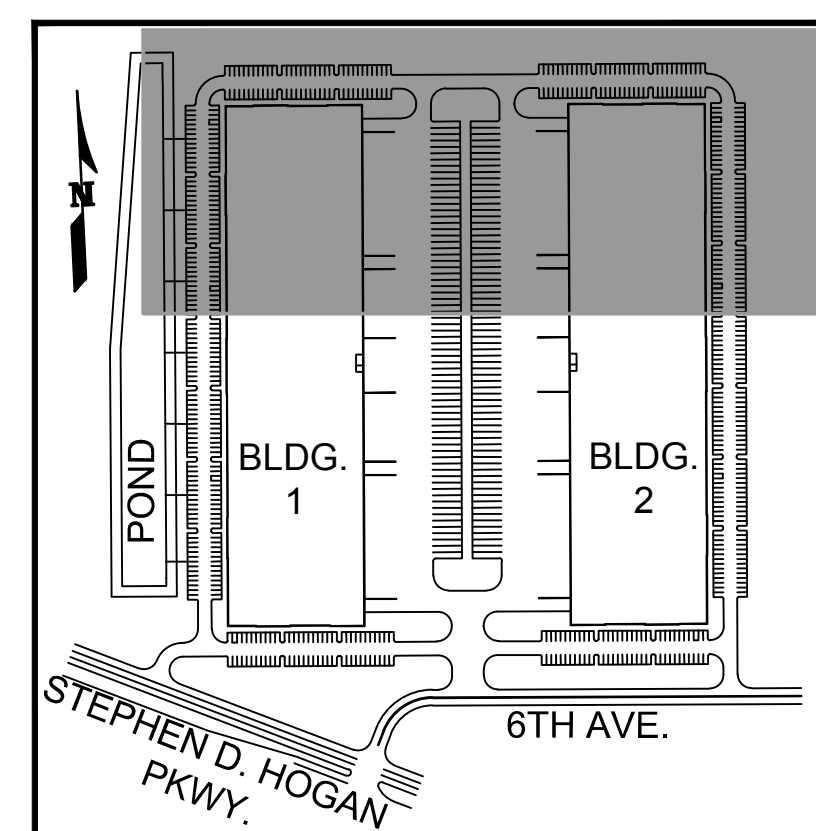
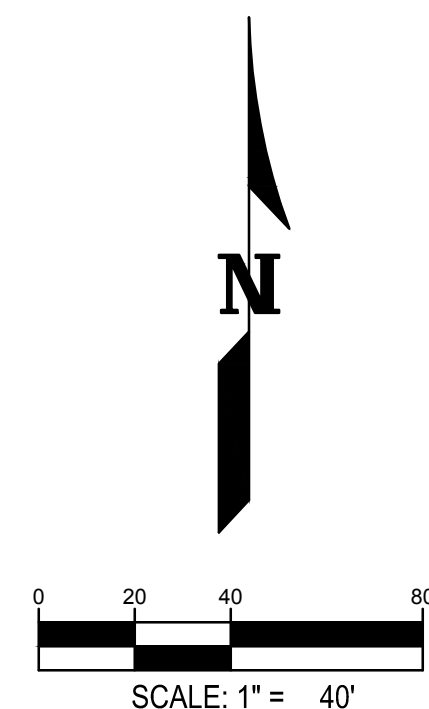

900 south broadway  
suite 320  
denver, co 80209  
co 303.561.3333  
waremalcomb.com

FOR AND ON BEHALF  
OF WARE MAIL COM

PICADILLY CROSSING SUBDIVISION FILING NO. 1

21291 E. 6TH AVE.  
AURORA, CO 80018  
TRUCK TURN TEMPLATE

[illegible]

JOB NO.:	DEN22-0154
PA / PM:	MN
DESIGNED:	TS
DATE:	09/13/2024
PLOT DATE:	09/27/24

SHEET  
T5

Sheet of