















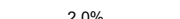

- | | |
|---|--|
|  | RIGHT-OF-WAY LINE |
|  | PROPOSED EASEMENT |
|  | PROPOSED 5' CONTOUR |
|  | PROPOSED 1' CONTOUR |
|  | EXISTING 5' CONTOUR |
|  | EXISTING 1' CONTOUR |
|  | TYPICAL PROPOSED BASIN BOUNDARY
(COLOR CORRESPONDS TO OUTFALL POND)
(BLUE FLOWS TO SAND CREEK) |
|  | PROPOSED STORM |
|  | PROPOSED INLET |
|  | PROPOSED STORM MANHOLE |
|  | EXISTING STORM |
|  | EXISTING INLET |
|  | EXISTING STORM MANHOLE |
|  | FLOW DIRECTION |
|  | 2.0% |
|  | DESIGN POINT |
|  | PROPOSED FIRE HYDRANT. |
|  | EMERGENCY OVERFLOW ARROW |
-
- | | |
|---|---|
| PROPOSED BASIN LABEL | |
|  | BASIN DESIGNATION
MINOR 2-YR RUNOFF COEF.
MAJOR 100-YR RUNOFF COEF. |

NOTES:

1. CITY OF AURORA PLAN REVIEW IS ONLY FOR GENERAL CONFORMANCE WITH CITY OF AURORA DESIGN CRITERIA AND THE CITY CODE. THE CITY IS NOT RESPONSIBLE FOR THE ACCURACY AND ADEQUACY OF THE DESIGN, OF DIMENSIONS AND ELEVATIONS WHICH MUST BE CONFIRMED AND CORRELATED AT THE JOB SITE. THE CITY OF AURORA, THROUGH THE APPROVAL OF THIS DOCUMENT, ASSUMES NO RESPONSIBILITY FOR THE COMPLETENESS AND / OR ACCURACY OF THIS DOCUMENT.
2. APPROVAL OF THIS DOCUMENT BY CITY OF AURORA DOES NOT IMPLY APPROVAL FOR ANY OFF-SITE WORK ON ADJACENT PRIVATE PROPERTY. IT IS THE OWNER'S RESPONSIBILITY TO COORDINATE WITH ADJACENT PROPERTY OWNERS AND OBTAIN ALL NECESSARY PERMITS AND EASEMENTS, IF SUCH.
3. APPLICANT UNDERSTANDS RECERTIFICATION MAY BE REQUIRED, IF A POND CERTIFICATE, AN EXECUTED I&M PLAN, OR DRAINAGE EASEMENTS DO NOT EXIST, THE APPLICANT WILL BE REQUIRED TO PROVIDE THESE PRIOR TO CIVIL PLAN APPROVAL.
4. ALL STORM INFRASTRUCTURE IS PRIVATE AND SIZED FOR THE 100-YEAR STORM EVENT.
5. APPLICANT UNDERSTANDS THAT WORK IN 100-YEAR FLOODPLAIN REQUIRES A FLOODPLAIN DEVELOPMENT PERMIT WHICH MUST BE OBTAINED PRIOR TO GRADING OR CONSTRUCTION WITHIN THE FLOODPLAIN.

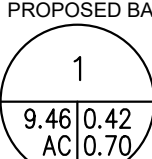
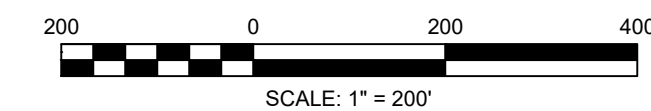

RUNOFF SUMMARY TABLE						
BASIN	AREA (AC)	C2	C100	IMPERV %	Q ₂ (CFS)	Q ₁₀₀ (CFS)
1.A	0.15	0.65	0.81	80.0%	0.3	1.0
1.B	0.38	0.48	0.73	59.5%	0.5	2.2
1.C	0.08	0.78	0.87	95.0%	0.2	0.6
1.D	0.42	0.29	0.64	37.9%	0.2	1.5
1.E	0.21	0.48	0.75	60.2%	0.2	1.0
1.F	0.29	0.36	0.67	45.9%	0.3	1.3
1.G	0.75	0.48	0.73	60.0%	0.9	4.0
1.H	0.80	0.46	0.72	57.5%	0.8	3.7
1.I	1.04	0.50	0.74	62.5%	1.2	4.9
1.J	0.38	0.51	0.76	63.9%	0.5	2.2
1.K	0.38	0.49	0.74	61.4%	0.5	2.0
1.L	0.17	0.72	0.87	87.4%	0.4	1.2
1.M	0.36	0.59	0.78	72.1%	0.5	2.1
1.N	0.90	0.42	0.70	52.5%	1.1	5.2
1.O	0.58	0.25	0.62	32.9%	0.3	1.9
1.P	1.31	0.31	0.65	40.0%	1.0	6.0
1.Q	0.81	0.31	0.65	40.0%	0.4	2.5
1.R	0.22	0.43	0.71	54.1%	0.2	1.1
TOTAL TO POND 374	9.23	0.42	0.70	53.3%	9.5	44.3
2.A	0.99	0.46	0.72	57.1%	1.2	5.2
2.B	0.46	0.16	0.58	23.3%	0.2	1.6
2.C	0.31	0.26	0.63	34.5%	0.2	1.5
TOTAL TO POND A-10	1.76	0.35	0.67	44.3%	1.5	8.2
OS	0.28	0.39	0.69	49.5%	0.3	1.3
TOTAL TO SAND CREEK	0.28	0.39	0.69	49.5%	0.3	1.3

Approved For One Year From This Date

Aurora Water - Drainage Division

Date _____

FITZSIMONS INNOVATION CAMPUS
SCRANTON PARKWAY SITE PLAN

TITLE: OVERALL DRAINAGE PLAN

DATE: MARCH 2025

PREPARED BY:



Excellence by Design

707 17th Street, Suite 3150

Denver, Colorado 80202

P 303.572.0200

www.matrixdesigngroup.com

QUEST

SHEET

NOT FOR CONSTRUCTION



SHEET:01

RUNOFF SUMMARY TABLE						
BASIN	AREA (AC)	C2	C100	IMPERV %	Q ₂ (CFS)	Q ₁₀₀ (CFS)
1.A	0.15	0.65	0.81	80.0%	0.3	1.0
1.B	0.38	0.48	0.73	59.5%	0.5	2.2
1.C	0.08	0.78	0.87	95.0%	0.2	0.6
1.D	0.42	0.29	0.64	37.9%	0.2	1.5
1.E	0.21	0.48	0.75	60.2%	0.2	1.0
1.F	0.29	0.36	0.67	45.9%	0.3	1.3
1.G	0.75	0.48	0.73	60.0%	0.9	4.0
1.H	0.80	0.46	0.72	57.5%	0.8	3.7
1.I	1.04	0.50	0.74	62.5%	1.2	4.9
1.J	0.38	0.51	0.76	63.9%	0.5	2.2
1.K	0.38	0.49	0.74	61.4%	0.5	2.0
1.L	0.17	0.72	0.87	87.4%	0.4	1.2
1.M	0.36	0.59	0.78	72.1%	0.5	2.1
1.N	0.90	0.42	0.70	52.5%	1.1	5.2
1.O	0.58	0.25	0.62	32.9%	0.3	1.9
1.P	1.31	0.31	0.65	40.0%	1.0	6.0
1.Q	0.81	0.31	0.65	40.4%	0.4	2.5
1.R	0.22	0.43	0.71	54.1%	0.2	1.1
TOTAL TO POND 374	9.23	0.42	0.70	53.3%	9.5	44.3
2.A	0.99	0.46	0.72	57.1%	1.2	5.2
2.B	0.46	0.16	0.58	23.3%	0.2	1.6
2.C	0.31	0.26	0.63	34.5%	0.2	1.5
TOTAL TO POND A-10	1.76	0.35	0.67	44.3%	1.5	8.2
OS	0.28	0.39	0.69	49.5%	0.3	1.3
TOTAL TO SAND CREEK	0.28	0.39	0.69	49.5%	0.3	1.3

NOTES:

- CITY OF AURORA PLAN REVIEW IS ONLY FOR GENERAL CONFORMANCE WITH CITY OF AURORA DESIGN CRITERIA AND THE CITY CODE. THE CITY IS NOT RESPONSIBLE FOR THE ACCURACY AND ADEQUACY OF THE DESIGN, OF DIMENSIONS AND ELEVATIONS WHICH MUST BE CONFIRMED AND CORRELATED AT THE JOB SITE. THE CITY OF AURORA, THROUGH THE APPROVAL OF THIS DOCUMENT, ASSUMES NO RESPONSIBILITY FOR THE COMPLETENESS AND / OR ACCURACY OF THIS DOCUMENT.
- APPROVAL OF THIS DOCUMENT BY CITY OF AURORA DOES NOT IMPLY APPROVAL FOR ANY OFF-SITE WORK ON ADJACENT PRIVATE PROPERTY. IT IS THE OWNER'S RESPONSIBILITY TO COORDINATE WITH ADJACENT PROPERTY OWNERS AND OBTAIN ALL NECESSARY APPROVALS AND EASEMENTS FOR SUCH WORK.
- APPLICANT UNDERSTANDS RECERTIFICATION MAY BE REQUIRED. IF A POND CERTIFICATE, AN EXECUTED I&M PLAN, OR DRAINAGE EASEMENTS DO NOT EXIST, THE APPLICANT WILL BE REQUIRED TO PROVIDE THESE PRIOR TO CIVIL PLAN APPROVAL.
- ALL STORM INFRASTRUCTURE IS PRIVATE AND SIZED FOR THE 100-YEAR STORM EVENT.
- APPLICANT UNDERSTAND THAT WORK IN 100-YEAR FLOODPLAIN REQUIRES A FLOODPLAIN DEVELOPMENT PERMIT WHICH MUST BE OBTAINED PRIOR TO GRADING OR CONSTRUCTION WITHIN THE FLOODPLAIN.

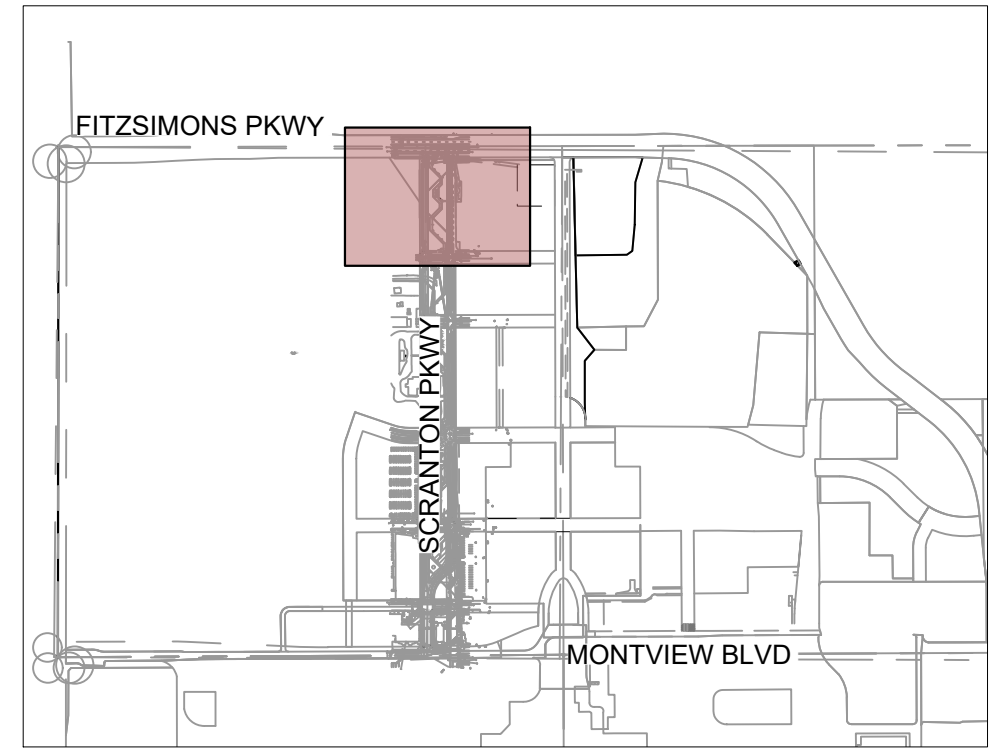

KEY MAP
SCALE: 1" = 1000'

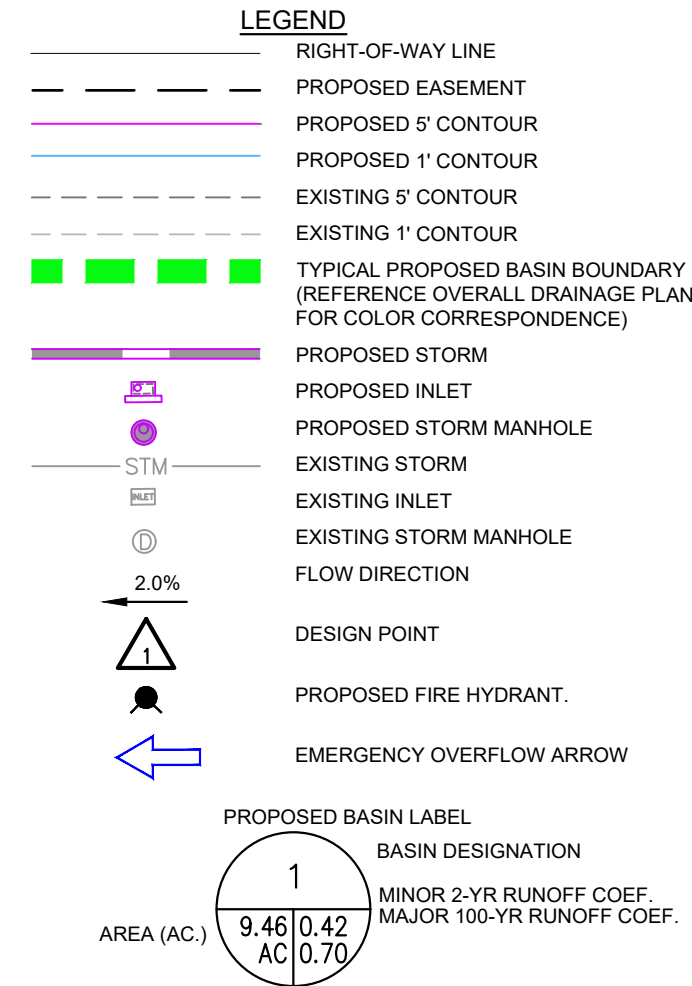

BENCHMARK

CITY OF AURORA BENCHMARK 356736NW003 BEING A 3" DIAM. BRASS CAP (STAMPED C.O.A BM, SCP-022.2) ON THE SW CORNER OF A 10' WIDE TYPE R STORM INLET (SOUTH SIDE OF FITZSIMMONS PKWY). APPROXIMATELY 0.40 MILES EAST OF THE FITZSIMMONS PKWY AND PEORIA STREET INTERSECTION AND BETWEEN LIGHT POLES 804 185 AND 644 185.

ELEVATION = 5329.46 (NAVD88)

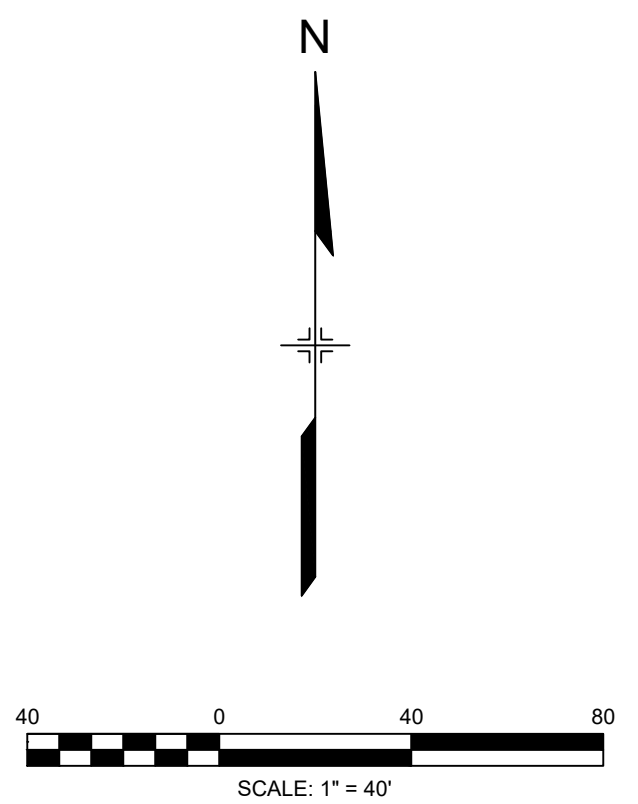

FITZSIMMONS INNOVATION CAMPUS SCRANTON PARKWAY SITE PLAN

TITLE: DRAINAGE PLAN 01

DATE: MARCH 2025

PREPARED BY:

Matrix
Excellence by Design
707 17th Street, Suite 3150
Denver, Colorado 80202
P 303.572.0200
www.matrixdesigngroup.com



NOT FOR CONSTRUCTION

SHEET:02

- NOTES:
1. CITY OF AURORA PLAN REVIEW IS ONLY FOR GENERAL CONFORMANCE WITH CITY OF AURORA DESIGN CRITERIA AND THE CITY CODE. THE CITY IS NOT RESPONSIBLE FOR THE ACCURACY AND ADEQUACY OF THE DESIGN, OF DIMENSIONS AND ELEVATIONS WHICH MUST BE CONFIRMED AND CORRELATED AT THE JOB SITE. THE CITY OF AURORA, THROUGH THE APPROVAL OF THIS DOCUMENT, ASSUMES NO RESPONSIBILITY FOR THE COMPLETENESS AND / OR ACCURACY OF THIS DOCUMENT.
 2. APPROVAL OF THIS DOCUMENT BY CITY OF AURORA DOES NOT IMPLY APPROVAL FOR ANY OFF-SITE WORK ON ADJACENT PRIVATE PROPERTY. IT IS THE OWNER'S RESPONSIBILITY TO COORDINATE WITH ADJACENT PROPERTY OWNERS AND OBTAIN ALL NECESSARY APPROVALS AND EASEMENTS FOR SUCH WORK.
 3. APPLICANT UNDERSTANDS RECERTIFICATION MAY BE REQUIRED. IF A POND CERTIFICATE, AN EXECUTED I&M PLAN, OR DRAINAGE EASEMENTS DO NOT EXIST, THE APPLICANT WILL BE REQUIRED TO PROVIDE THESE PRIOR TO CIVIL PLAN APPROVAL.
 4. ALL STORM INFRASTRUCTURE IS PRIVATE AND SIZED FOR THE 100-YEAR STORM EVENT.
 5. APPLICANT UNDERSTAND THAT WORK IN 100-YEAR FLOODPLAIN REQUIRES A FLOODPLAIN DEVELOPMENT PERMIT WHICH MUST BE OBTAINED PRIOR TO GRADING OR CONSTRUCTION WITHIN THE FLOODPLAIN.

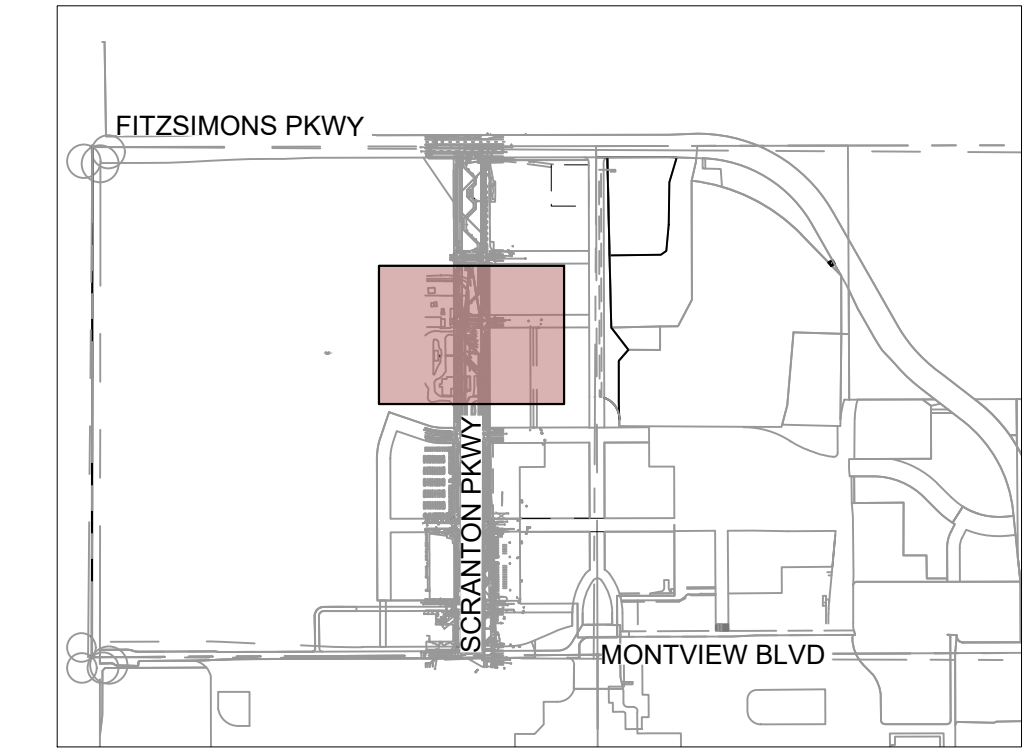

KEY MAP
SCALE: 1" = 1000'

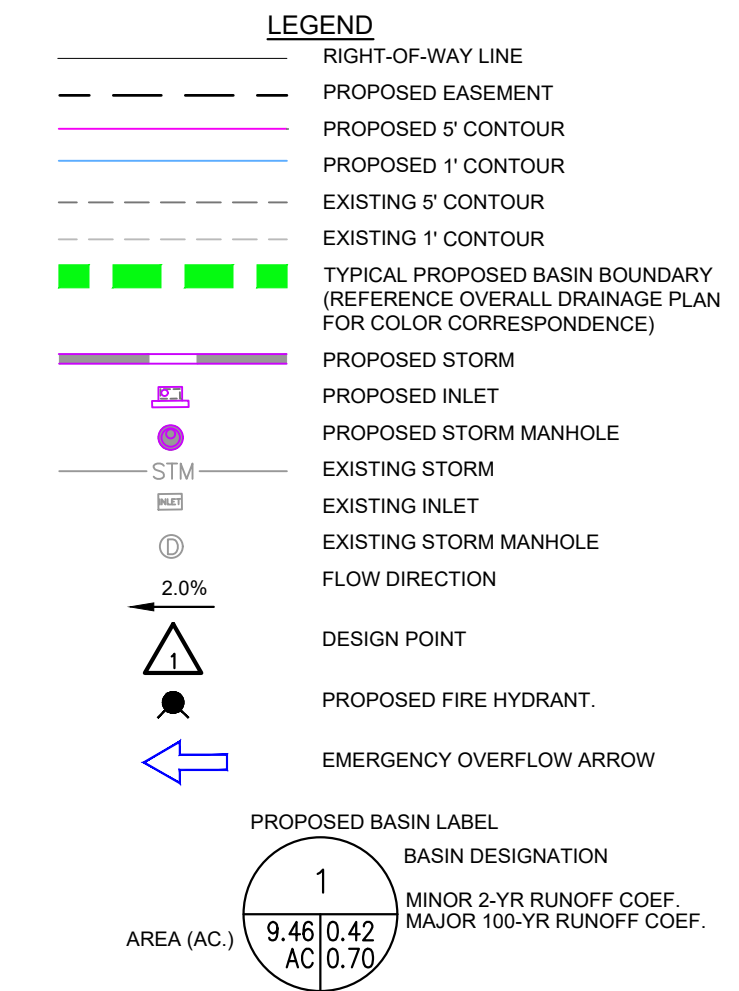

BENCHMARK

CITY OF AURORA BENCHMARK 356736NW003 BEING A 3" DIAM. BRASS CAP (STAMPED C.O.A BM, SCP-022.2) ON THE SW CORNER OF A 10' WIDE TYPE R STORM INLET (SOUTH SIDE OF FITZSIMONS PKWY). APPROXIMATELY 0.40 MILES EAST OF THE FITZSIMONS PKWY AND PEORIA STREET INTERSECTION AND BETWEEN LIGHT POLES 804 185 AND 644 185.
ELEVATION = 5329.46 (NAVD88)

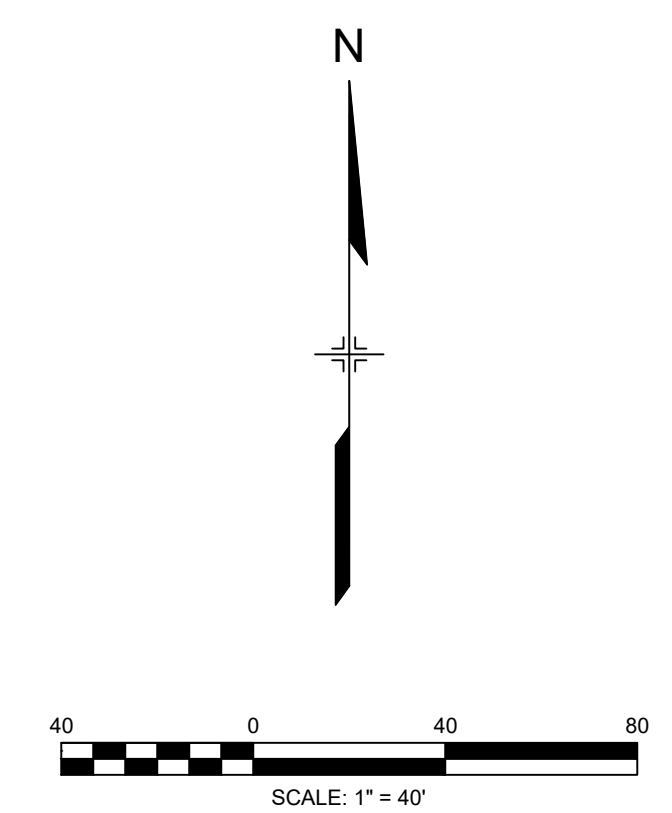

FITZSIMONS INNOVATION CAMPUS
SCRANTON PARKWAY SITE PLAN

TITLE: DRAINAGE PLAN 02

DATE: MARCH 2025

PREPARED BY:

Matrix
Excellence by Design
707 17th Street, Suite 3150
Denver, Colorado 80202
P 303.572.0200
www.matrixdesigngroup.com



SHEET:03

NOT FOR CONSTRUCTION

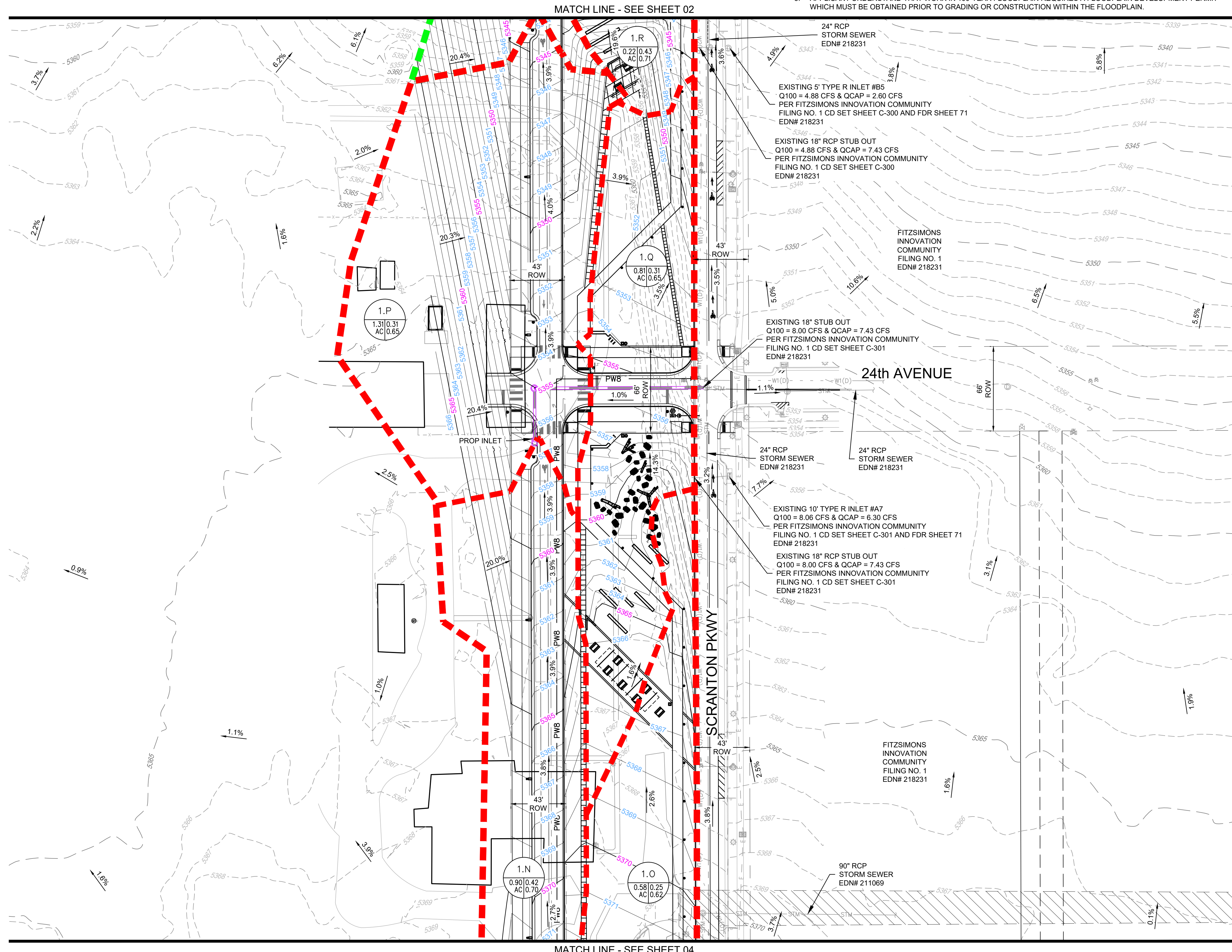

- NOTES:
1. CITY OF AURORA PLAN REVIEW IS ONLY FOR GENERAL CONFORMANCE WITH CITY OF AURORA DESIGN CRITERIA AND THE CITY CODE. THE CITY IS NOT RESPONSIBLE FOR THE ACCURACY AND ADEQUACY OF THE DESIGN, OF DIMENSIONS AND ELEVATIONS WHICH MUST BE CONFIRMED AND CORRELATED AT THE JOB SITE. THE CITY OF AURORA, THROUGH THE APPROVAL OF THIS DOCUMENT, ASSUMES NO RESPONSIBILITY FOR THE COMPLETENESS AND / OR ACCURACY OF THIS DOCUMENT.
 2. APPROVAL OF THIS DOCUMENT BY CITY OF AURORA DOES NOT IMPLY APPROVAL FOR ANY OFF-SITE WORK ON ADJACENT PRIVATE PROPERTY. IT IS THE OWNER'S RESPONSIBILITY TO COORDINATE WITH ADJACENT PROPERTY OWNERS AND OBTAIN ALL NECESSARY APPROVALS AND EASEMENTS FOR SUCH WORK.
 3. APPLICANT UNDERSTANDS RECERTIFICATION MAY BE REQUIRED. IF A POND CERTIFICATE, AN EXECUTED I&M PLAN, OR DRAINAGE EASEMENTS DO NOT EXIST, THE APPLICANT WILL BE REQUIRED TO PROVIDE THESE PRIOR TO CIVIL PLAN APPROVAL.
 4. ALL STORM INFRASTRUCTURE IS PRIVATE AND SIZED FOR THE 100-YEAR STORM EVENT.
 5. APPLICANT UNDERSTAND THAT WORK IN 100-YEAR FLOODPLAIN REQUIRES A FLOODPLAIN DEVELOPMENT PERMIT WHICH MUST BE OBTAINED PRIOR TO GRADING OR CONSTRUCTION WITHIN THE FLOODPLAIN.

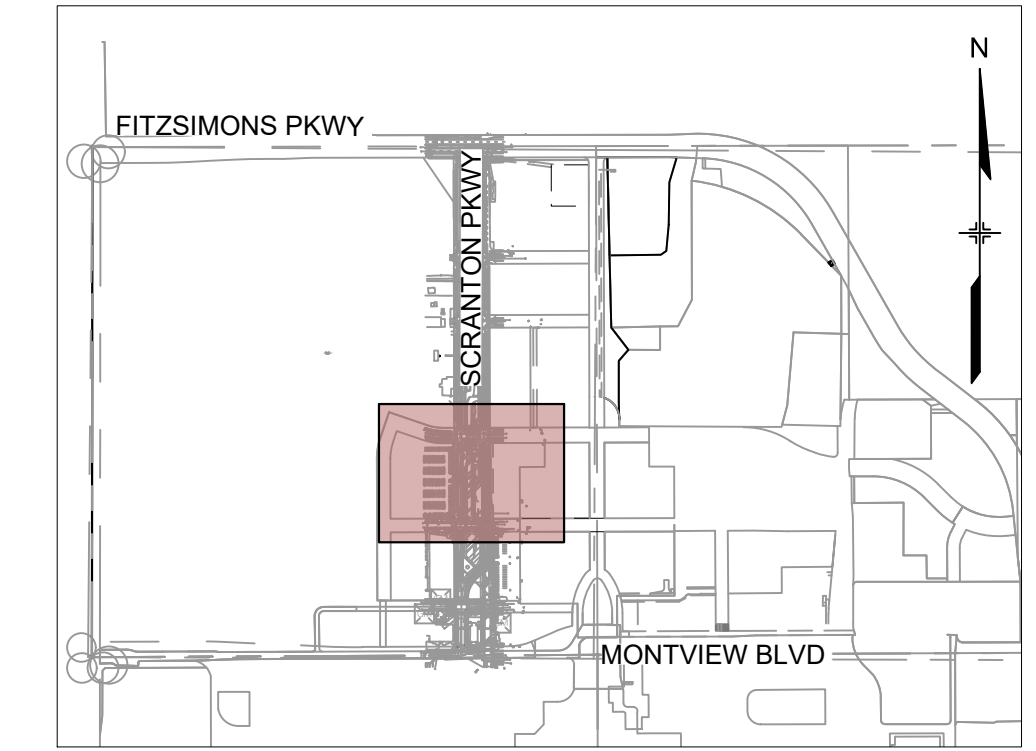

KEY MAP
SCALE: 1" = 1000'

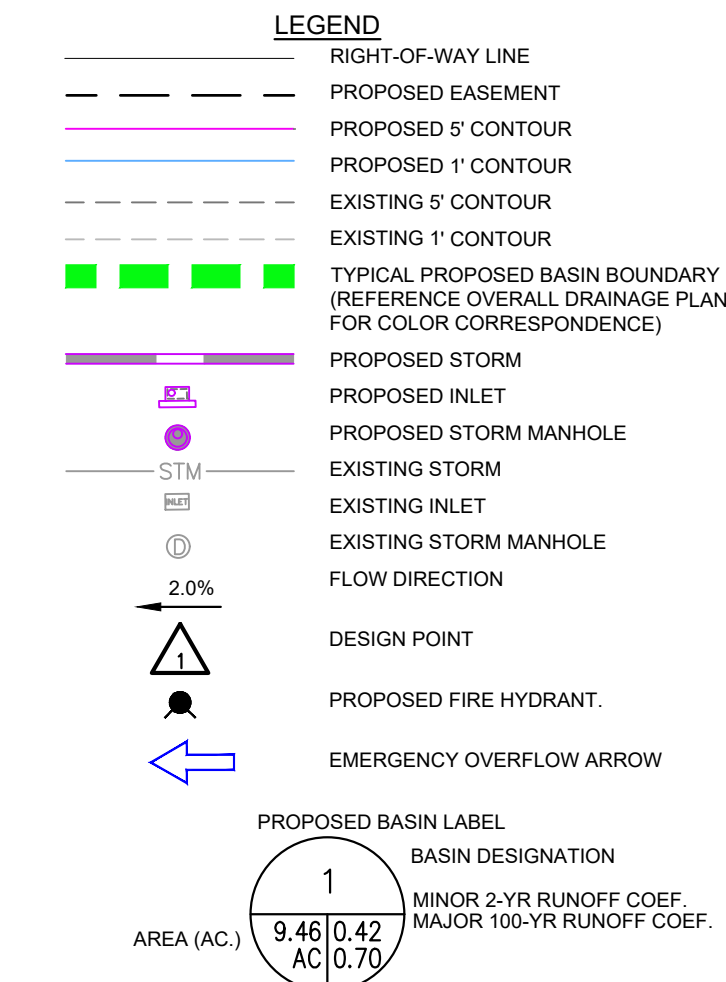

BENCHMARK

CITY OF AURORA BENCHMARK 356736NW003 BEING A 3" DIAM. BRASS CAP (STAMPED C.O.A BM, SCP-022.2) ON THE SW CORNER OF A 10' WIDE TYPE R STORM INLET (SOUTH SIDE OF FITZSIMONS PKWY). APPROXIMATELY 0.40 MILES EAST OF THE FITZSIMONS PKWY AND PEORIA STREET INTERSECTION AND BETWEEN LIGHT POLES 804 185 AND 644 185.

ELEVATION = 5329.46 (NAVD88)

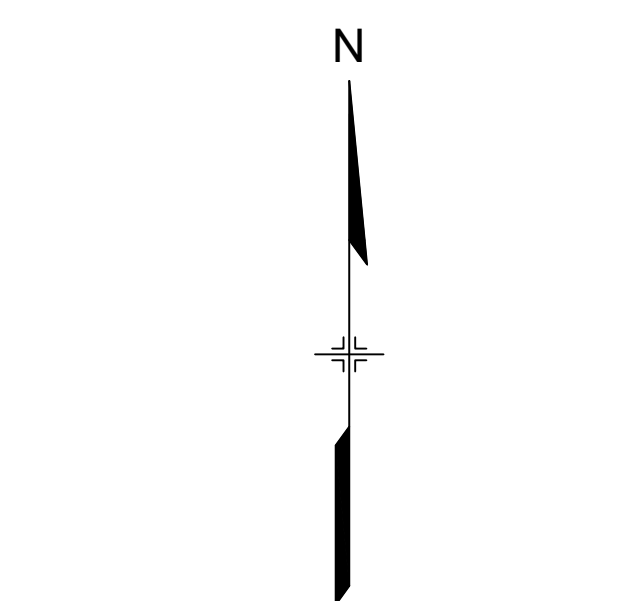

FITZSIMONS INNOVATION CAMPUS
SCRANTON PARKWAY SITE PLAN

TITLE: DRAINAGE PLAN 03

DATE: MARCH 2025

PREPARED BY:

Matrix
Excellence by Design
707 17th Street, Suite 3150
Denver, Colorado 80202
P 303.572.0200
www.matrixdesigngroup.com



SHEET:04

NOT FOR CONSTRUCTION

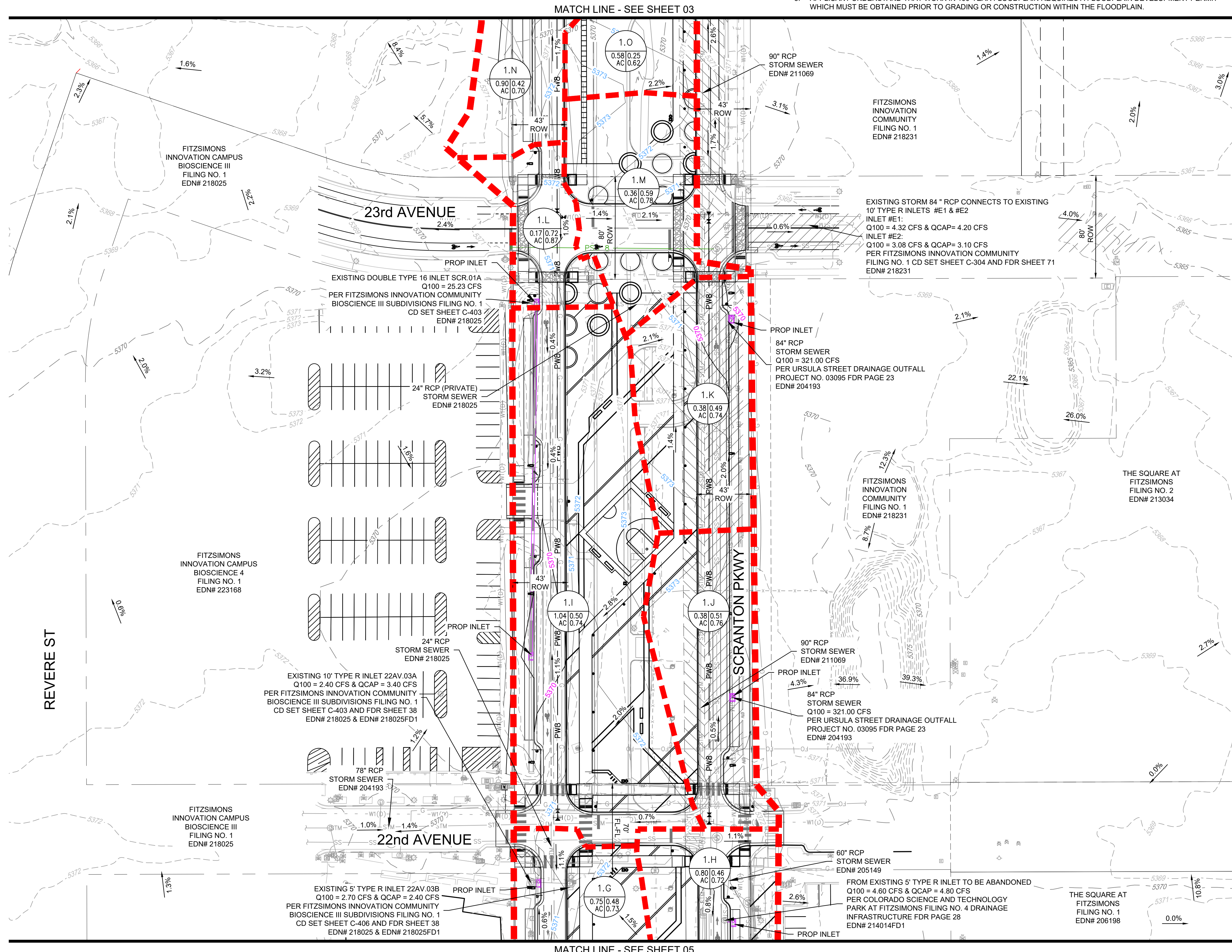

- NOTES:
1. CITY OF AURORA PLAN REVIEW IS ONLY FOR GENERAL CONFORMANCE WITH CITY OF AURORA DESIGN CRITERIA AND THE CITY CODE. THE CITY IS NOT RESPONSIBLE FOR THE ACCURACY AND ADEQUACY OF THE DESIGN, OF DIMENSIONS AND ELEVATIONS WHICH MUST BE CONFIRMED AND CORRELATED AT THE JOB SITE. THE CITY OF AURORA, THROUGH THE APPROVAL OF THIS DOCUMENT, ASSUMES NO RESPONSIBILITY FOR THE COMPLETENESS AND / OR ACCURACY OF THIS DOCUMENT.
 2. APPROVAL OF THIS DOCUMENT BY CITY OF AURORA DOES NOT IMPLY APPROVAL FOR ANY OFF-SITE WORK ON ADJACENT PRIVATE PROPERTY. IT IS THE OWNER'S RESPONSIBILITY TO COORDINATE WITH ADJACENT PROPERTY OWNERS AND OBTAIN ALL NECESSARY APPROVALS AND EASEMENTS FOR SUCH WORK.
 3. APPLICANT UNDERSTANDS RECERTIFICATION MAY BE REQUIRED. IF A POND CERTIFICATE, AN EXECUTED I&M PLAN, OR DRAINAGE EASEMENTS DO NOT EXIST, THE APPLICANT WILL BE REQUIRED TO PROVIDE THESE PRIOR TO CIVIL PLAN APPROVAL.
 4. ALL STORM INFRASTRUCTURE IS PRIVATE AND SIZED FOR THE 100-YEAR STORM EVENT.
 5. APPLICANT UNDERSTAND THAT WORK IN 100-YEAR FLOODPLAIN REQUIRES A FLOODPLAIN DEVELOPMENT PERMIT WHICH MUST BE OBTAINED PRIOR TO GRADING OR CONSTRUCTION WITHIN THE FLOODPLAIN.

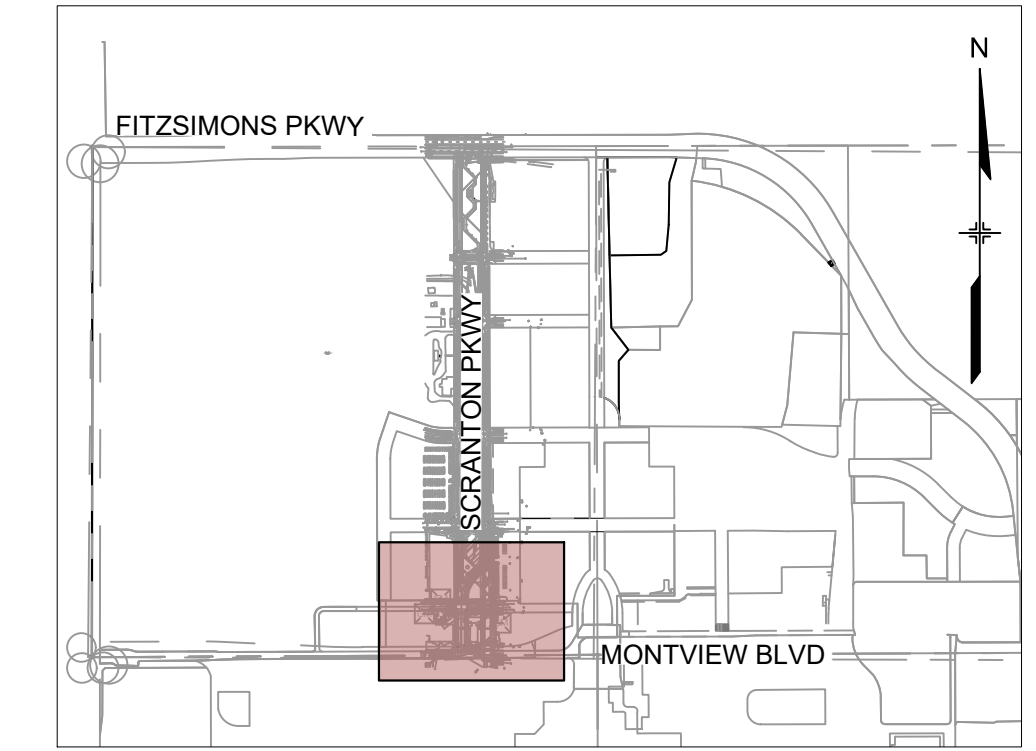

KEY MAP
SCALE: 1" = 1000'

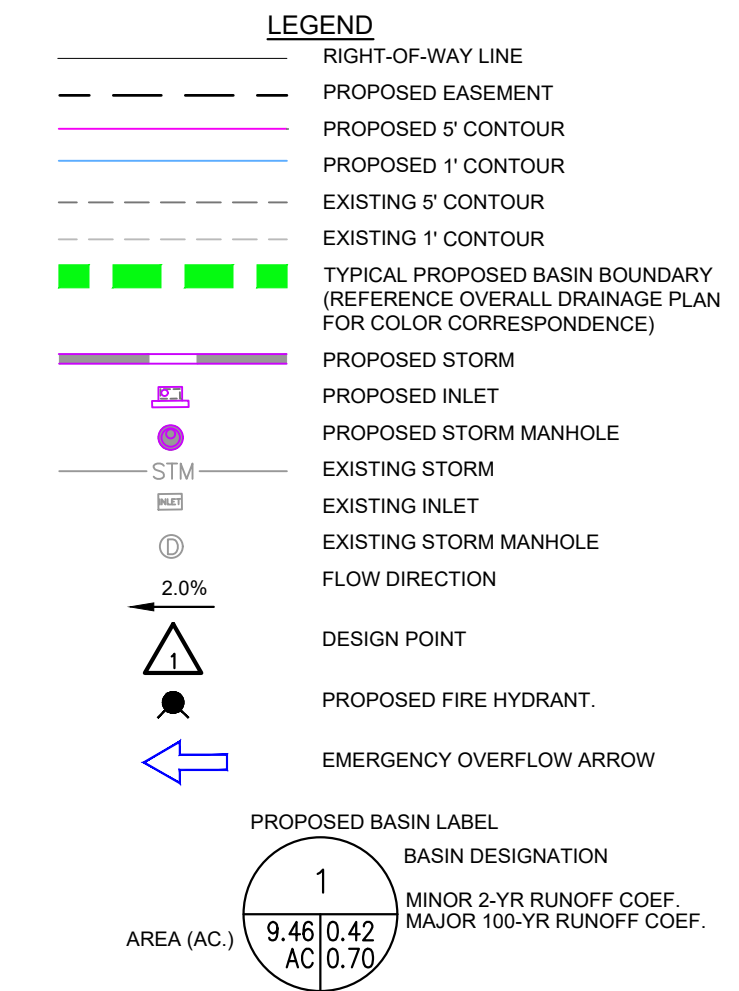

BENCHMARK

CITY OF AURORA BENCHMARK 356736NW003 BEING A 3" DIAM. BRASS CAP (STAMPED C.O.A BM, SCP-022.2) ON THE SW CORNER OF A 10' WIDE TYPE R STORM INLET (SOUTH SIDE OF FITZSIMONS PKWY). APPROXIMATELY 0.40 MILES EAST OF THE FITZSIMONS PKWY AND PEORIA STREET INTERSECTION AND BETWEEN LIGHT POLES 804 185 AND 644 185.

ELEVATION = 5329.46 (NAVD88)

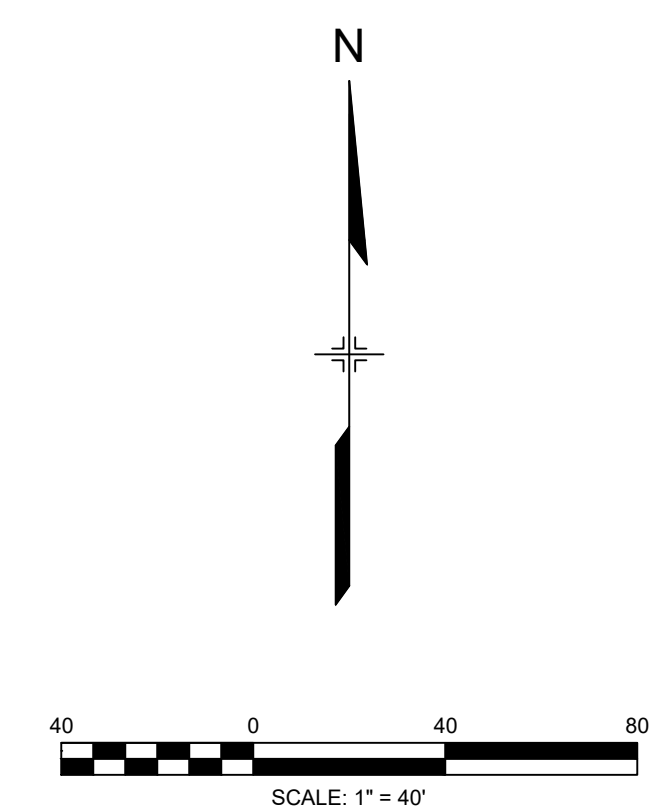

FITZSIMONS INNOVATION CAMPUS
SCRANTON PARKWAY SITE PLAN

TITLE: DRAINAGE PLAN 04

DATE: MARCH 2025

PREPARED BY:

Matrix
Excellence by Design
707 17th Street, Suite 3150
Denver, Colorado 80202
P 303.572.0200
www.matrixdesigngroup.com



SHEET:05

NOT FOR CONSTRUCTION

