

CRESTONE PEAK RESOURCES OPERATING LLC

ASPEN 3-65 15-14 SOUTH

W 1/2 SW 1/4 SEC. 15, T3S, R65W, 6TH P.M.
CITY OF AURORA, ADAMS COUNTY, COLORADO

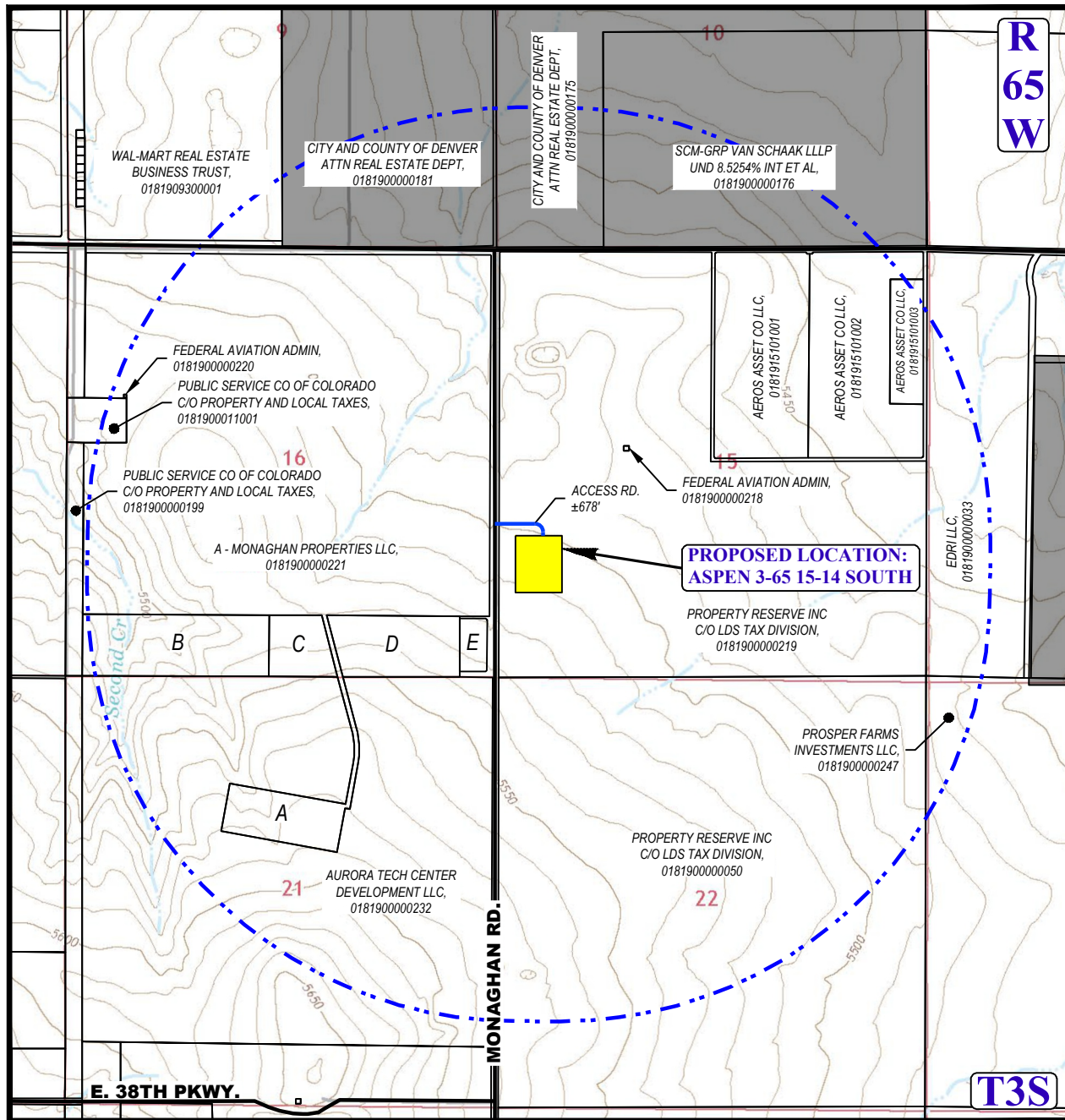

A = MONAGHAN PROPERTIES LLC, 0181900000221
B = AURORA TECH CENTER DEVELOPMENT LLC, 0181900000229
C = AURORA TECH CENTER DEVELOPMENT LLC, 0181900000230
D = AURORA TECH CENTER DEVELOPMENT LLC, 0181900000231
E = LUMEN QWEST CORPORATION C/O PROP TAX, 0181900012001

LEGEND:

- 1-Mile Radius
- City of Aurora
- Adams County

0' 1,000' 2,000'
1" = 2,000'
SCALE



UELS, LLC
Corporate Office * 85 South 200 East
Vernal, UT 84078 * (435) 789-1017



DRAWN BY: C.D.C.

DATE DRAWN: 08-26-2024

SCALE: 1"=2,000'

SURROUNDING PROPERTY OWNER EXHIBIT, Pg. 1 of 1

CRESTONE PEAK RESOURCES OPERATING LLC
ASPEN 3-65 15-14 SOUTH
1-MILE ABUTTERS LIST

COUNTY	PARCEL NUMBER	PARCEL ADDRESS	PARCEL CITY, STATE, ZIP	OWNER	OWNER ADDRESS	OWNER CITY, STATE, ZIP	SUBDIVISION
ADAMS	0181900000033		AURORA CO	EDRI LLC	367 SANTANA HTS UNIT 4031	SAN JOSE CA 95128-2025	
ADAMS	0181900000050		AURORA CO	PROPERTY RESERVE INC C/O LDS TAX DIVISION	PO BOX 511196	SALT LAKE CITY UT 84151-1196	
ADAMS	0181900000175			CITY AND COUNTY OF DENVER ATTN REAL ESTATE DEPT	8500 PENA BLVD	DENVER CO 80249-6340	
ADAMS	0181900000176			SCM-GRP VAN SCHAAK LLLP UND 8.5254% INT ET AL	1242 E JACKSON ST	PHOENIX AZ 85034-2342	
ADAMS	0181900000181			CITY AND COUNTY OF DENVER ATTN REAL ESTATE DEPT	8500 PENA BLVD	DENVER CO 80249-6340	
ADAMS	0181900000199		AURORA CO	PUBLIC SERVICE CO OF COLORADO C/O PROPERTY AND LOCAL TAXES	PO BOX 1979	DENVER CO 80201-1979	
ADAMS	0181900000218		AURORA CO	FEDERAL AVIATION ADMINISTRATION	1601 W LIND AVE S W NO. 570	RENTON WA 98055-4056	
ADAMS	0181900000219		AURORA CO	PROPERTY RESERVE INC C/O LDS TAX DIVISION	PO BOX 511196	SALT LAKE CITY UT 84151-1196	
ADAMS	0181900000220		AURORA CO	FEDERAL AVIATION ADMINISTRATION	1601 W LIND AVE S W NO. 570	RENTON WA 98055-4056	
ADAMS	0181900000221		AURORA CO	MONAGHAN PROPERTIES LLC	1892 BIG BEAR DR	SEDALIA CO 80135-4411	
ADAMS	0181900000229		AURORA CO	AURORA TECH CENTER DEVELOPMENT LLC	250 PILOT RD STE 150	LAS VEGAS NV 89119-3543	
ADAMS	0181900000230		AURORA CO	AURORA TECH CENTER DEVELOPMENT LLC	250 PILOT RD STE 150	LAS VEGAS NV 89119-3543	
ADAMS	0181900000231		AURORA CO	AURORA TECH CENTER DEVELOPMENT LLC	250 PILOT RD STE 150	LAS VEGAS NV 89119-3543	
ADAMS	0181900000232		AURORA CO	AURORA TECH CENTER DEVELOPMENT LLC	250 PILOT RD STE 150	LAS VEGAS NV 89119-3543	
ADAMS	0181900000247		AURORA CO	PROSPER FARMS INVESTMENTS LLC	5641 BROADWAY	DENVER CO 80216-1021	
ADAMS	0181900011001		AURORA CO	PUBLIC SERVICE CO OF COLORADO C/O PROPERTY AND LOCAL TAXES	PO BOX 1979	DENVER CO 80201-1979	SKY RANCH ELECTRICAL SUBSTATION FIL NO 1
ADAMS	0181900012001	28000 E 49TH AVE	AURORA CO	LUMEN QWEST CORPORATION C/O PROP TAX -	931 14TH ST	DENVER CO 80202-2994	U.S. WEST-MONAGHAN SUBD FILING NO 1
ADAMS	0181909300001		AURORA CO	WAL-MART REAL ESTATE BUSINESS TRUST	702 SW 8TH ST DEPT 8687 MS #0555	BENTONVILLE AR 72716	
ADAMS	0181915101001		AURORA CO	AEROS ASSET CO LLC	26100 E 68TH AVE STE 240	DENVER CO 80249-6316	AEROS LOGISTICS CENTER
ADAMS	0181915101002	29650 E 56TH AVE	AURORA CO	AEROS ASSET CO LLC	26100 E 68TH AVE STE 240	DENVER CO 80249-6316	AEROS LOGISTICS CENTER
ADAMS	0181915101003		AURORA CO	AEROS ASSET CO LLC	26100 E 68TH AVE STE 240	DENVER CO 80249-6316	AEROS LOGISTICS CENTER