

FOUNDRY REC CENTER
FIRE TRUCK MOVEMENT EXHIBIT 2

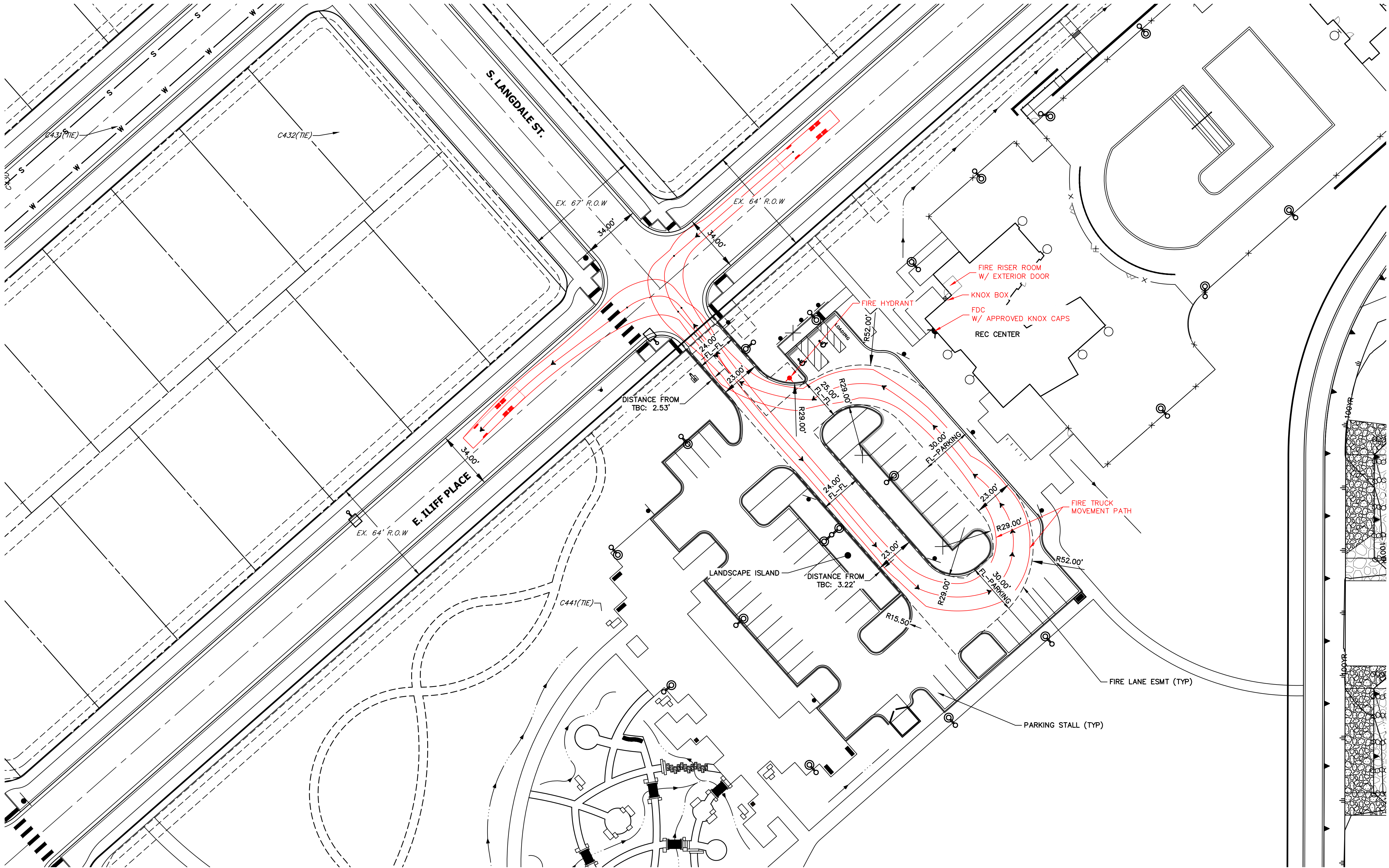

LEGEND:
FIRE TRUCK TIRE PATH

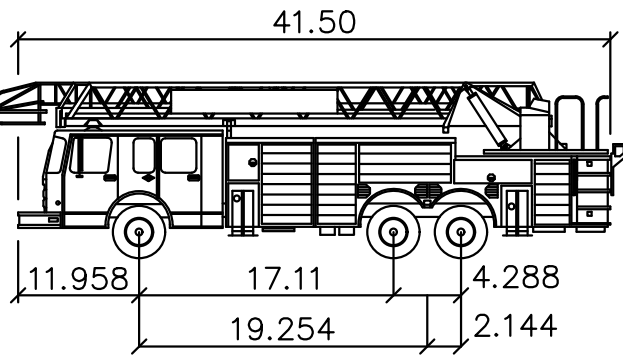

OVERALL LENGTH : 41.500ft
OVERALL WIDTH : 8.330ft
OVERALL BODY HEIGHT : 10.475ft
MIN BODY GROUND CLEARANCE : 0.906ft
TRACK WIDTH : 8.250ft
LOCK TO LOCK TIME : 6.00s
MAX STEERING ANGLE (VIRTUAL) : 31.90deg

AURORA FIRE TRUCK DETAIL

NOTES

1. IN ACCORDANCE WITH CITY OF AURORA "ROADWAY DESIGN AND CONSTRUCTION SPECIFICATIONS", SECTION 4.04.6.04.01; THE EQUIVALENT TURNING TEMPLATE FOR A CITY OF AURORA FIRE TRUCK IS THE BUS-45. THIS EXHIBIT USES THE ABOVE AURORA FIRE TRUCK DETAIL. OVERALL LENGTH 41.5', OVERALL WIDTH 8.33', TRACK WIDTH 8.25', MAX STEERING ANGLE 31.90 DEG.
2. IN ACCORDANCE WITH CITY OF AURORA "ROADWAY DESIGN AND CONSTRUCTION SPECIFICATIONS", SECTION 4.07.1.01;
 - A. WHERE THE FIRE LANE WIDTH IS 26' WIDE THE INSIDE RADIUS SHALL BE 26' AND AN OUTSIDE RADIUS OF 52'.
 - B. WHERE THE FIRE LANE WIDTH IS 23' WIDE THE INSIDE RADIUS SHALL BE 29' AND AN OUTSIDE RADIUS OF 52'.
 - C. WHERE A 23' AND 26' FIRE LANE EASEMENT INTERCONNECTS THE INSIDE TURNING RADII MUST BE 29'

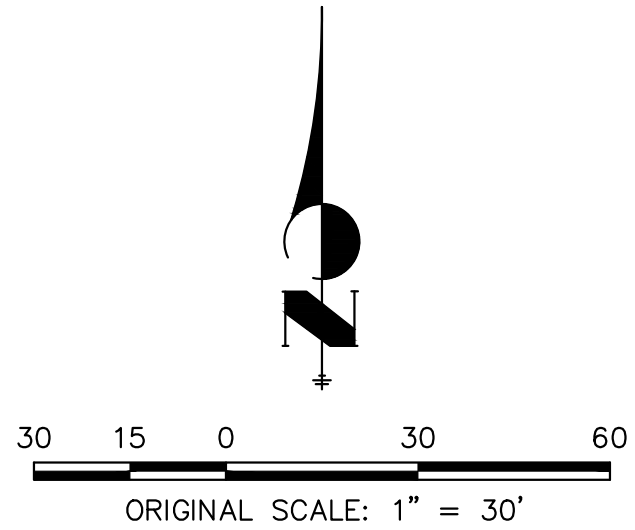

FIRE TRUCK MOVEMENT EXHIBIT 2
FOUNDRY REC CENTER
JOB NO. 16146.05
5/2/24
SHEET 2 OF 2



Centennial 303-740-9393 • Colorado Springs 719-593-2593
Fort Collins 970-491-9888 • www.jrengineering.com