

## DRAINAGE MAP LEGEND

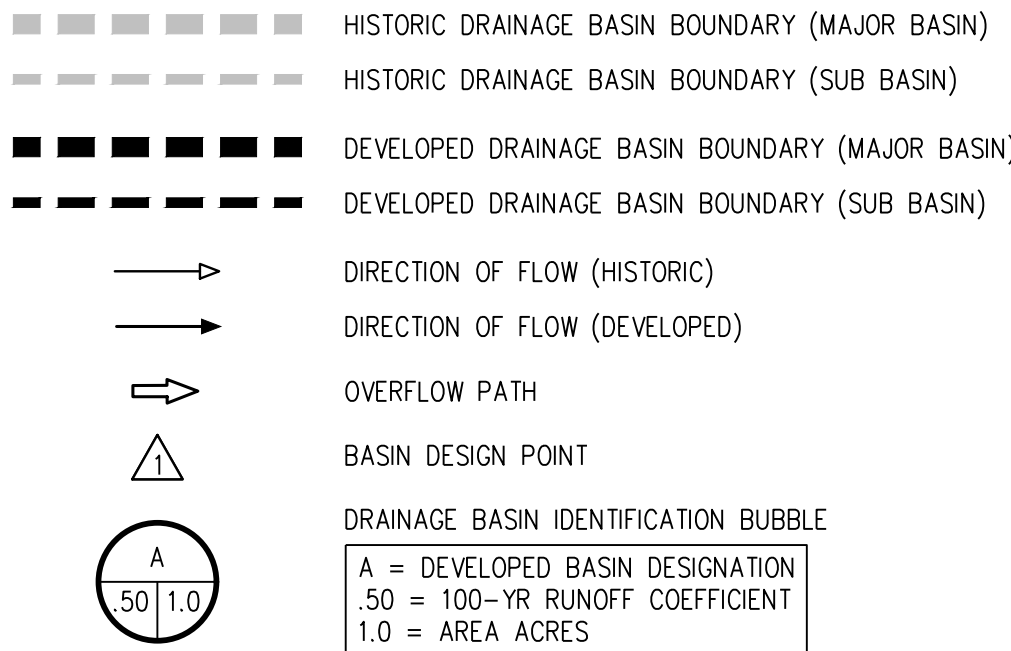

## NOTES:

- ALL DRAINAGE FACILITIES ON SITE, INCLUDING ROOF DRAINS ARE PRIVATE AND SIZED FOR THE 100-YEAR STORM EVENT.
- CITY OF AURORA PLAN REVIEW IS ONLY FOR GENERAL CONFORMANCE WITH CITY OF AURORA DESIGN CRITERIA AND THE CITY CODE. THE CITY IS NOT RESPONSIBLE FOR THE ACCURACY AND ADEQUACY OF THE DESIGN, OF DIMENSIONS AND ELEVATIONS WHICH MUST BE CONFIRMED AND CORRELATED AT THE JOB SITE. THE CITY OF AURORA, THROUGH THE APPROVAL OF THIS DOCUMENT, ASSUMES NO RESPONSIBILITY FOR THE COMPLETENESS AND/OR ACCURACY OF THIS DOCUMENT.
- APPROVAL OF THIS DOCUMENT BY CITY OF AURORA DOES NOT IMPLY APPROVAL FOR ANY OFF-SITE WORK ON ADJACENT PRIVATE PROPERTY. IT IS THE OWNER'S RESPONSIBILITY TO COORDINATE WITH ADJACENT PROPERTY OWNERS AND OBTAIN ALL NECESSARY APPROVALS AND EASEMENTS FOR SUCH WORK.
- ALL SWALES AND DITCHES ARE PRIVATELY MAINTAINED.

## BENCHMARK:

COA ID: 456609SW002  
ELEVATION: 5504.48 (NAVD 88)  
DESCRIPTION: CHISELED SW COR CONC PED. OF STREET LIGHT #38-91 ON THE E SIDE OF AIRPORT BLVD. @ 100' +/- S OF E. CENTRETECH PKWY BEING ON THE W. SIDE OF AIRPORT BLVD REV. EXT NOT., REV. DESC. FROM ELLSWORTH TO CENTRETECH PKY.

DEVELOPED RUNOFF SUMMARY TABLE

BASIN	DESIGN POINT	AREA (ACRES)	2-YR RUNOFF COEFF.	100-YR RUNOFF COEFF.	2-YR RUNOFF (CFS)	100-YR RUNOFF (CFS)	% Imperviousness
R	1	1.27	0.79	0.87	2.92	9.12	95%
P1	2	0.23	0.39	0.69	0.26	1.30	51%
P2	3	0.36	0.64	0.81	0.90	2.38	79%
P3	4	0.32	0.79	0.87	0.74	2.31	95%
P4	5	0.06	0.62	0.80	1.65	0.40	76%
P5	6	0.30	0.42	0.71	1.77	1.45	54%
P6	7	0.20	0.64	0.81	0.38	1.35	79%
P7	8	0.54	0.29	0.64	0.36	2.28	39%
P8	9	0.22	0.58	0.78	0.37	1.41	72%
P9	10	0.25	0.65	0.81	0.44	1.55	80%
P10	11	0.10	0.48	0.73	0.12	0.51	61%
A1	12	0.13	0.70	0.83	0.26	0.86	86%
A2	13	0.03	0.79	0.87	0.07	0.23	95%
A3	14	0.09	0.29	0.64	0.07	0.44	39%
A4	15	0.21	0.37	0.68	0.21	1.11	48%
A5	16	0.16	0.66	0.82	0.30	1.05	81%
A6	17	0.22	0.14	0.57	0.08	0.92	20%
Z1	18	0.31	0.77	0.87	0.71	2.23	94%
Z2	19	0.34	0.79	0.87	0.77	2.41	95%
Z3	20	0.57	0.79	0.87	1.31	4.08	95%
Z4	21	0.26	0.79	0.87	0.59	1.85	95%
Z5	22	0.40	0.67	0.82	0.78	2.69	82%

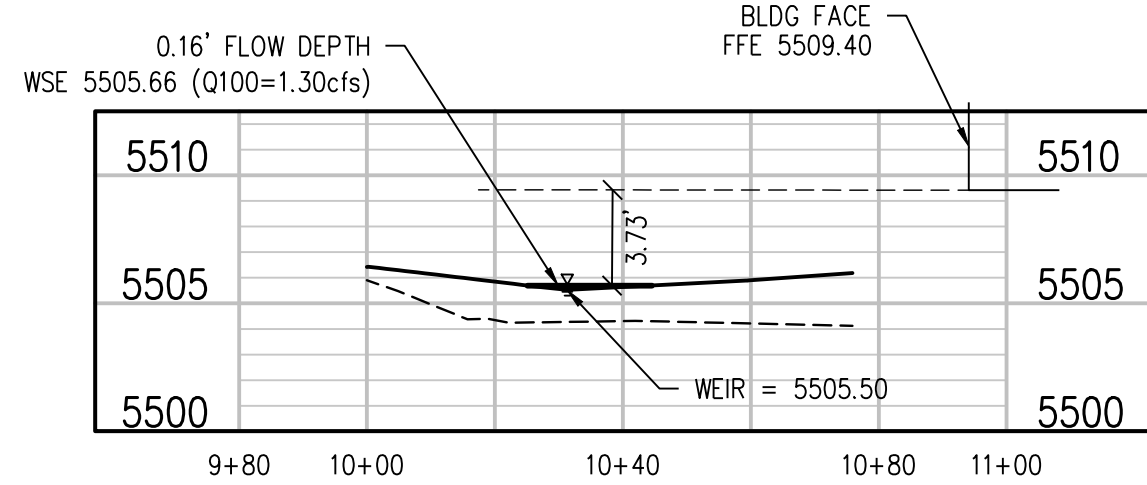

P1 Weir (A-A) Cross Section

SCALE: 1"=30' HORIZ  
1"=8' VERT

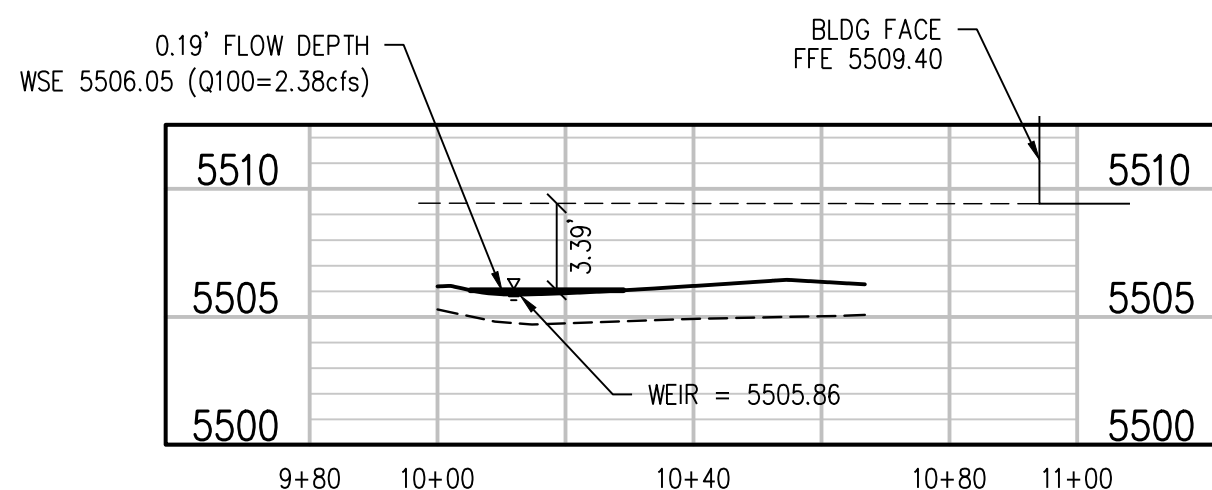

P2 Weir (B-B) Cross Section

SCALE: 1"=30' HORIZ  
1"=8' VERT

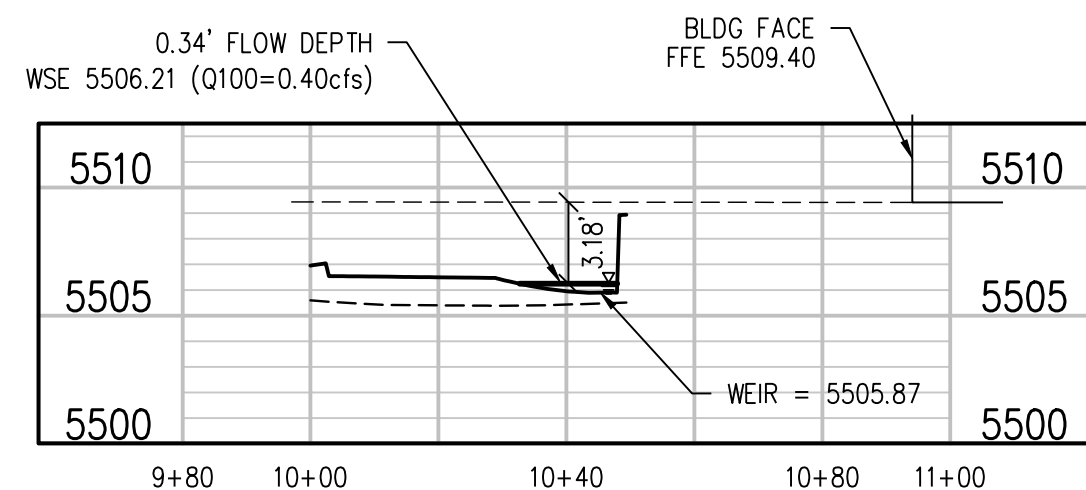

P4 Weir (D-D) Cross Section

SCALE: 1"=30' HORIZ  
1"=8' VERT

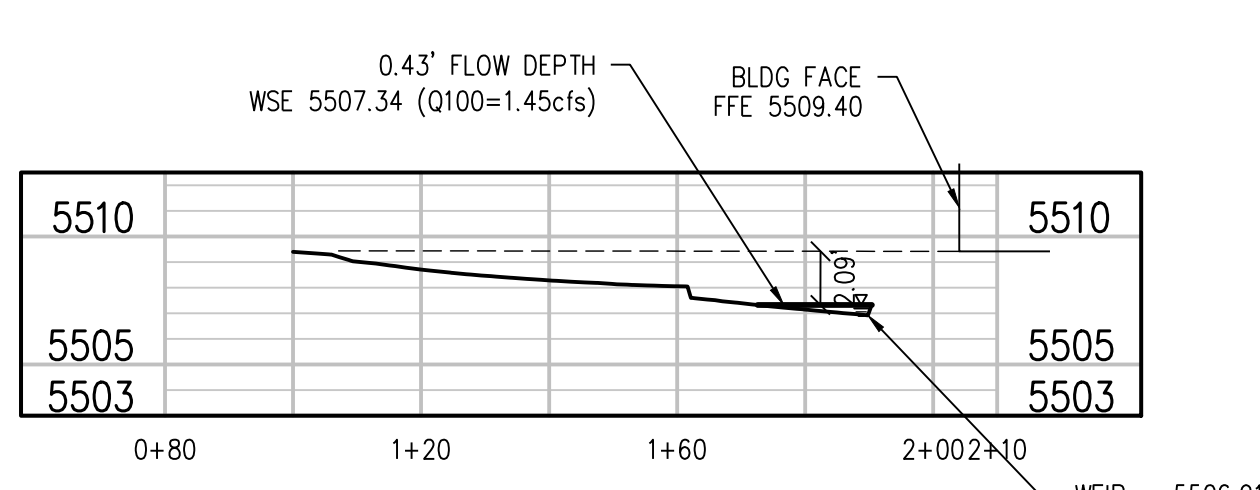

P5 Weir (E-E) Cross Section

SCALE: 1"=30' HORIZ  
1"=8' VERT

DETENTION SUMMARY TABLE

	VOLUME (AC-FT)	VOLUME (CF)	DEPTH (FT)	WATER SURFACE ELEV	RELEASE RATE (CFS)
WQV	0.111	4835	2.71	5501.62	0.1
EURV	0.326	14200	5.05	5503.96	2.4
100-YR	0.423	18425	5.82	5504.73	6.2

Approved For One Year From This Date

Aurora Water - Drainage Division

Date

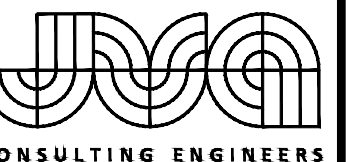

JVA, Inc. 1319 Spruce Street  
Boulder, CO 80302 303.444.1951  
www.jvajva.com  
Boulder • Fort Collins • Winter Park  
Glenwood Springs • Denver

REVISION DESCRIPTION

NO. DATE DESD DWN

PRELIMINARY  
NOT FOR  
CONSTRUCTION

DESIGNED BY: AMP/TWW  
DRAWN BY: CMS  
CHECKED BY: HMM  
JOB #: 3533c  
DATE: AUG, 2024  
© JVA, INC.

PICKENS TECHNOLOGY CENTER FILING  
#05 - LOT 2, BLOCK 1

PRELIMINARY DEVELOPED DRAINAGE MAP

SHEET NO.

FIG 1



C:\Users\cma\appdata\local\temp\AsaPublish\_1700413535--DDP--Detailed.dwg, 10/18/2024 -- 2:18 PM, CWS

DEVELOPED RUNOFF SUMMARY TABLE							
BASIN	DESIGN POINT	AREA (ACRES)	2-YR RUNOFF COEFF.	100-YR RUNOFF COEFF.	2-YR RUNOFF (CFS)	100-YR RUNOFF (CFS)	% Imperviousness
R	1	1.27	0.79	0.87	2.92	9.12	95%
P1	2	0.23	0.39	0.69	0.26	1.30	51%
P2	3	0.36	0.64	0.81	0.90	2.38	79%
P3	4	0.32	0.79	0.87	0.74	2.31	95%
P4	5	0.06	0.62	0.80	1.65	0.40	76%
P5	6	0.30	0.42	0.71	1.77	1.45	54%
P6	7	0.20	0.64	0.81	0.38	1.35	79%
P7	8	0.54	0.29	0.64	0.36	2.28	39%
P8	9	0.22	0.58	0.78	0.37	1.41	72%
P9	10	0.25	0.65	0.81	0.44	1.55	80%
P10	11	0.10	0.48	0.73	0.12	0.51	61%
A1	12	0.13	0.70	0.83	0.26	0.86	86%
A2	13	0.03	0.79	0.87	0.07	0.23	95%
A3	14	0.09	0.29	0.64	0.07	0.44	39%
A4	15	0.21	0.37	0.68	0.21	1.11	48%
A5	16	0.16	0.66	0.82	0.30	1.05	81%
A6	17	0.22	0.14	0.57	0.08	0.92	20%
Z1	18	0.31	0.77	0.87	0.71	2.23	94%
Z2	19	0.34	0.79	0.87	0.77	2.41	95%
Z3	20	0.57	0.79	0.87	1.31	4.08	95%
Z4	21	0.26	0.79	0.87	0.59	1.85	95%
Z5	22	0.40	0.67	0.82	0.78	2.69	82%

DETENTION SUMMARY TABLE					
	VOLUME (AC-FT)	VOLUME (CF)	DEPTH (FT)	WATER SURFACE ELEV	RELEASE RATE (CFS)
WQCV	0.111	4835	2.71	5501.62	0.1
EURV	0.326	14200	5.05	5503.96	2.4
100-YR	0.423	18425	5.82	5504.73	6.2

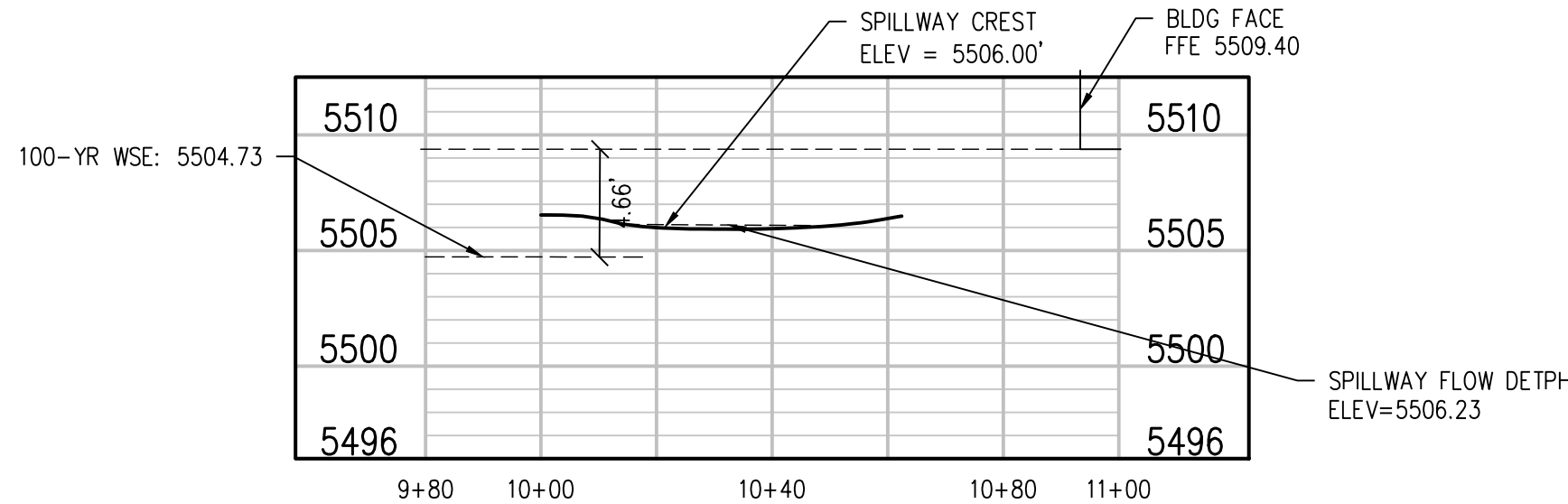

Spillway Cross Section (K-K) Cross Section

SCALE: 1"=30' HORIZ  
1"=8' VERT

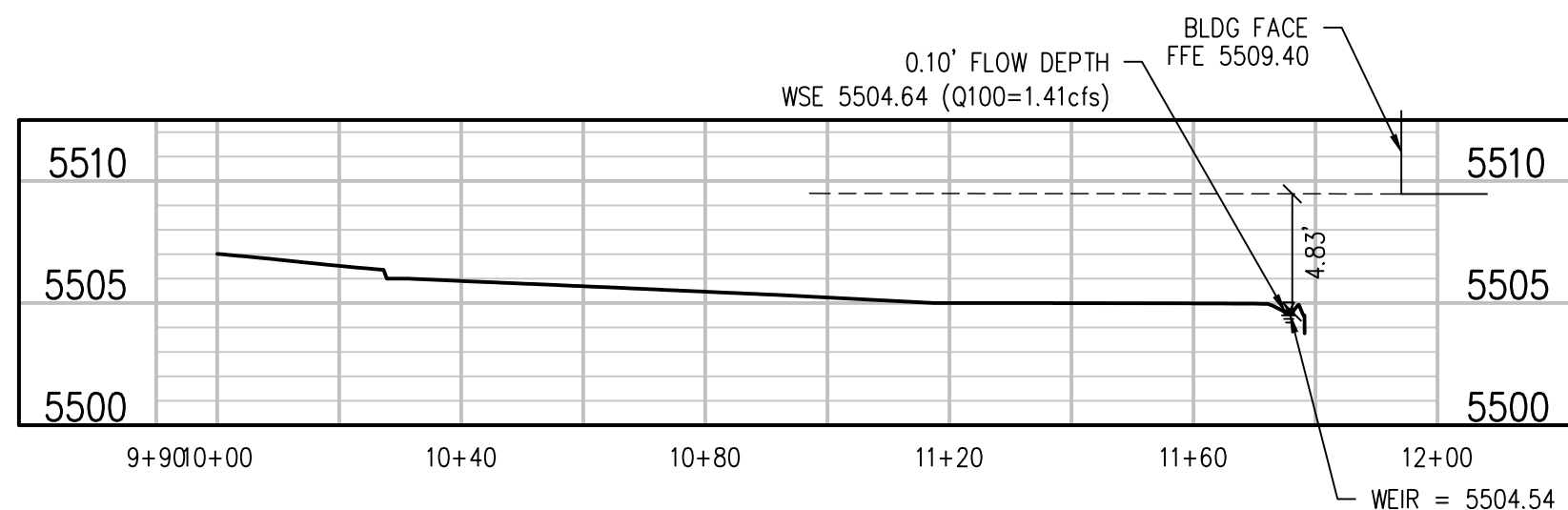
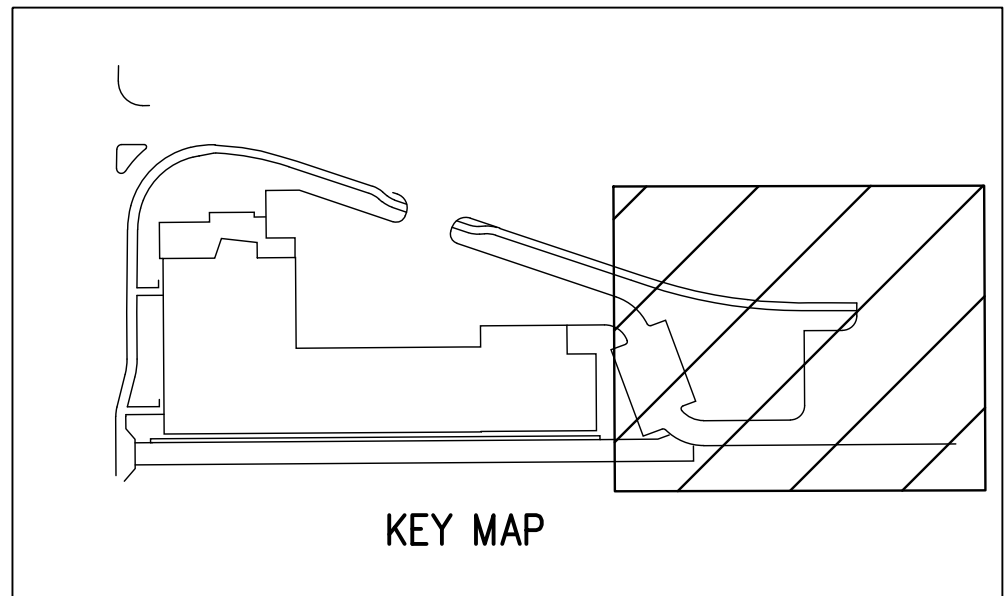

P8 Weir (G-G) Cross Section

SCALE: 1"=30' HORIZ  
1"=8' VERT

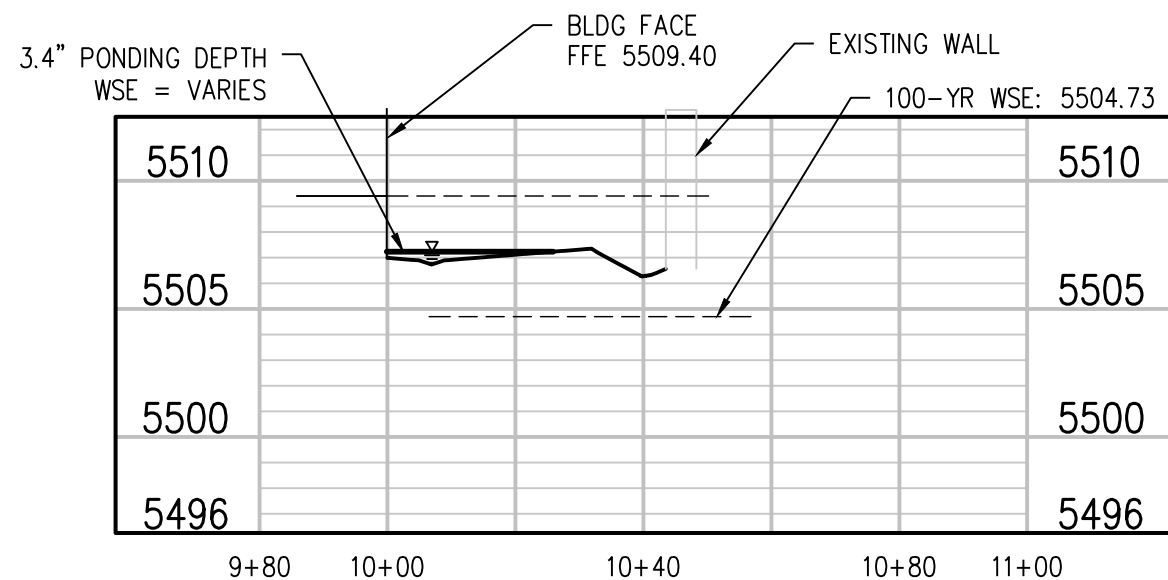

Concrete Pan Cross Section (H-H) Cross Section

SCALE: 1"=30' HORIZ  
1"=8' VERT

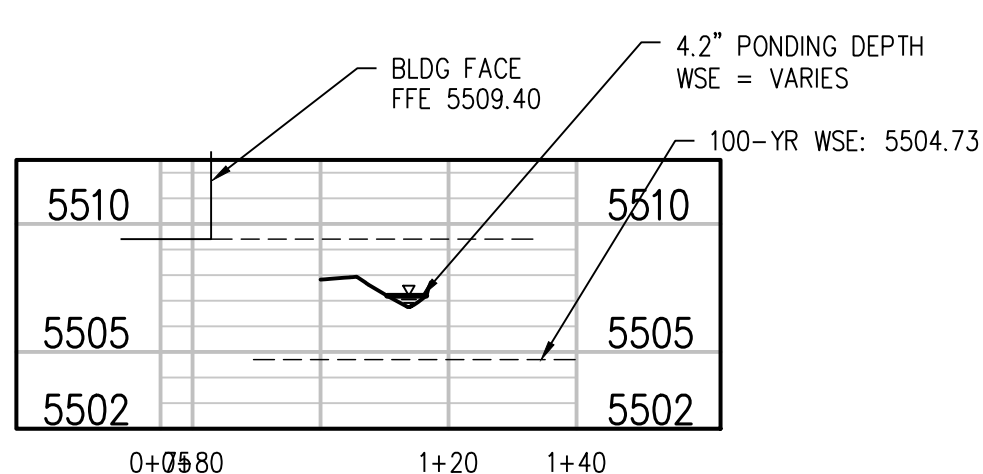

South Swale Section (I-I) Cross Section

SCALE: 1"=30' HORIZ  
1"=8' VERT

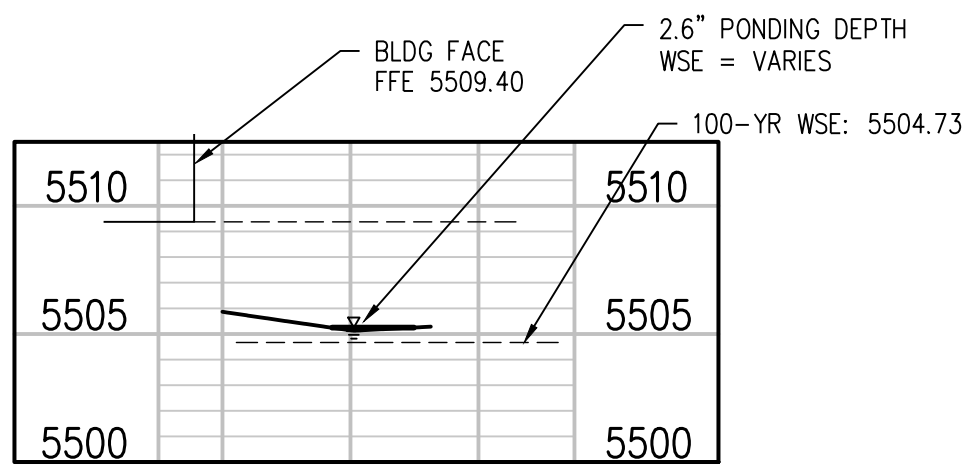

Eastern Pan (J-J) Cross Section

SCALE: 1"=30' HORIZ  
1"=8' VERT

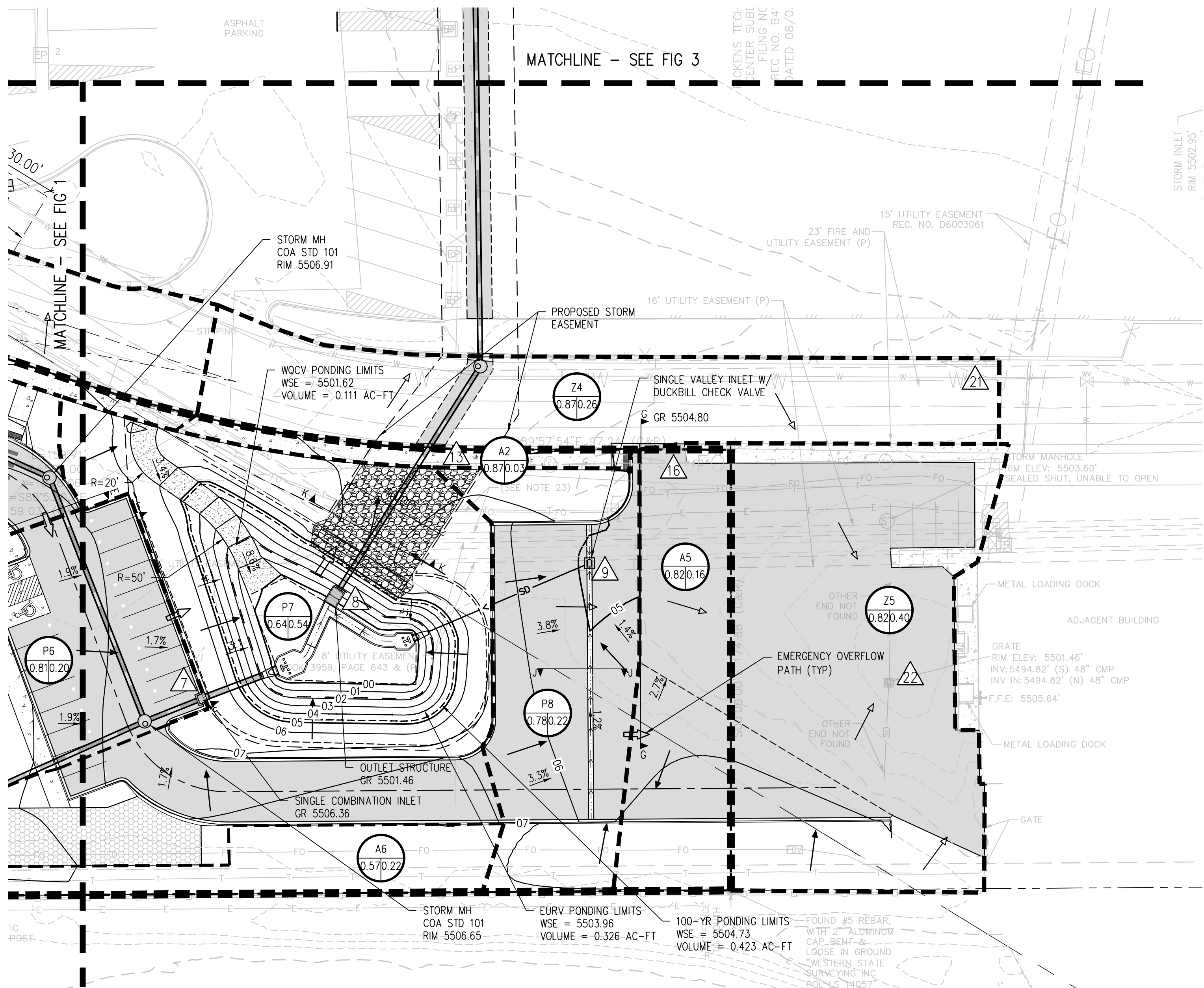

DRAINAGE MAP LEGEND

- HISTORIC DRAINAGE BASIN BOUNDARY (MAJOR BASIN)
- HISTORIC DRAINAGE BASIN BOUNDARY (SUB BASIN)
- DEVELOPED DRAINAGE BASIN BOUNDARY (MAJOR BASIN)
- DEVELOPED DRAINAGE BASIN BOUNDARY (SUB BASIN)
- DIRECTION OF FLOW (HISTORIC)
- DIRECTION OF FLOW (DEVELOPED)
- OVERFLOW PATH
- BASIN DESIGN POINT
- DRAINAGE BASIN IDENTIFICATION BUBBLE
  - A = DEVELOPED BASIN DESIGNATION
  - .50 = 100-YR RUNOFF COEFFICIENT
  - 1.0 = AREA ACRES

NOTES:

- ALL DRAINAGE FACILITIES ON SITE, INCLUDING ROOF DRAINS ARE PRIVATE AND SIZED FOR THE 100-YEAR STORM EVENT.
- CITY OF AURORA PLAN REVIEW IS ONLY FOR GENERAL CONFORMANCE WITH CITY OF AURORA DESIGN CRITERIA AND THE CITY CODE. THE CITY IS NOT RESPONSIBLE FOR THE ACCURACY AND ADEQUACY OF THE DESIGN, OF DIMENSIONS AND ELEVATIONS WHICH MUST BE CONFIRMED AND CORRELATED AT THE JOB SITE. THE CITY OF AURORA, THROUGH THE APPROVAL OF THIS DOCUMENT, ASSUMES NO RESPONSIBILITY FOR THE COMPLETENESS AND/OR ACCURACY OF THIS DOCUMENT.
- APPROVAL OF THIS DOCUMENT BY CITY OF AURORA DOES NOT IMPLY APPROVAL FOR ANY OFF-SITE WORK ON ADJACENT PRIVATE PROPERTY. IT IS THE OWNER'S RESPONSIBILITY TO COORDINATE WITH ADJACENT PROPERTY OWNERS AND OBTAIN ALL NECESSARY APPROVALS AND EASEMENTS FOR SUCH WORK.
- ALL SWALES AND DITCHES ARE PRIVATELY MAINTAINED.

BENCHMARK:

COA ID: 456609SW002  
ELEVATION: 5,504.48 (NAVD 88)  
DESCRIPTION: CHISELED SQ SW COR CONC PED. OF STREET LIGHT #38-91 ON THE E SIDE OF AIRPORT BLVD. @ 100' +/- S OF E. CENTRETECH PKWY BEING ON THE W. SIDE OF AIRPORT BLVD REV. EXT NOT., REV. DESC. FROM ELLSWORTH TO CENTRETECH PKY.

Approved For One Year From This Date

Aurora Water - Drainage Division

Date



JVA, Inc. 1319 Spruce Street  
Boulder, CO 80302 303.444.1951  
www.jvajva.com  
Boulder • Fort Collins • Winter Park  
Glenwood Springs • Denver

PRELIMINARY  
NOT FOR  
CONSTRUCTION

DESIGNED BY: AMP/TWW  
DRAWN BY: CMS  
CHECKED BY: HMM  
JOB #: 3533c  
DATE: AUG, 2024  
© JVA, INC.

PICKENS TECHNOLOGY CENTER FILING

#05 - LOT 2, BLOCK 1

PRELIMINARY DEVELOPED DRAINAGE MAP

SHEET NO.

FIG 2



C:\Users\cma\appdata\local\temp\AcfPublish\_17004\3535--DDE-Detailed.dwg, 10/18/2024 -- 2:18 PM, CMS

DETENTION SUMMARY TABLE					
	VOLUME (AC-FT)	VOLUME (CF)	DEPTH (FT)	WATER SURFACE ELEV.	RELEASE RATE (CFS)
WQCV	0.111	4835	2.71	5501.62	0.1
EURV	0.326	14200	5.05	5503.96	2.4
100-YR	0.423	18425	5.82	5504.73	6.2

DEVELOPED RUNOFF SUMMARY TABLE							
Basin	Design Point	Area (Acres)	2-Yr Runoff Coeff.	100-Yr Runoff Coeff.	2-Yr Runoff (Cfs)	100-Yr Runoff (Cfs)	% Imperviousness
R	1	1.27	0.79	0.87	2.92	9.12	95%
P1	2	0.23	0.38	0.69	0.26	1.30	51%
P2	3	0.36	0.64	0.81	0.90	2.38	79%
P3	4	0.32	0.79	0.87	0.74	2.31	95%
P4	5	0.06	0.62	0.80	1.65	0.40	76%
P5	6	0.30	0.42	0.71	1.77	1.45	54%
P6	7	0.20	0.64	0.81	0.38	1.35	79%
P7	8	0.54	0.29	0.64	0.36	2.28	39%
P8	9	0.22	0.58	0.78	0.37	1.41	72%
P9	10	0.25	0.65	0.81	0.44	1.55	80%
P10	11	0.10	0.48	0.73	0.12	0.51	61%
A1	12	0.13	0.70	0.83	0.26	0.86	86%
A2	13	0.03	0.79	0.87	0.07	0.23	95%
A3	14	0.09	0.29	0.64	0.07	0.44	39%
A4	15	0.21	0.37	0.68	0.21	1.11	48%
A5	16	0.16	0.66	0.82	0.30	1.05	81%
A6	17	0.22	0.14	0.57	0.08	0.92	20%
Z1	18	0.31	0.77	0.87	0.71	2.23	94%
Z2	19	0.34	0.79	0.87	0.77	2.41	95%
Z3	20	0.57	0.79	0.87	1.31	4.08	95%
Z4	21	0.26	0.79	0.87	0.59	1.85	95%
Z5	22	0.40	0.67	0.82	0.78	2.69	82%

DRAINAGE MAP LEGEND

	HISTORIC DRAINAGE BASIN BOUNDARY (MAJOR BASIN)
	HISTORIC DRAINAGE BASIN BOUNDARY (SUB BASIN)
	DEVELOPED DRAINAGE BASIN BOUNDARY (MAJOR BASIN)
	DEVELOPED DRAINAGE BASIN BOUNDARY (SUB BASIN)
	DIRECTION OF FLOW (HISTORIC)
	DIRECTION OF FLOW (DEVELOPED)
	OVERFLOW PATH
	BASIN DESIGN POINT
	DRAINAGE BASIN IDENTIFICATION BUBBLE
A = DEVELOPED BASIN DESIGNATION	
.50 = 100-YR RUNOFF COEFFICIENT	
1.0 = AREA ACRES	

NOTES:

- ALL DRAINAGE FACILITIES ON SITE, INCLUDING ROOF DRAINS ARE PRIVATE AND SIZED FOR THE 100-YEAR STORM EVENT.
- CITY OF AURORA PLAN REVIEW IS ONLY FOR GENERAL CONFORMANCE WITH CITY OF AURORA DESIGN CRITERIA AND THE CITY CODE. THE CITY IS NOT RESPONSIBLE FOR THE ACCURACY AND ADEQUACY OF THE DESIGN, OF DIMENSIONS AND ELEVATIONS WHICH MUST BE CONFIRMED AND CORRELATED AT THE JOB SITE. THE CITY OF AURORA, THROUGH THE APPROVAL OF THIS DOCUMENT, ASSUMES NO RESPONSIBILITY FOR THE COMPLETENESS AND/OR ACCURACY OF THIS DOCUMENT.
- APPROVAL OF THIS DOCUMENT BY CITY OF AURORA DOES NOT IMPLY APPROVAL FOR ANY OFF-SITE WORK ON ADJACENT PRIVATE PROPERTY. IT IS THE OWNER'S RESPONSIBILITY TO COORDINATE WITH ADJACENT PROPERTY OWNERS AND OBTAIN ALL NECESSARY APPROVALS AND EASEMENTS FOR SUCH WORK.
- ALL SWALES AND DITCHES ARE PRIVATELY MAINTAINED.

BENCHMARK:

COA ID: 456609SW002  
ELEVATION: 5,504.48 (NAVD 88)  
DESCRIPTION: CHISELED SO SW COR CONC PED. OF STREET LIGHT #38-91 ON THE E SIDE OF AIRPORT BLVD. @ 100' +/- S OF E. CENTRETECH PKWY BEING ON THE W. SIDE OF AIRPORT BLVD REV. EXT NOT., REV. DESC. FROM ELLSWORTH TO CENTRETECH PKY.

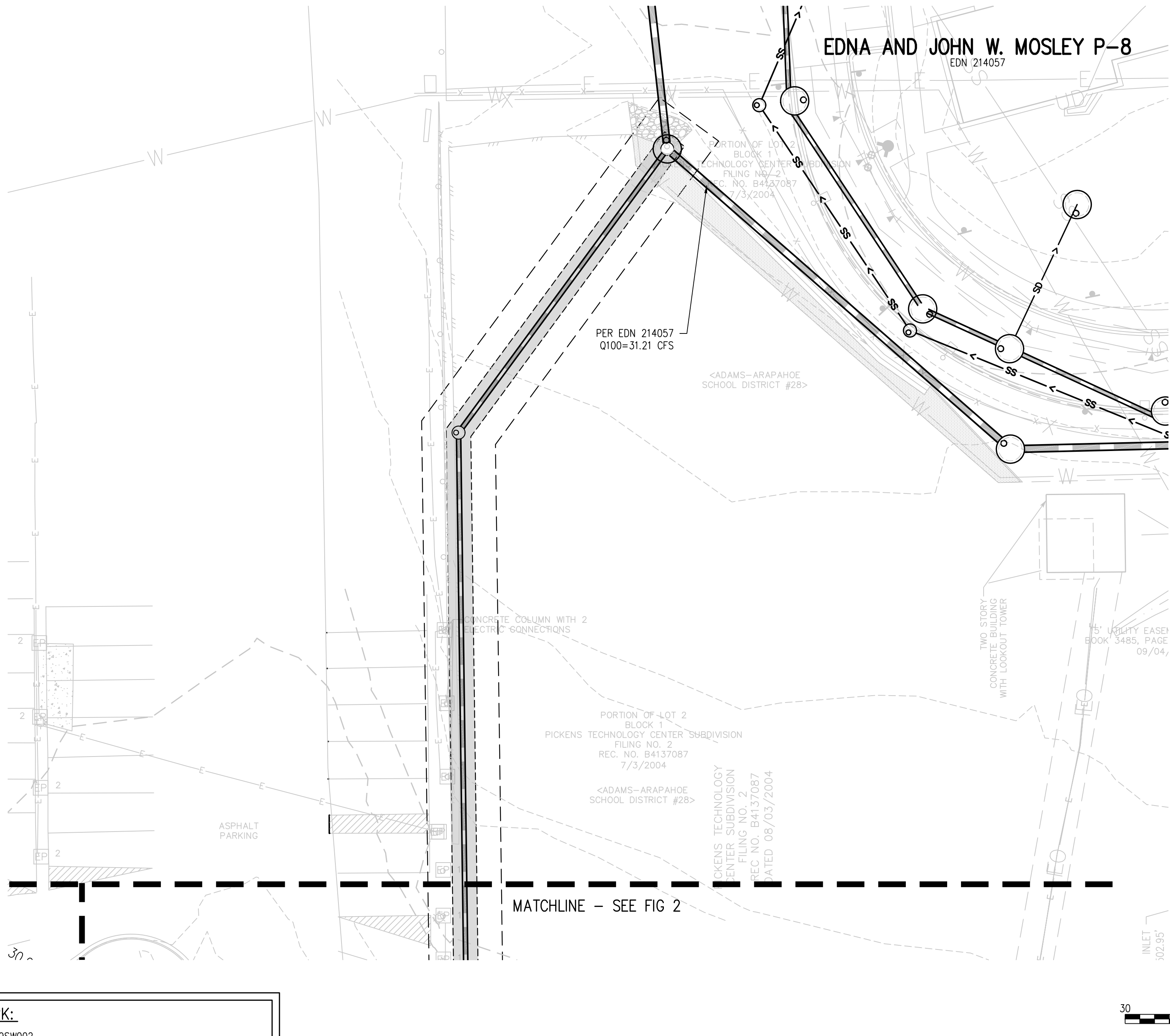

Approved For One Year From This Date

Aurora Water - Drainage Division

Date

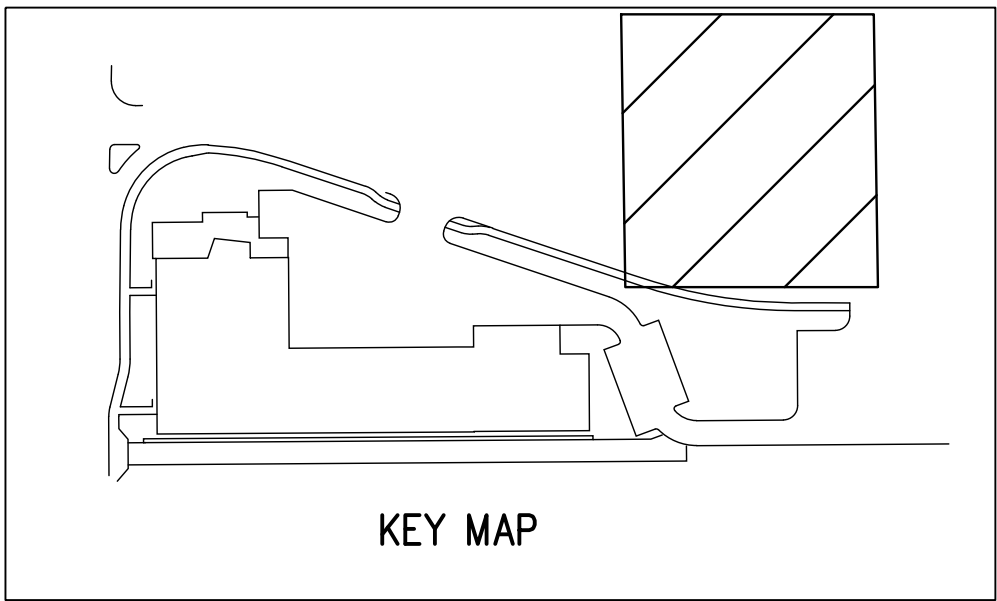

PRELIMINARY  
NOT FOR  
CONSTRUCTION

DESIGNED BY: AMP/TWW  
DRAWN BY: CMS  
CHECKED BY: HMM  
JOB #: 3533c  
DATE: AUG, 2024  
© JVA, INC.

PICKENS TECHNOLOGY CENTER FILING  
#05 - LOT 2, BLOCK 1

PRELIMINARY DEVELOPED DRAINAGE MAP

SHEET NO.

FIG 3