

PROJECT NO.: 096888020

**Kimley»Horn**  
4082 South Ute Street, Suite 1000  
Denver, Colorado 80237 (303) 226-3300

**QuikTrip No. 4251**  
STATION 60 FILING NO. 1  
E. COLFAX AVE & N. AIRPORT BLVD  
AURORA, CO  
165464 E 16TH PL

PROTOTYPE:	N/A
DIVISION:	COLORADO
VERSION:	002
DESIGNED BY:	SAM
DRAWN BY:	DEK
REVIEWED BY:	SAM

REV	DATE	DESCRIPTION
A	12/19/23	H/C CROSSING PLANS
A	09/18/23	REVISIONS TO ROW
A	07/28/23	SAUTRY/CASING & STORM H
A	07/19/23	LOT 1 STORM LINE D
A	06/26/23	WATER SERVICE CONNECTION
A	05/31/23	WATER SERVICE LINES

**ORIGINAL ISSUE DATE: 09/15/22**

SHEET TITLE:  
PHOTOMETRIC PLANS

SHEET NUMBER:  
**67**

PRIVATE STREET LIGHTS WILL REMAIN PRIVATELY OWNED AND MAINTAINED IN PERPETUITY



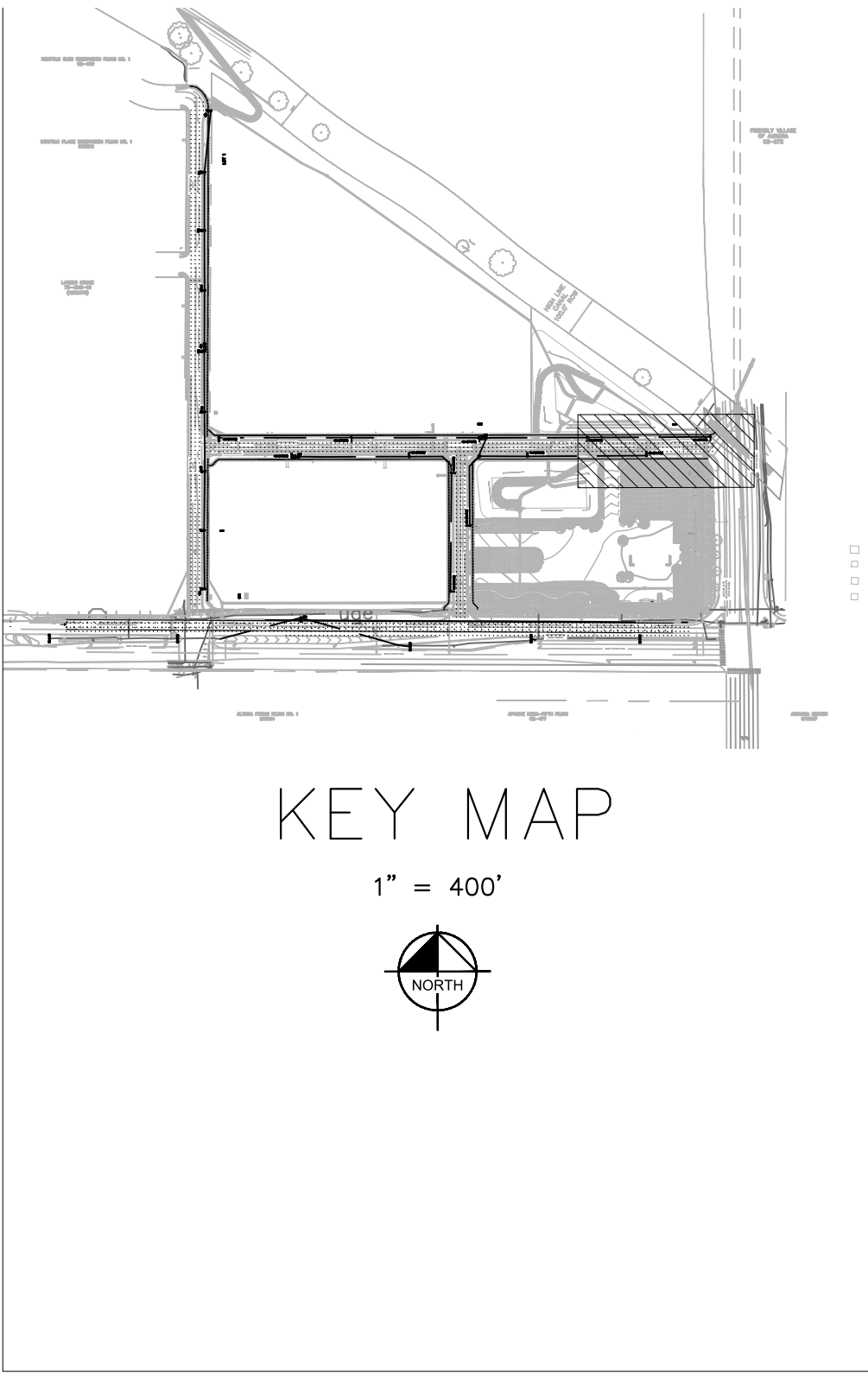
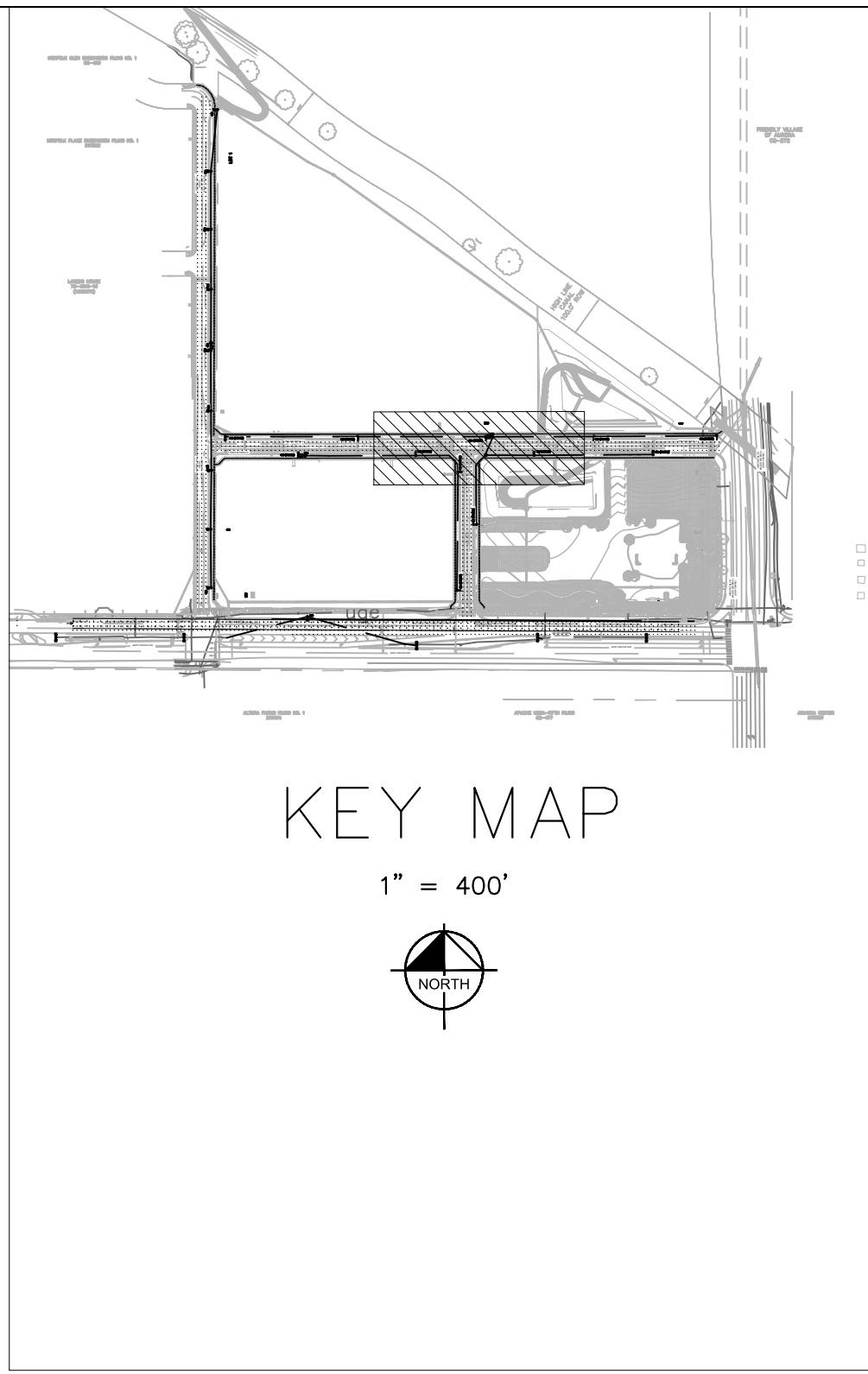
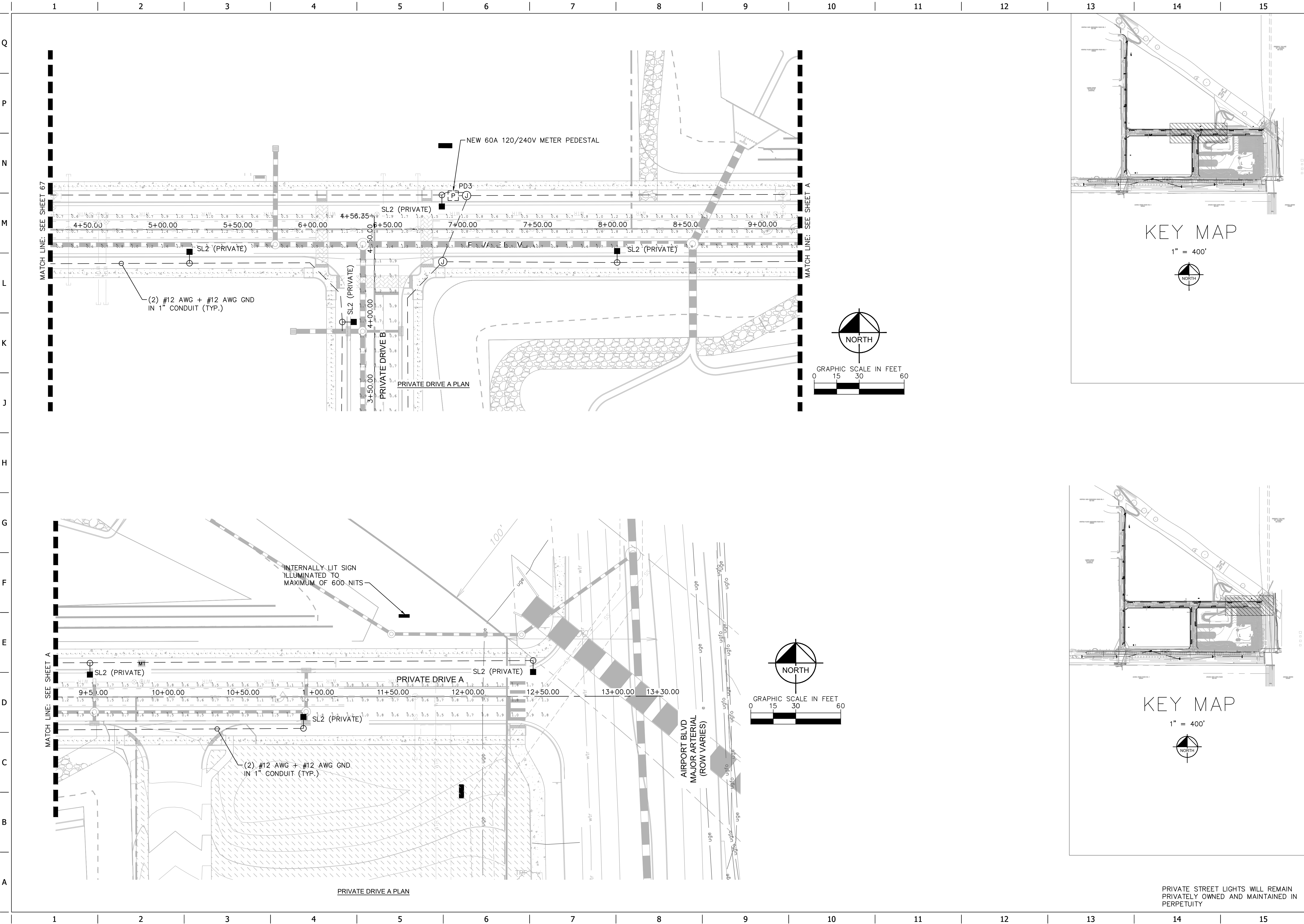

PROJECT NO.: 096888020

**Kimley»Horn**

4082 South Ute Street, Suite 1000  
Denver, Colorado 80231 (303) 228-2300

**QuikTrip No. 4251**  
STATION 60 FILING NO. 1  
E. COLFAX AVE & N. AIRPORT BLVD  
AURORA, CO  
165464 E 16TH PL

PROTOTYPE: N/A  
DIVISION: COLORADO  
VERSION: 002  
DESIGNED BY: SAM  
DRAWN BY: DEK  
REVIEWED BY: SAM

REV	DATE	DESCRIPTION
A	12/19/23	HLC CROSSING PLANS
A	09/18/23	RELOCATE AND REGRADE
A	07/28/23	SAUTRAY, CASTING & STORM H
A	07/19/23	LOT 2 STORM LINE D
A	06/26/23	WATER SERVICE CONNECTION
A	05/31/23	WATER SERVICE LINES

SHEET TITLE:  
PHOTOMETRIC PLANS

SHEET NUMBER:  
**68**

ORIGINAL ISSUE DATE: 09/15/22

PRIVATE STREET LIGHTS WILL REMAIN  
PRIVATELY OWNED AND MAINTAINED IN  
PERPETUITY



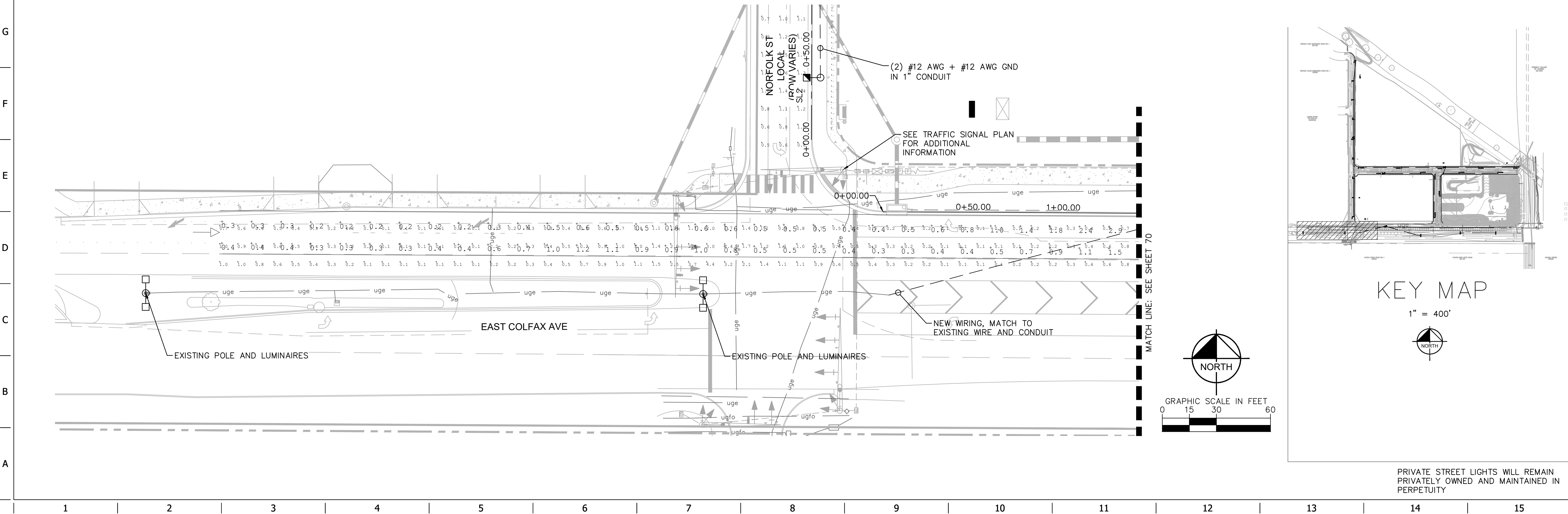
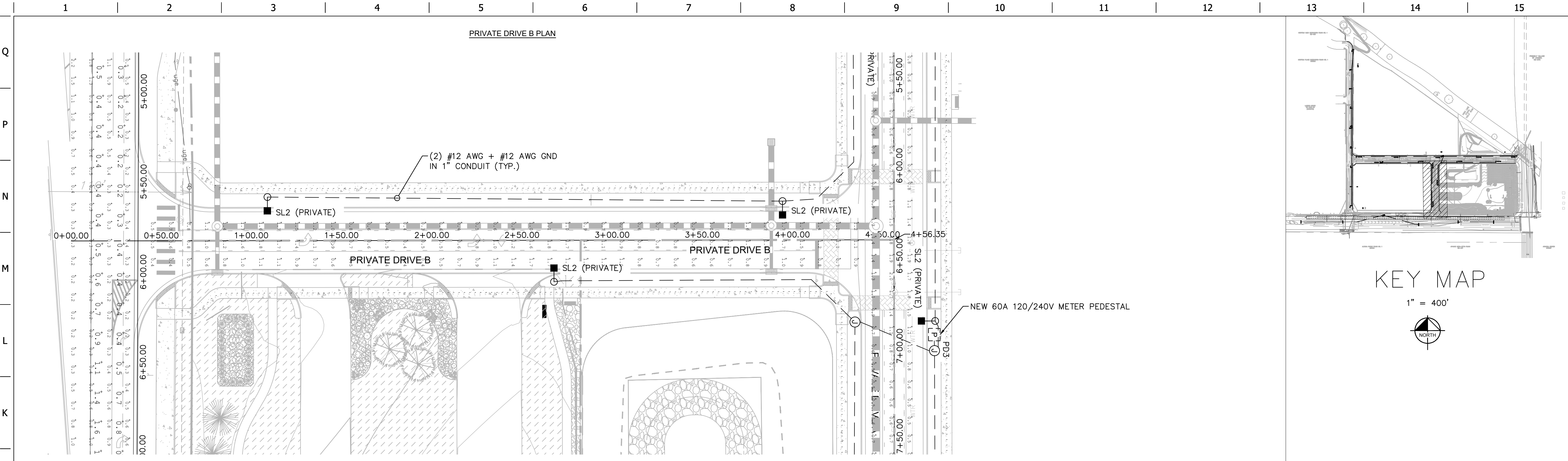

PROJECT NO.: 096888020

**Kimley»Horn**  
4262 South Ute Street, Suite 1900  
Denver, Colorado 80231 (303) 226-3300

**QuikTrip No. 4251**  
STATION 60 FILING NO. 1  
E. COLFAX AVE & N. AIRPORT BLVD  
AURORA, CO  
165464 E 16TH PL



PROTOTYPE: N/A  
DIVISION: COLORADO  
VERSION: 002  
DESIGNED BY: SAM  
DRAWN BY: DEK  
REVIEWED BY: SAM

REV	DATE	DESCRIPTION
A	12/19/23	H/C CROSSING PLANS
A	09/18/23	REV. NO. 7 AIR PHOTO
A	07/28/23	SAUTRAY, CADING & STORM H
A	07/19/23	LOT 2 STORM LINE D
A	06/26/23	WATER SERVICE
A	06/09/23	STORM SERVICE CONNECTION
A	05/31/23	WATER SERVICE LINES

SHEET TITLE:

PHOTOMETRIC PLANS

SHEET NUMBER:

69

ORIGINAL ISSUE DATE: 09/15/22

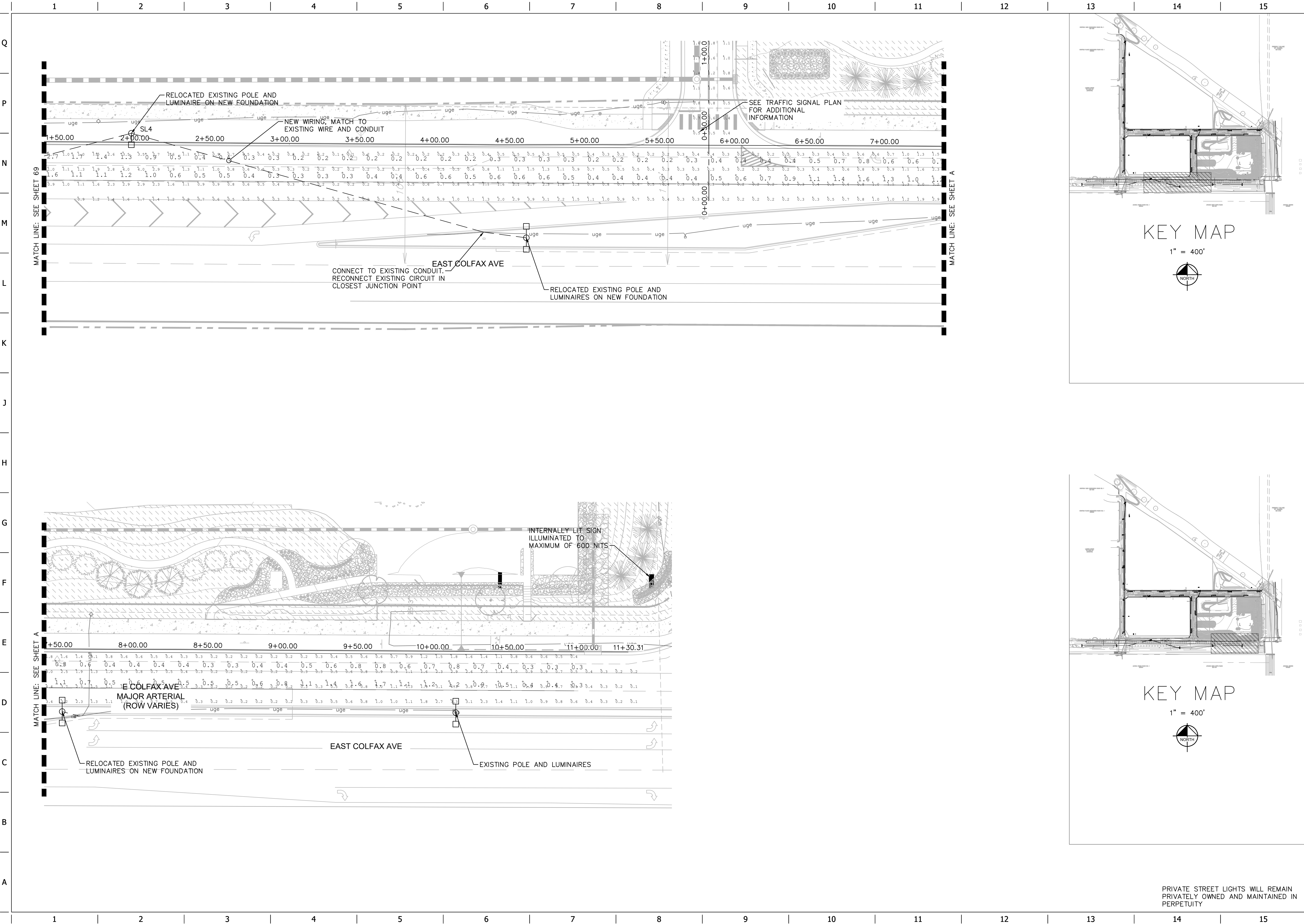

PROJECT NO.: 09688020

**Kimley»Horn**  
4002 South Vista Street, Suite 1000  
Denver, Colorado 80237 (303) 226-3300

**QuikTrip No. 4251**  
STATION 60 FILING NO. 1  
E. COLFAX AVE & N. AIRPORT BLVD  
AURORA, CO  
165464 E 16TH PL

PROTOTYPE:	N/A
DIVISION:	COLORADO
VERSION:	002
DESIGNED BY:	SAM
DRAWN BY:	DEK
REVIEWED BY:	SAM

REV	DATE	DESCRIPTION
A	12/19/23	H/C CROSSING PLANS
A	09/19/23	REV NO. 7 AND ROAD
A	07/28/23	SANITARY CASING & STORM H
A	07/19/23	LOT 1 STORM LINE D
A	06/26/23	WATER SERVICE
A	06/09/23	STORM SERVICE CONNECTION
A	05/31/23	WATER SERVICE LINES

ORIGINAL ISSUE DATE: 09/15/22

SHEET TITLE:

PHOTOMETRIC PLANS

SHEET NUMBER:

70

PRIVATE STREET LIGHTS WILL REMAIN  
PRIVATELY OWNED AND MAINTAINED IN  
PERPETUITY



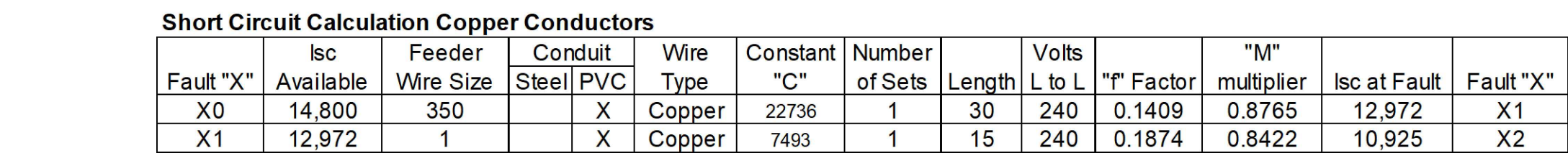

<b>A</b>	PANEL PD1
	NO SCALE

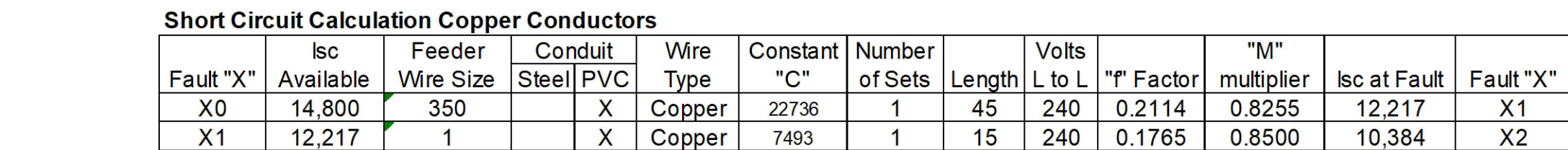

<b>B</b>	PANEL PD2
	NO SCALE

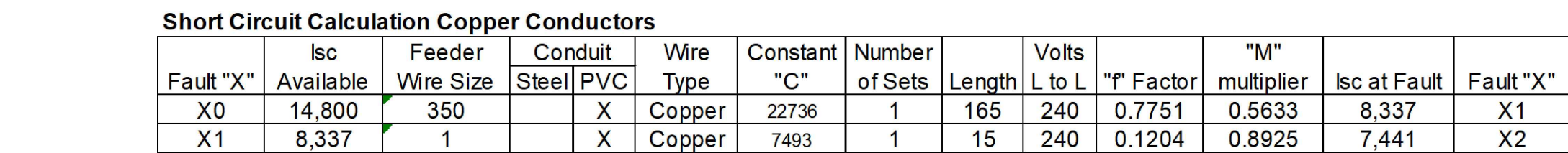

C	PANEL PD3
	NO SCALE

PANEL PD1																
Mounting Method				Panel Status				Panel Information								
SURFACE <input checked="" type="checkbox"/> FLUSH <input type="checkbox"/>				RELOCATED <input type="checkbox"/> NEW <input checked="" type="checkbox"/> EXISTING <input type="checkbox"/>				Volt: 240/120 Phase 1 Wire 3 Feeder -			Bus Rating: 60A Main Breaker: 60A AIC Rating: 14,000 Feed From: UTILITY					
Ckt #	New	Code	Description	Load VA	Bkr	P A	Ph B	P A	Ph B	8kr	Load VA	Description	Code	New	Ckt #	
1	<input type="checkbox"/>	1	LIGHTING CIRCUIT #1	540	20	1	•	-	-	-	-	SPACE	1	<input type="checkbox"/>	2	
3	<input type="checkbox"/>	1	SPACE					1	20	500	-	IRRIGATION CONTROLLER	2	<input type="checkbox"/>	4	
5	<input type="checkbox"/>	1	SPACE					-	-	-	-	SPACE		<input type="checkbox"/>	6	
7	<input type="checkbox"/>	1	SPACE					•	•	-	-	SPACE		<input type="checkbox"/>	8	
Code				Load VA	Dem					Load Summary						
1 Lighting				540	125%					Per	Phase					
2 Rec up to 10,000				500	100%					Ph A	540	VA				
3 Rec over 10,000					50%					Ph B	500	VA				
4 Motor					100%											
5 Largest Motor					125%											
6 Heater					100%					Connected		1040 VA				
5 Kitchen					100%					Code Demand		1175 VA				
6 Other					100%											
7 Sub Panel					100%					Code Demand		4.90 Amps				

CIRCUIT PD1-1 VOLTAGE DROP SUMMARY:		
	MAX VOLTAGE DROP	%
PD1-1	3.72	3.10%

PANEL ADDRESS: 1670 N NORFOLK ST

PANEL PD2

Mounting Method				Panel Status				Panel Information							
SURFACE <input checked="" type="checkbox"/>				RELOCATED <input checked="" type="checkbox"/>				Volt: 240/120				Bus Rating: 60A			
FLUSH <input type="checkbox"/>				NEW <input checked="" type="checkbox"/>				Phase 1				Main Breaker: 60A			
				EXISTING <input type="checkbox"/>				Wire 3				AIC Rating: 14,000			
								Feeder -				Feed From: UTILITY			
Ckt #	New	Code	Description	Load VA	Bkr	P	Ph A	Ph B	Bkr	Load VA	Description	Code	New	Ckt #	
1	<input type="checkbox"/>	1	LIGHTING CIRCUIT #1	268	20	1	*	-	-	-	SPACE	1	<input type="checkbox"/>	2	
3	<input type="checkbox"/>	1	SPACE				*	-	-	-	SPACE		<input type="checkbox"/>	4	
5	<input type="checkbox"/>	1	SPACE				*	-	-	-	SPACE		<input type="checkbox"/>	6	
7	<input type="checkbox"/>	1	SPACE				*	-	-	-	SPACE		<input type="checkbox"/>	8	
Code Description				Load VA	Dem	Per Phase				Load Summary					
1 Lighting				268	125%	Ph A 268 VA									
2 Rec up to 10,000					100%	Ph B VA									
Rec over 10,000					50%										
3 Motor					100%										
Largest Motor					125%										
4 Heater					100%	Connected				268 VA					
5 Kitchen					100%	Code Demand				335 VA					
6 Other					100%										
7 Sub Panel					100%	Code Demand				1.40 Amps					

CIRCUIT PD2-1 VOLTAGE DROP SUMMARY:		
	MAX VOLTAGE DROP	%
PD2-1	0.65	0.54%

PANEL ADDRESS: 16564 E 16TH PLACE

PANEL PD3

Mounting Method			Panel Status			Panel Information								
SURFACE <input checked="" type="checkbox"/>			RELOCATED <input type="checkbox"/>			Volt: 240/120			Bus Rating: 60A					
FLUSH <input type="checkbox"/>			NEW <input checked="" type="checkbox"/>			Phase 1			Main Breaker: 60A					
			EXISTING <input type="checkbox"/>			Wire 3			AIC Rating: 14,000					
						Feeder -			Feed From: UTILITY					

Ckt #	New	Code	Description	Load VA	Bkr	P	Ph	P	Bkr	Load VA	Description	Code	New	Ckt #
1	<input type="checkbox"/>	1	LIGHTING CIRCUIT #1	536	20	1	*	-	-	-	SPACE	1	<input type="checkbox"/>	2
3	<input type="checkbox"/>	1	IRRIGATION CONTROLLER	500	20	1	*	-	-	-	SPACE		<input type="checkbox"/>	4
5	<input type="checkbox"/>	1	SPACE		-		*	-	-	-	SPACE		<input type="checkbox"/>	6
7	<input type="checkbox"/>	1	SPACE		-		*	-	-	-	SPACE		<input type="checkbox"/>	8

Code	Description	Load VA	Dem	Load Summary	
1	Lighting	1036	125%	Per	Phase
2	Rec up to 10,000		100%	Ph A	536 VA
	Rec over 10,000		50%	Ph B	500 VA
3	Motor		100%		
	Largest Motor		125%		
4	Heater		100%	Connected	1036 VA
5	Kitchen		100%	Code Demand	1295 VA
6	Other		100%		
7	Sub Panel		100%	Code Demand	5.40 Amps

CIRCUIT PD3-1 VOLTAGE DROP SUMMARY:		
	MAX VOLTAGE DROP	%
PD3-1	0.71	0.59%

PANEL ADDRESS: 16703 E 16TH PLACE



A circular professional engineer seal for the state of Colorado. The outer ring contains the text "COLORADO REGISTERED" at the top and "PROFESSIONAL ENGINEER" at the bottom. Inside the ring, the name "DUSTIN J. COLWELL" is printed in a semi-circle at the top, and the license number "54946" is printed in the center. A handwritten signature, "Dustin Colwell", is written across the bottom half of the seal.

PROJECT NO.:096888020

# Kimley»»Horn

4582 South Ulster Street, Suite 1500  
Denver, Colorado 80237 (303) 228-2300

**QuikTrip No. 4251**  
STATION 60 FILING NO. 1  
E. COLFAX AVE & N. AIRPORT BLVD  
AURORA, CO  
165464 E 16TH PL



PROTOTYPE: N/A
DIVISION: COLORADO
VERSION: 002
DESIGNED BY: SAM
DRAWN BY: DEK
REVIEWED BY: SAM

REV	DATE	DESCRIPTION
A	12/19/23	HLC CROSSING PLANS
B	09/18/23	RFI NO.7 MICROPOOL
C	07/28/23	SENITARY CASING & STORM H
D	07/19/23	LOT 3 STORM LINE D
E	06/26/23	WATER STUDY SHIFT
F	06/08/23	STORM INSERTA-TEE CONNECTION
G	05/31/23	WATER SERVICE LINES

ORIGINAL ISSUE DATE: 09/15/22

SHEET TITLE

## ELECTRICAL DETAILS

SHEET NUMBER:

71



