

STAFFORD LOGISTICS CENTER
MASTER PLAN AMENDMENT #2
LAND USE, MATRIX AND
STANDARD NOTES TAB #8

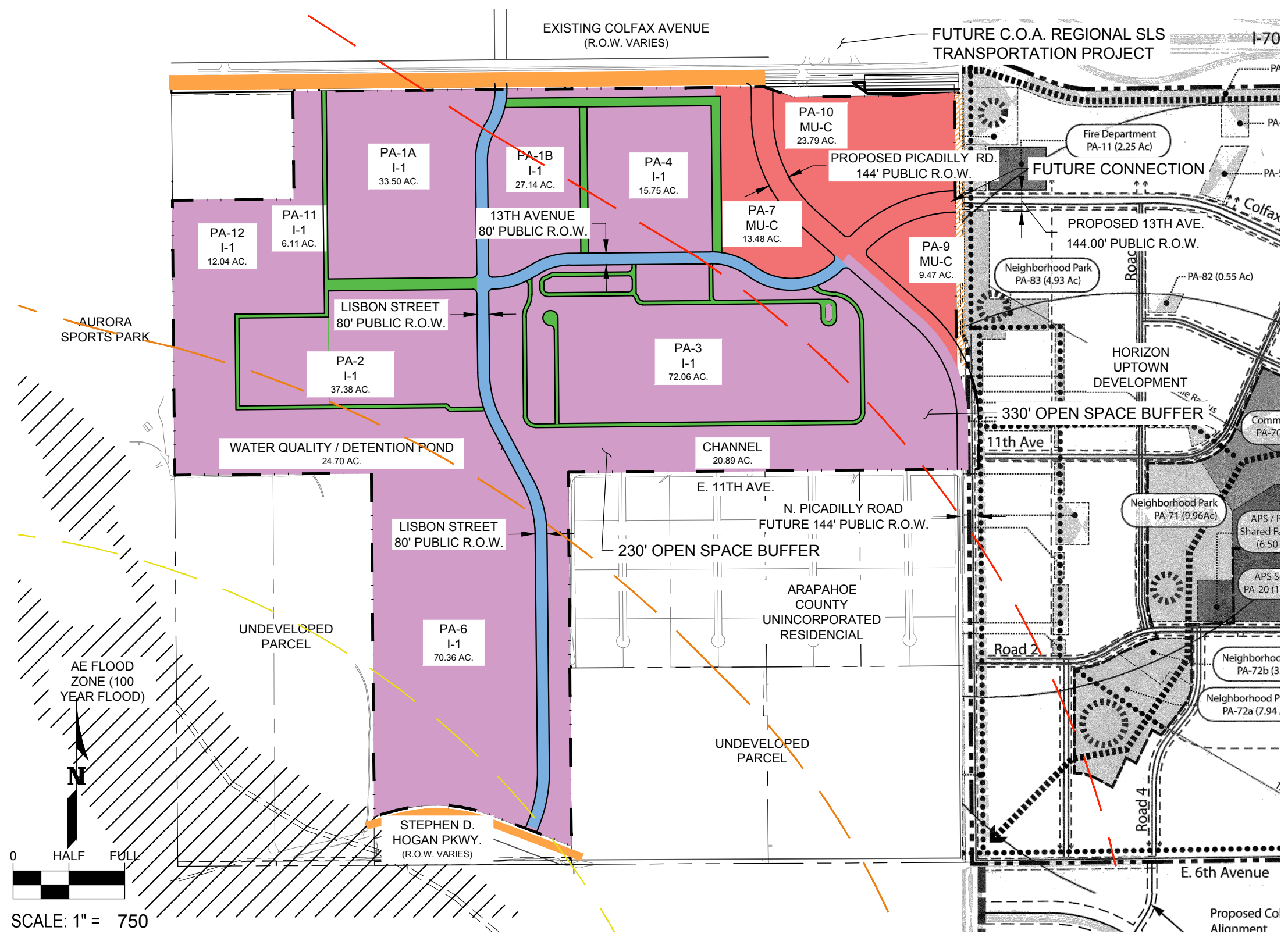

LEGEND

- OVERALL SITE BOUNDARY
- MU-C
- I-1
- EXISTING EASEMENTS
- AIRCRAFT NOISE EXPOSURE
BUCKLEY AIRFORCE BASE
- 40' PRIVATE ROADWAY
WITH ADA ACCESS

WARE MALCOMB

STAFFORD LOGISTICS CENTER
MASTER PLAN

NO.	DATE	REMARKS
1	12.2020	AMENDMENT 1
2	06.22.2023	AMENDMENT 2

JOB NO.:	DCS23-4005
PA / PM:	S. LESSARD
DRAWN BY:	J. CARANO
DATE:	06.22.2023