



95-6005-1

SITE PLAN AMENDMENT- 3250 ABILENE STREET
LOT 1, BLOCK 2, UPLAND PARK SUBDIVISION FILING NO. 1

SITUATED IN THE SOUTHWEST QUARTER OF SECTION 19 AND THE NORTHWEST QUARTER OF SECTION 30, TOWNSHIP 3 SOUTH,
RANGE 66 WEST OF THE SIXTH PRINCIPAL MERIDIAN, CITY OF AURORA, COUNTY OF ADAMS, STATE OF COLORADO

LEGEND:

	PROPERTY LINE
	EXISTING BUILDING
	PROPOSED EASEMENT
	EXISTING EASEMENT
	PROPOSED CURB & GUTTER
	EXISTING CURB & GUTTER
	PROPOSED SAWCUT
	PROPOSED ASPHALT
	EXISTING SIGN
	PROPOSED 5' CONTOUR
	PROPOSED 1' CONTOUR
	EXISTING 5' CONTOUR
	EXISTING 1' CONTOUR

NOTES:

1. ALL DIMENSIONS ARE TO FLOWLINE UNLESS OTHERWISE INDICATED.
2. ALL ELEVATION SPOTS ALONG CURB INDICATE FLOWLINE ELEVATION UNLESS OTHERWISE INDICATED.

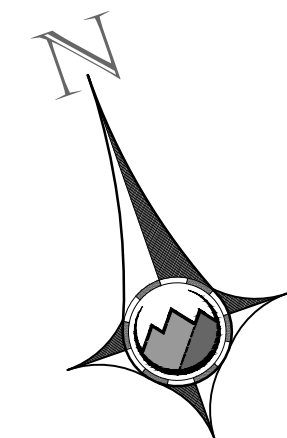

0 10 20 40
SCALE: 1" = 20'

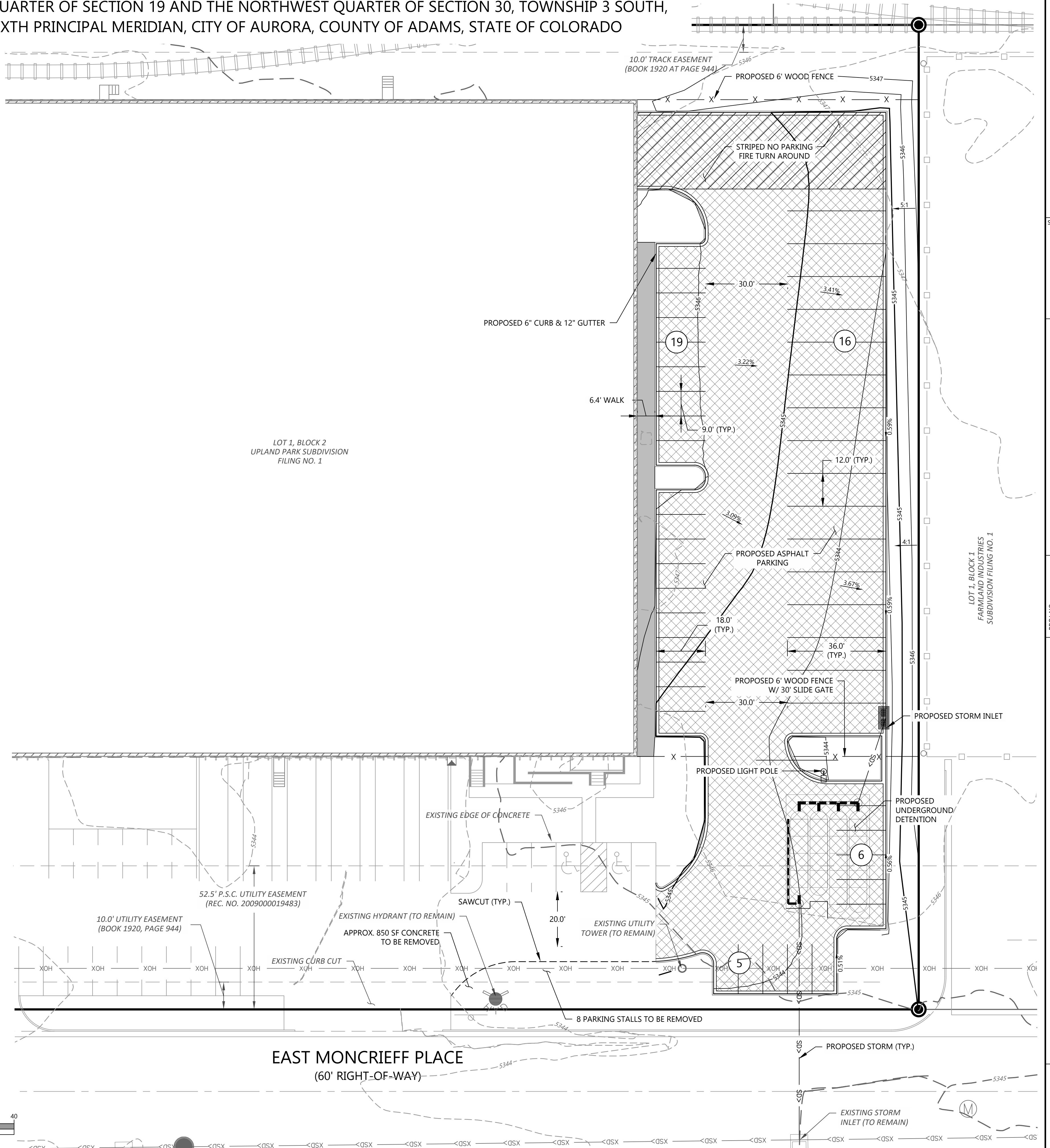

SEAL:

FOR AND ON BEHALF OF PROOF CIVIL CO.

REVISIONS

NO.	DATE	DESCRIPTION
20016	08/07/2020	
ANM		
JGD		

SITE & GRADING PLAN

3250 ABILENE STREET
SITE PLAN AMENDMENT

AURORA
COLORADO

DRAWING NO.
2

SITE PLAN AMENDMENT- 3250 ABILENE STREET
LOT 1, BLOCK 2, UPLAND PARK SUBDIVISION FILING NO. 1

SITUATED IN THE SOUTHWEST QUARTER OF SECTION 19 AND THE NORTHWEST QUARTER OF SECTION 30, TOWNSHIP 3 SOUTH,
RANGE 66 WEST OF THE SIXTH PRINCIPAL MERIDIAN, CITY OF AURORA, COUNTY OF ADAMS, STATE OF COLORADO

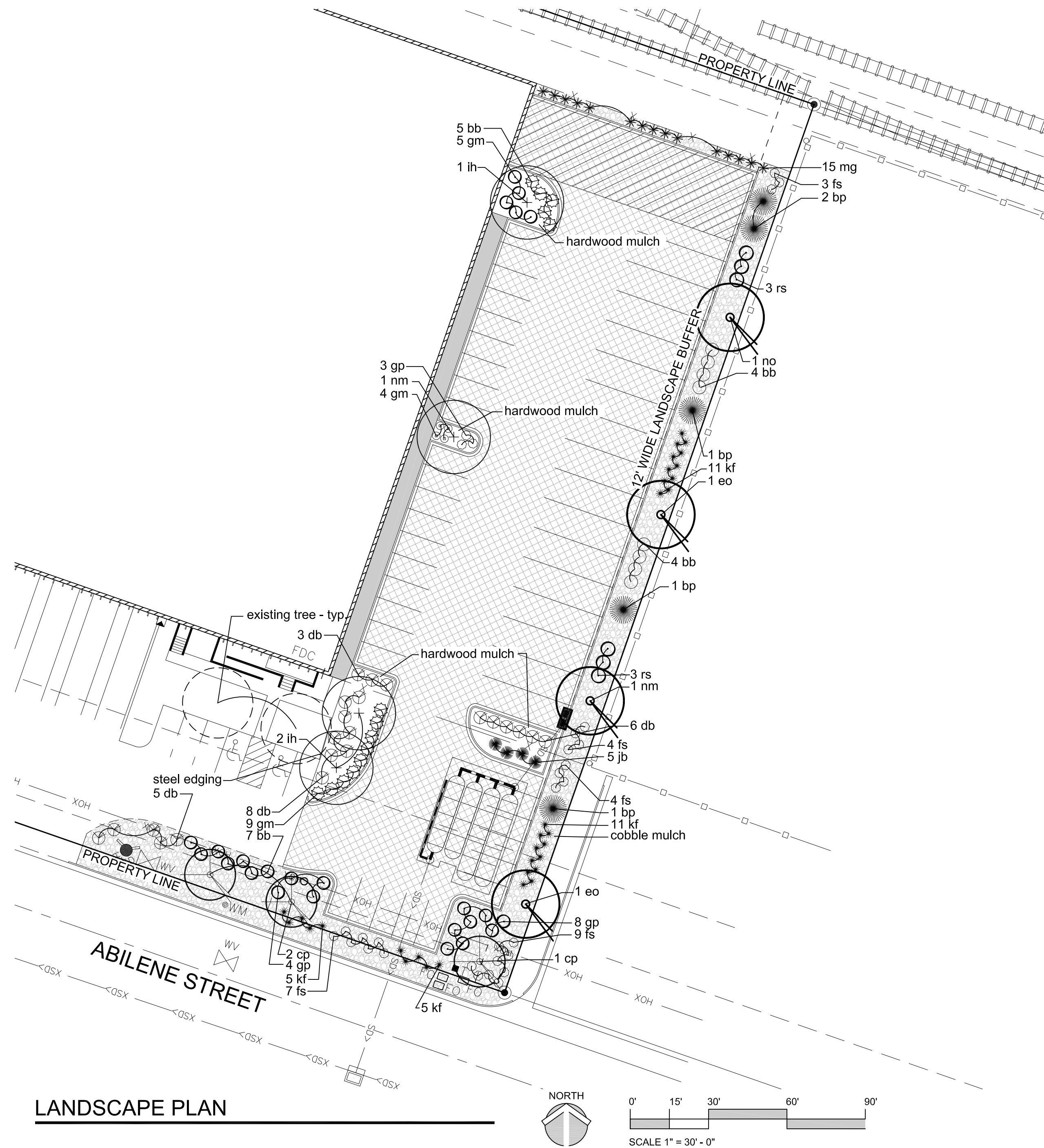

PLANT MATERIAL SCHEDULE:						
QTY.	SYMBOL	COMMON NAME	BOTANICAL NAME	SIZE	COND.	WTR
SHADE TREES						
2	nm	NORWAY MAPLE	ACER PLATANOIDES	2 1/2" CAL.	B & B	M
3	ih	IMPERIAL HONEY LOCUST	GLEDITSIA TRIACANTHOS INERMIS 'IMPERIAL'	2 1/2" CAL.	B & B	VL
1	no	NORTHERN RED OAK	QUERCUS RUBRA	2 1/2" CAL.	B & B	L-M
2	eo	ENGLISH OAK	QUERCUS ROBUR	2 1/2" CAL.	B & B	L-M
ORNAMENTAL TREES						
3	cp	CHANTICLEER PEAR	PYRUS CALLERYANA	2" CAL.	B & B	M
EVERGREEN TREES						
5	bp	BOSNIAN PINE	PINUS HELDREICHII	6' HT.	B & B	M
SHRUBS						
9	jb	BROADMOORE JUNIPER	JUNIPERUS SABINA 'BROADMOOR'	5 GAL.	CONT.	L-M
27	fs	GOLD FLAME SPIREA	SPIREA JAPONICA 'GOLDFLAME'	5 GAL.	CONT.	L-M
11	gp	GOLD DROP POTENTILLA	POTENTILLA FRUITICOSA 'GOLD DROP'	5 GAL.	CONT.	L-M
18	gm	GREEN MOUND CURRANT	RIBES ALPINUM 'GREENMOUND'	5 GAL.	CONT.	L-M
22	db	DWARF BURNING BUSH	EUONYMUS ALATA 'DWARF NANA'	5 GAL.	CONT.	L-M
6	rs	RUSSIAN SAGE	PEROVSKIA ATRIPLICIFOLIA	5 GAL.	CONT.	VL
20	bb	BEAUTY BUSH	KOLWITZIA AMABILIS	5 GAL.	CONT.	L
ORNAMENTAL GRASSES						
15	mg	MAIDEN GRASS	MISCANTHUS SINENSIS 'GRACILLIMUS'	5 GAL.	CONT.	L
32	kf	KARL REED FORESTER GRASS	CALAMAGROSTIS ACUTI 'KARL FORESTER'	5 GAL.	CONT.	M

NON-STREET FRONTAGE LANDSCAPE BUFFER						
AREA	DESCRIPTION	LENGTH	WIDTH REQUIRED	WIDTH PROVIDED (VARIANCE REQUEST)	TREES (1/40')	SHURBS (5/40')
A	EAST PROPERTY LINE	360 LF	20 FT	12 FT	9 REQ. 9 PROVIDED 5 of 9 ARE EVERGREEN (55%)	45 REQ. 52 (5) GAL. PROVIDED

LANDSCAPE LEGEND:

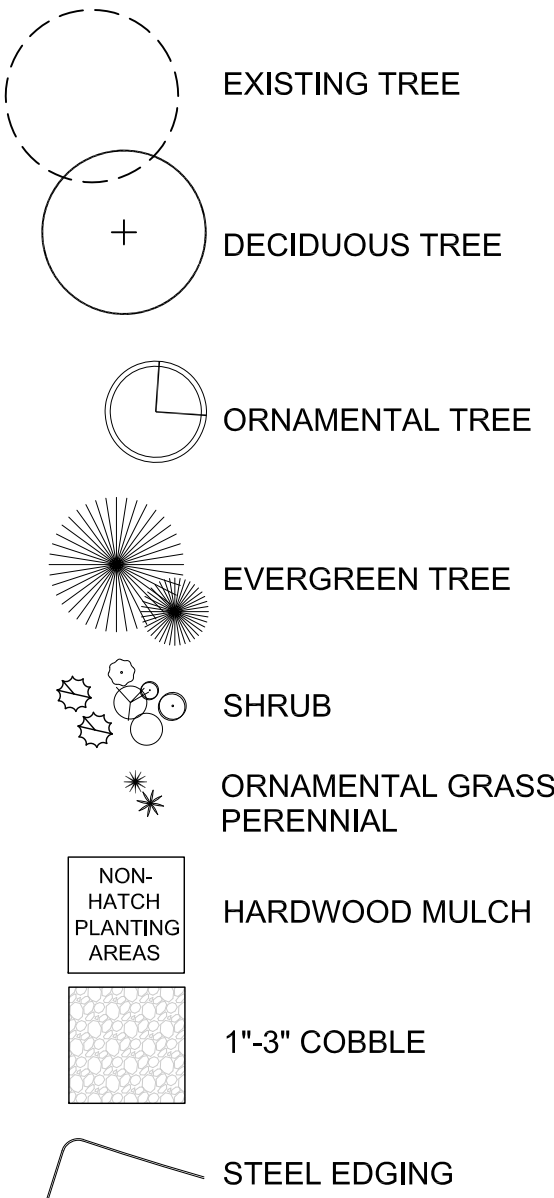

NOTES
1. ALL PROPOSED LANDSCAPING WITHIN THE SIGHT TRIANGLE SHALL BE IN COMPLIANCE WITH COA ROADWAY SPECIFICATIONS, SECTION 4.04.2.10'

PROOFcivil
consulting engineers
800 W. 8th Ave | Ste 104 | Denver, CO 80204

SEAL:

FOR AND ON BEHALF OF PROOF CIVIL CO.

REVISIONS

NO.	DATE	DESCRIPTION

PROJ. NO.: 20016

DATE: 08/06/2020

DRAWN BY: SDW

CHECKED BY: JAH

LANDSCAPE PLAN

3250 ABILENE STREET

SITE PLAN AMENDMENT

AURORA

COLORADO

DRAWING NO. 3

SITE PLAN AMENDMENT- 3250 ABILENE STREET
LOT 1, BLOCK 2, UPLAND PARK SUBDIVISION FILING NO. 1

SITUATED IN THE SOUTHWEST QUARTER OF SECTION 19 AND THE NORTHWEST QUARTER OF SECTION 30, TOWNSHIP 3 SOUTH,
RANGE 66 WEST OF THE SIXTH PRINCIPAL MERIDIAN, CITY OF AURORA, COUNTY OF ADAMS, STATE OF COLORADO

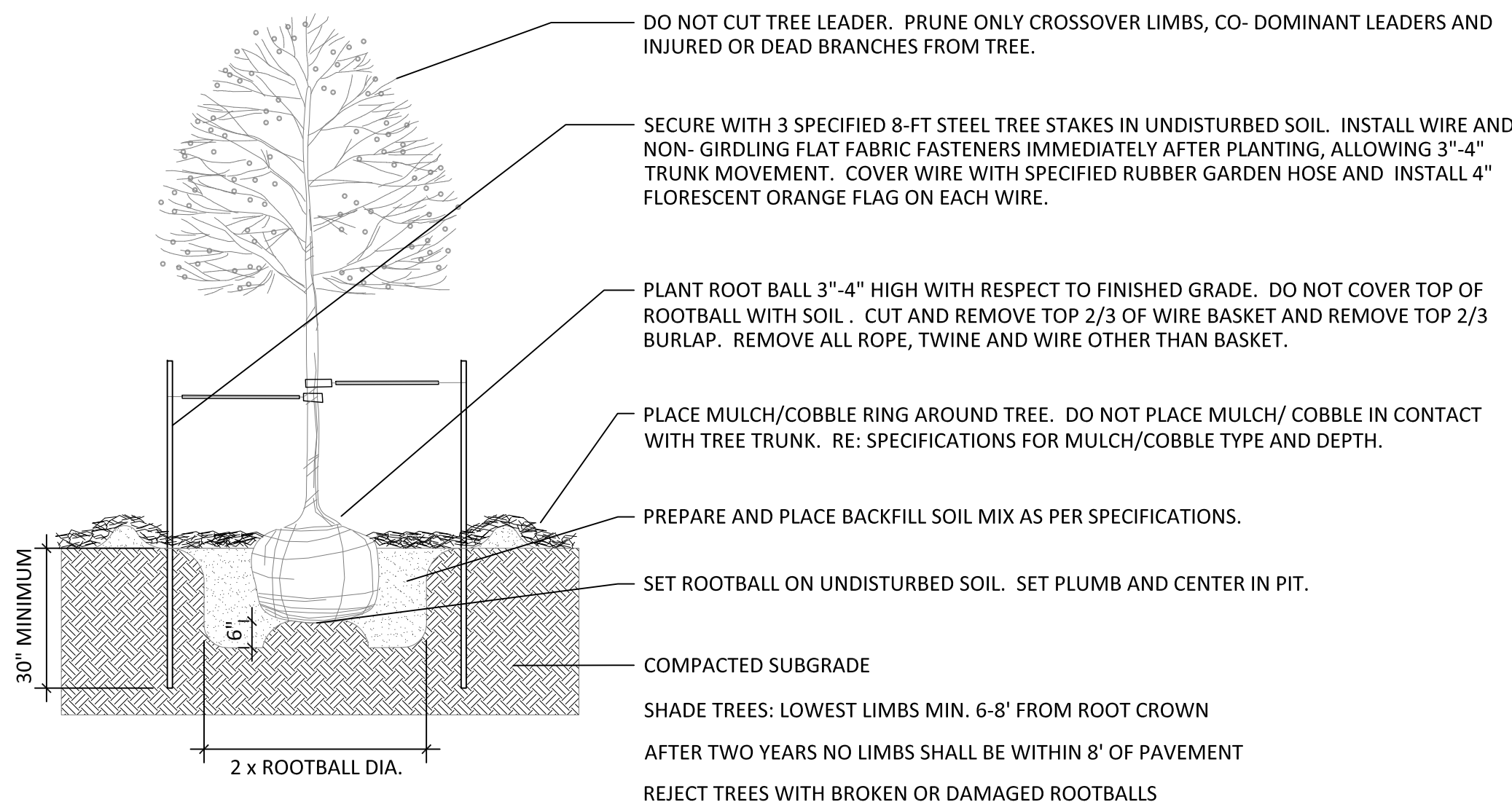

1 DECIDUOUS TREE

NOT TO SCALE

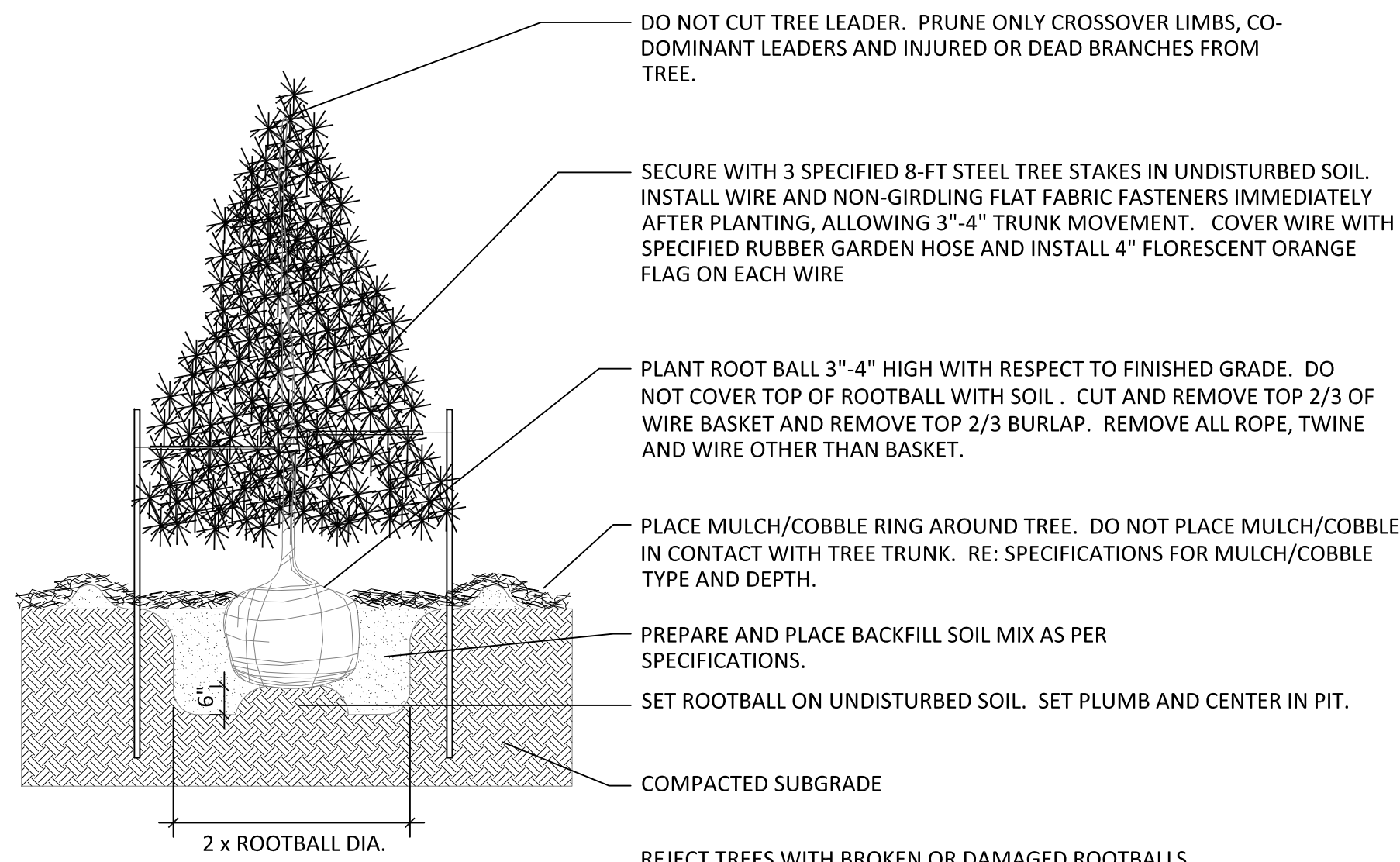

2 EVERGREEN TREE PLANTING

NOT TO SCALE

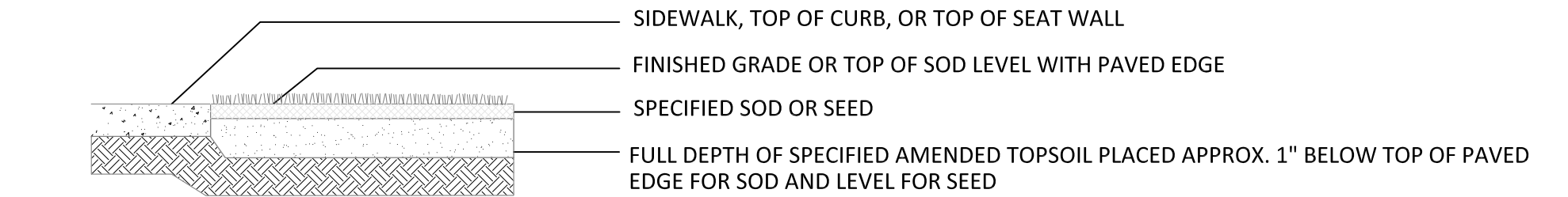

SOD ADJACENT TO WALKS AND CURBS

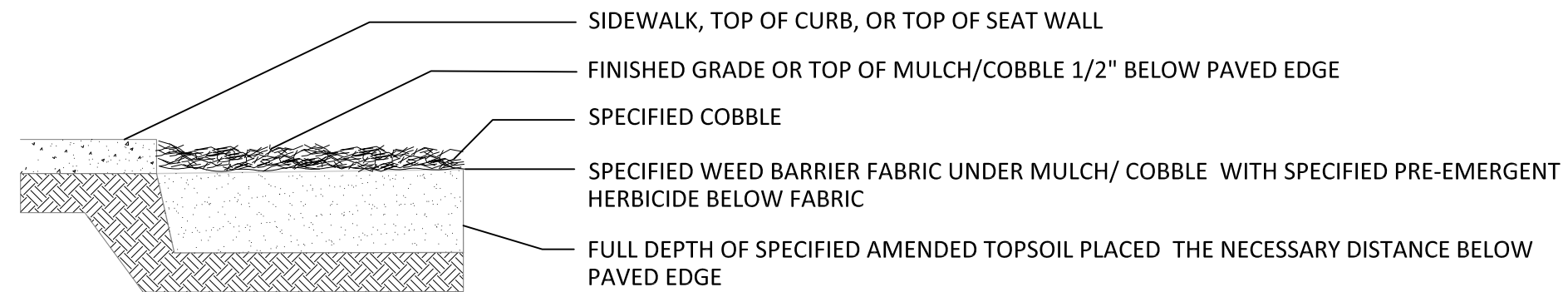

MULCH ADJACENT TO WALKS AND CURBS

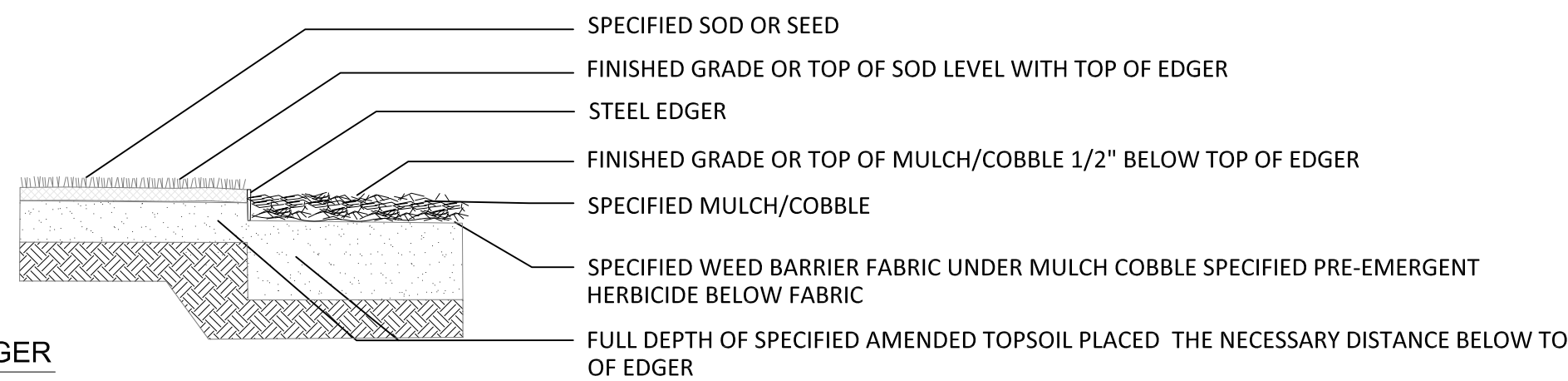

EDGER

3 EDGE TREATMENT

NOT TO SCALE

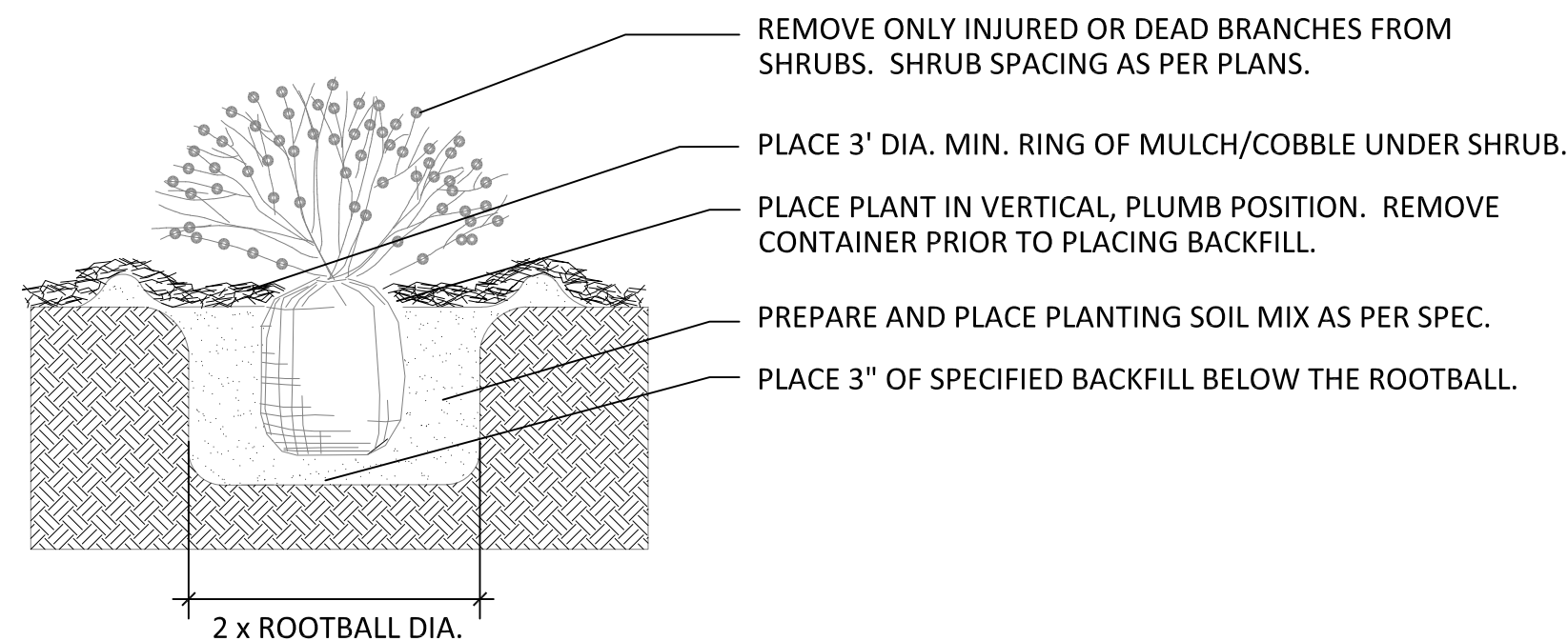

4 SHRUB PLANTING

NOT TO SCALE

STANDARD CITY OF AURORA NOTES:

1. PRIOR TO PLANTING, ALL PLANTING AREAS SHALL INCORPORATE SOIL AMENDMENTS AT A RATE OF 3 CUBIC YARDS PER 1000 SQUARE FEET TO A MINIMUM DEPTH OF 6" INCHES. A LESSER AMOUNT SHALL BE ALLOWED IF A SOILS TEST SHOWS THAT 3 CUBIC YARDS PER 1000 SQUARE FEET IS NOT NECESSARY OR WATER RETENTION AND DEEP ROOTING OF PLANT MATERIALS. IF SPECIFIED PLANT MATERIAL REQUIRES LESS FERTILE SOIL, THOSE AREAS MAY HAVE LESS SOIL AMENDMENTS INSTALLED. EXISTING TOPSOIL SHALL BE SALVAGED AND STOCKPILED FOR USE AS SOIL AMENDMENTS OR TOPSOIL. ACCEPTABLE SOIL AMENDMENTS INCLUDE COMPOST AND AGED MANURE.

2. PROPOSED SIDEWALKS TO BE STANDARD CONCRETE WITH A BROOM FINISH. ALL PARKING AND VEHICULAR DRIVES WILL BE ASPHALT.

3. ALL UTILITY EASEMENTS SHALL REMAIN UNOBSTRUCTED AND FULLY ACCESSIBLE ALONG THE ENTIRE LENGTH FOR MAINTENANCE EQUIPMENT ENTRY.

4. THE DEVELOPER, HIS SUCCESSORS AND ASSIGNS, SHALL BE RESPONSIBLE FOR INSTALLATION, MAINTENANCE AND REPLACEMENT OF ALL LANDSCAPING MATERIALS SHOWN OR INDICATED WITHIN THE PROPERTY DEFINED AS THE AREA WITHIN THE PROPERTY LINE ON THE APPROVED SITE PLAN OR LANDSCAPE PLAN ON FILE IN THE PLANNING DEPARTMENT. ALL LANDSCAPING WILL BE INSTALLED AS DELINEATED ON THE PLAN, PRIOR TO ISSUANCE OF CERTIFICATE OF OCCUPANCY.

THE METROPOLITAN DISTRICT SHALL BE CREATED BY THE DEVELOPER AND OWNER OF THE PROPERTY. THE METRO DISTRICT SHALL BE RESPONSIBLE FOR INSTALLATION, MAINTENANCE AND REPLACEMENT OF ALL LANDSCAPING MATERIALS SHOWN OR INDICATED WITHIN THE STREETScape AND REGIONAL DETENTION POND DEFINED AS THE AREA OUTSIDE OF THE PROPERTY LINE ON THE APPROVED SITE PLAN OR LANDSCAPE PLAN ON FILE IN THE PLANNING DEPARTMENT. ALL LANDSCAPING WILL BE INSTALLED AS DELINEATED ON THE PLAN, PRIOR TO ISSUANCE OF CERTIFICATE OF OCCUPANCY.

5. ALL LANDSCAPE AREAS AND PLANT MATERIAL, EXCEPT FOR NON-IRRIGATED NATIVE RESTORATION, AND DRYLAND GRASS AREAS THAT COMPLY WITH REQUIREMENTS FOUND IN SEC. 146-1429 AND/OR SEC. 146-1435 MUST BE WATERED BY AN AUTOMATIC UNDERGROUND IRRIGATION SYSTEM. IRRIGATION SYSTEM DESIGN, INSTALLATION, OPERATION, AND MAINTENANCE SHALL CONFORM TO REQUIREMENTS FOUND IN THE CITY OF AURORA IRRIGATION ORDINANCE.

6. ALL PROPOSED LANDSCAPING WITHIN THE SIGHT TRIANGLE SHALL BE IN COMPLIANCE WITH COA ROADWAY SPECIFICATIONS, SECTION 4.04.2.10.

7. THE LANDSCAPE PLAN MUST REFLECT THE LOCATION OF ALL FIRE HYDRANTS, KNOX HARDWARE AND FIRE DEPARTMENT CONNECTIONS TO ENSURE THAT THESE DEVICES ARE NOT PHYSICALLY OR VISUALLY OBSTRUCTED FROM RESPONDING FIRE CREWS. THE SEPARATION REQUIREMENTS FROM FIRE DEPARTMENT CONNECTIONS AND FIRE HYDRANTS MUST MEET BOTH LIFE SAFETY (TYPICALLY 5 FEET AND NO MATERIAL GREATER THAN 2 FEET IN HEIGHT) AND LANDSCAPING REQUIREMENTS. LANDSCAPING MATERIAL CANNOT BE OMITTED OR REDUCED BASED ON THE INSTALLATION OF A FIRE HYDRANT WITHIN A PARKING LOT ISLAND OR PLANT BED. IT IS RECOMMENDED THAT THE ISLAND OR PLANT BED BE CONSTRUCTED LARGE ENOUGH TO ADEQUATELY ACCOMMODATE BOTH LANDSCAPING MATERIAL AND FIRE HYDRANTS IN ORDER TO COMPLY WITH ALL CITY STANDARDS.

8. STREETLIGHTS MUST BE CONSTRUCTED ALONG ALL PUBLIC STREETS AS REQUIRED BY SECTION 126-236. SIDEWALKS, INTERNAL PEDESTRIAN PATHS, AND BICYCLE PATHS SHALL BE LIT WITH FULL CUTOFF LIGHTING FIXTURES NO MORE THAN 16 FEET TALL, AND PROVIDING CONSISTENT ILLUMINATION OF AT LEAST ONE FOOTCANDLE ON THE WALKING SURFACE. LIGHTING ALONG PUBLIC STREETS AND LANDSCAPED AREAS SHALL BE OF A RECOGNIZABLY UNIFIED DESIGN. LIGHTING SOURCES SHALL BE COLOR-CORRECT TYPES SUCH AS HALOGEN OR METAL HALIDE, AND LIGHT TYPES OF LIMITED SPECTRAL EMISSION, SUCH AS LOW PRESSURE SODIUM OR MERCURY VAPOR LIGHTS, ARE PROHIBITED EVEN IN SERVICE AREAS. PRIVATE AND SECURITY LIGHTING SHALL NOT CAUSE GLARE ABOVE A LEVEL OF 4 FEET ONTO ADJACENT PROPERTIES.

GENERAL PLANTING NOTES:

1. NO MATERIAL SUBSTITUTIONS SHALL BE MADE WITHOUT THE LANDSCAPE ARCHITECTS APPROVAL IN WRITING. ALTERNATE MATERIALS OF SIMILAR SIZE AND CHARACTER MAY BE CONSIDERED IF SPECIFIED PLANT MATERIALS CANNOT BE OBTAINED.
2. QUANTITIES OF MATERIALS SHOWN ON THE PLANTING PLAN TAKE PRECEDENCE OVER QUANTITIES SHOWN ON THE PLANT MATERIAL SCHEDULE.
3. VERIFY EXACT LOCATION OF ALL UTILITIES BY CONTACTING APPROPRIATE UTILITY COMPANIES.
4. COMMERCIAL GRADE $\frac{3}{16}$ INCH BY 4" POWDER COATED STEEL EDGING SHALL BE USED TO SEPARATE ALL TURF AREAS FROM PLANTING BEDS. PLACE EDGING FLUSH WITH GRADE AND STAKE TO GROUND PER MANUFACTURES RECOMMENDATIONS.
5. PLACE FOUR INCHES OF MULCH AS INDICATED IN THE LANDSCAPE LEGEND IN ALL SHRUB BEDS, GROUND COVER, PERENNIAL BEDS. PLACE 4 INCHES OF CEDAR MULCH AT ALL TREE SAUCERS.
6. ALL PLANTING BEDS SHALL RECIEVE 1"-3" RIVER ROCK MULCH UNLESS OTHERWISE NOTED ON THE PLANS. TREAT BEDS WITH A PRE-EMMERGENT HERBICIDE PRIOR TO PLANTING AND MULCH PLACEMENT. DO NOT APPLY HERBICIDE IN PERENNIAL OR ANNUAL BEDS.
7. ALL LANDSCAPE AREAS SHALL BE IRRIGATED BY AN UNDERGROUND AUTOMATIC UNDERGROUD IRRIGATION SYSTEM. WITH SEPARATE ZONES FOR TURF AND SHRUBS / TREES / GROUNDCOVER.
8. ALL PLANT MATERIALS SHALL HAVE BACKFILL. CAREFULLY PLACED AROUND BASE AND SIDES OF BALL TO TWO-THIRDS ($\frac{2}{3}$) DEPTH OF BALL THEN THOROUGHLY SOAKED WITH WATER TO ALLOW SETTLEMENT. ALL WIRE, BURLAP FASTENERS, TOP ONE-THIRD ($\frac{1}{3}$) OF BURLAP AND LOOSE BURLAP SHALL BE REMOVED AT THIS TIME THE REMAINDER OF HE PIT SHALL THEN BE BACKFILLED, ALLOWING FOR THE DEPTH OF THE MULCH SAUCER AND SETTLEMENT OF BACKFILL. BACKFILL SHALL THEN BE THOROUGHLY WATERED ONCE AGAIN.

SEAL:

FOR AND ON BEHALF OF PROOF CIVIL CO.

REVISIONS

DESCRIPTION

NO.

DATE

PROJ. NO.: 20016

DATE: 08/06/2020

DRAWN BY: SDW

CHECKED BY: JAH

LANDSCAPE DETAILS

3250 ABILENE STREET
SITE PLAN AMENDMENT

COLORADO

AURORA

DRAWING NO.

4

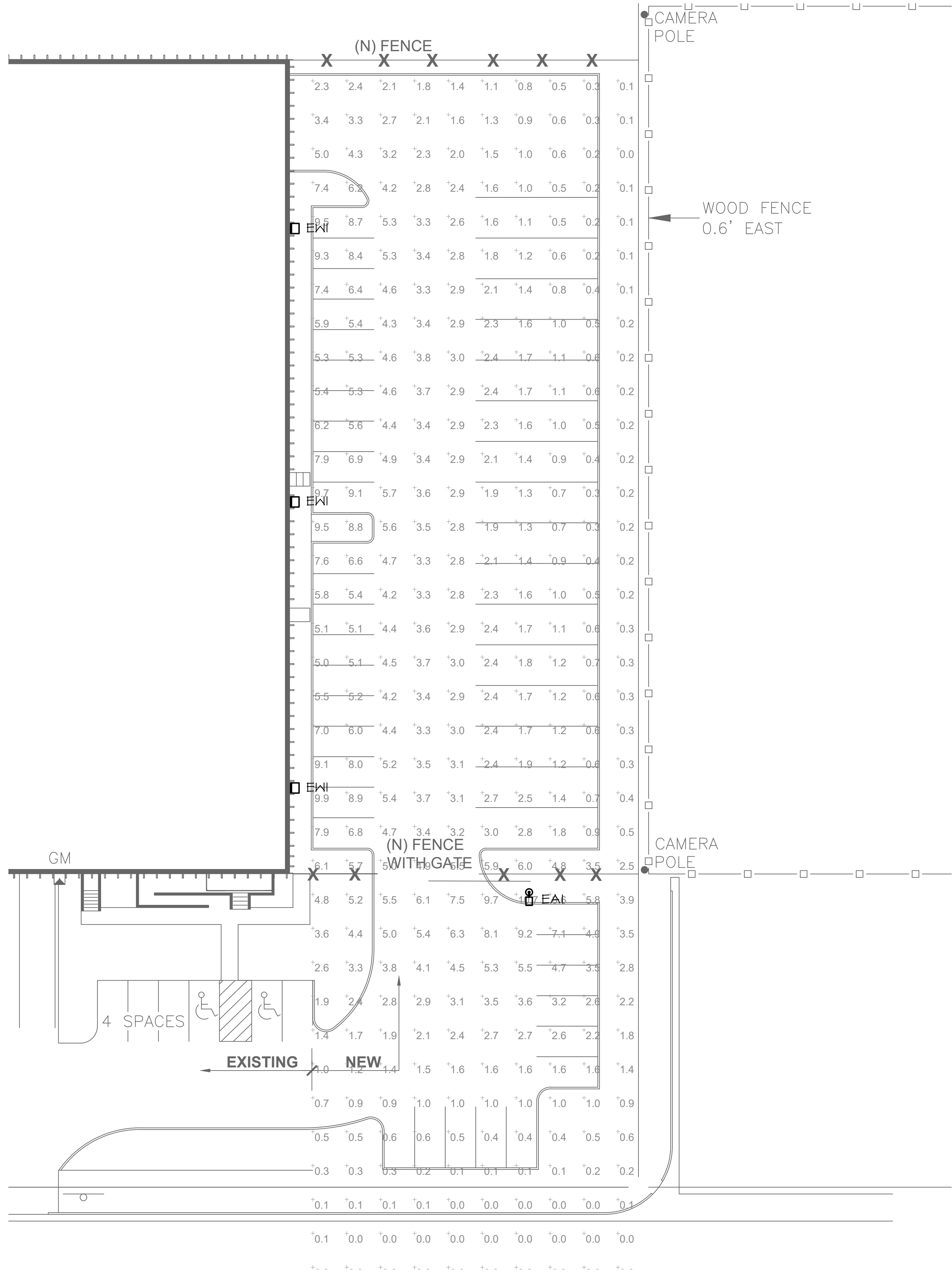

1 | PHOTOMETRIC PLAN
5 | SCALE: 1" = 20'

LIGHTING FIXTURES	
A _α	LUMINAIRE TYPE, REFERENCING LUMINAIRE SCHEDULE, TYPICAL ALL FIXTURES, SUBSCRIPT, IF SHOWN, REFERENCES WALL SWITCH.
	EXTERIOR AREA LIGHT
	EXTERIOR WALL PACK LIGHT

GENERAL NOTES	
A.	ALL LIGHTING FIXTURES ARE FULL CUT OFF WITH SHIELDING TO PREVENT GLARE AND LIGHT TRESPASS UNLESS OTHERWISE NOTED.
B.	THE PHOTOMETRIC GRID IS NO GREATER THAN TEN (10) FEET BY TEN (10) FEET AND PROVIDES LIGHTING LEVELS AT GRADE AND DIRECTLY UNDER THE FIXTURES.
C.	ALL SITE LIGHTING SHALL BE CONTROLLED VIA PHOTOCELL TIMECLOCK.
D.	ILLUMINANCE VALUES SHOWN ARE AT GRADE AND SHOULD BE CONSIDERED INITIAL USING A LIGHT LOSS FACTOR OF 1.0.
E.	ILLUMINANCE VALUES SHOWN HERE REPRESENT LIGHTING FROM LUMINAIRE SHOWN EXPLICITLY ON THIS DRAWING.
F.	ALL PARKING LOT LIGHT FIXTURES SHALL HAVE OVERALL FIXTURE HEIGHT OF 25'-0" OR LESS.

Statistics						
Description	Symbol	Avg	Max	Min	Max/Min	Avg/Min
Parking Lot	+	2.4 fc	10.7 fc	0.1 fc	N/A	N/A
Parking Spots	+	5.4 fc	9.4 fc	0.1 fc	49.0:1	53.9:1
Truck Parking	+	1.3 fc	3.0 fc	0.2 fc	15.0:1	6.5:1
Fire Lane	+	1.0 fc	5.0 fc	0.2 fc	25.0:1	9.0:1
Parking Aisle	+	3.3 fc	7.5 fc	0.7 fc	10.7:1	4.7:1
Property Line	+	0.5 fc	3.1 fc	0.0 fc	N/A	N/A

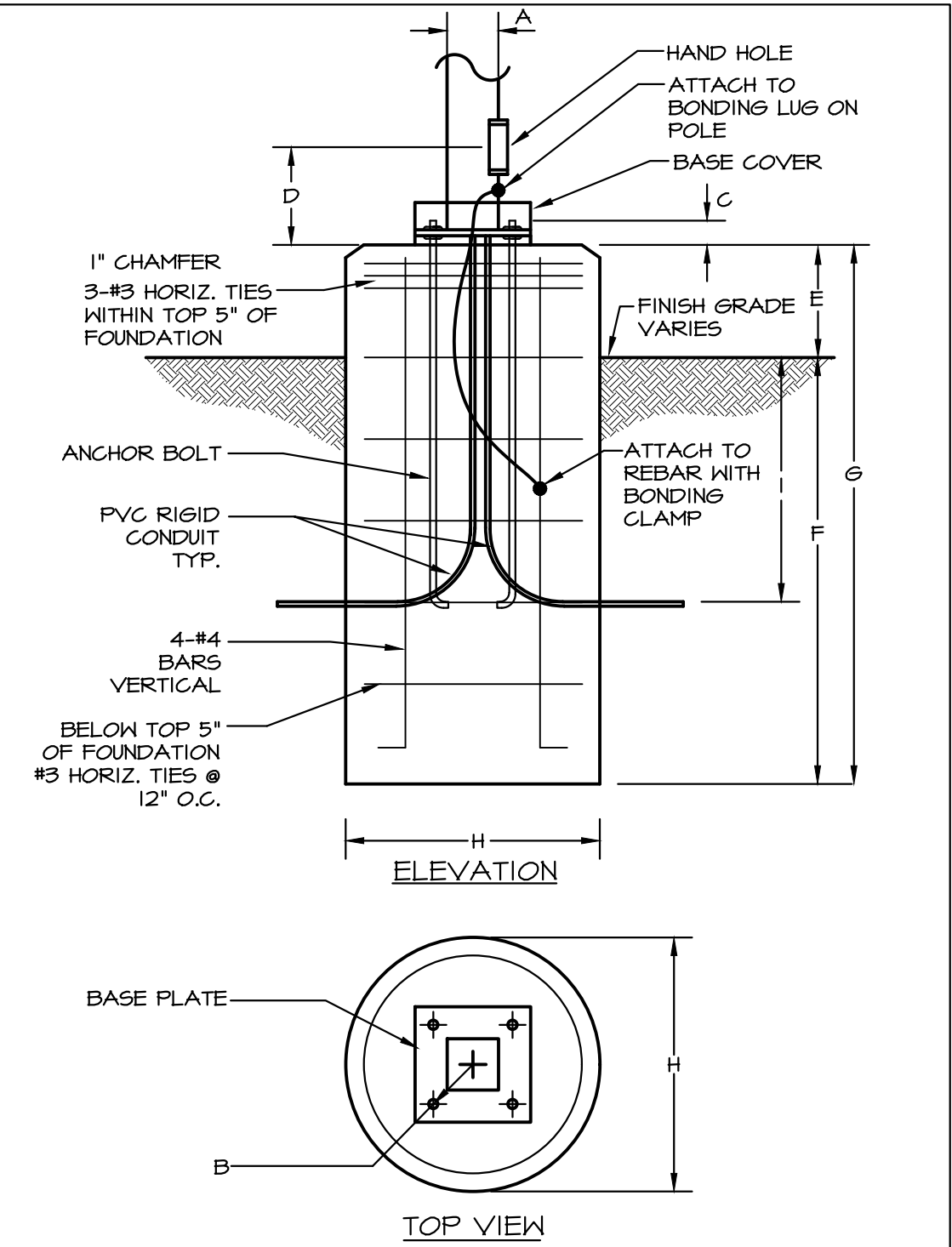

POLE KEY	OVERALL HEIGHT	A	ANCHOR BOLT DATA		D	E	F	G	H	I
EAI	25'0"	4"	SIZE	C	PER MANUFACTURER	06"	10"	16"	24"	36"

2 | POLE BASE DETAIL
SCALE: NONE

SEAL:

FOR AND ON BEHALF OF PROOF CIVIL CO.

REVISIONS

NO. DATE

PROJ. NO.: 20016
DATE: 08/06/2020
DRAWN BY:
CHECKED BY:

PHOTOMETRIC PLAN

3250 ABILENE STREET
SITE PLAN AMENDMENT

COLORADO

AURORA





DRAWING NO.

5

LIGHTING FIXTURE SCHEDULE														
TYPE	DESCRIPTION	MANUFACTURER	CATALOG NUMBER	VOLTAGE	QTY	WATT	LAMP TYPE	CCT/CRI	MAX WATTS	LUMEN OUTPUT	DIMMING	FIXTURE FINISH	MOUNTING LOCATION	INFORMATION
EAI	TYPE IV LED AREA LIGHT DUAL HEAD DIRECT ARM MOUNT BLACK FINISH BACKLIGHT SHIELD, 25" ROUND POLE	LITHONIA LIGHTING	RSX3-LED-P2-40K-R4 -RPA-DBLXD	277V	1	223	LED	4000K 80CRI	223	30574	-	BLACK	POLE	25'-0" OFH
EWI	TYPE IV LED WALL MOUNT LUMINAIRE BLACK FINISH	LITHONIA LIGHTING	RSX3-LED-P2-40K-R4 -HBA-DBLXD	277V	1	223	LED	4000K 80CRI	223	30574	-	BLACK	SURFACE WALL	25'-0" BOF
ABBREVIATIONS: BOF - BOTTOM OF FIXTURE, RFD - RECESSED FIXTURE DEPTH, OFH - OVERALL FIXTURE HEIGHT, AFF(AFS) - ABOVE FINISHED FLOOR (GRADE), WFD - WALL FIXTURE DEPTH														
GENERAL NOTES: A. ALL REFLECTOR LAMPS TO BE PROVIDED AS WIDE FLOOD DISTRIBUTION, UNLESS NOTED OTHERWISE. D. PROVIDE LUMINAIRES SHOWN AS SHADED WITH EMERGENCY BATTERY BALLASTS, UNLESS OTHERWISE NOTED. EMERGENCY LUMINAIRES SHALL SENSE UN-SWITCHED POWER TO THE SPACE AND OPERATE AUTOMATICALLY UPON LOSS OF NORMAL POWER. ALL SHADED LUMINAIRES WITH 2FT AND 4FT LAMPS SHALL HAVE ONE (1) 90 MINUTE RATED, TWO (2) 1400 LUMEN EMERGENCY BALLAST. ALL EMERGENCY LUMINAIRES SHALL HAVE REMOTE TEST SWITCHES AND VISIBLE INDICATING LIGHTS. CONNECT THE EMERGENCY BATTERY BALLAST TO THE UN-SWITCHED LEG OF THE LIGHTING CIRCUIT INDICATED.														



RSX3 LED Area Luminaire



CEILING NUMBER

SEAL

TYPE

SEE THE TAB TOP OR CONSOLE OVER THE PAGE TO SEE ALL INTERACTIVE DETAILS.

Specifications

EPA (F₁₀₀)¹:

0.70 ft² (0.07 m²)

Length:

33.9" (85.9 cm)
(SPA mount)

Width:

16.1" (40.9 cm)

Height:

3.0" (7.6 cm) Main Body
7.2" (18.3 cm) Arm

Weight (max):

48.0 lbs (21.8 kg)

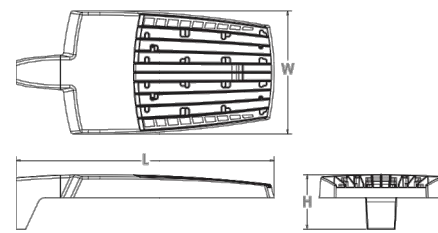

Introduction

The new RSX LED Area family delivers maximum value by providing significant energy savings, long life and outstanding photometric performance at an affordable price. The RSX3 delivers 25,000 to 41,000 lumens allowing it to replace 400W to 1000W HID luminaires.

The RSX features an integral universal mounting mechanism that allows the luminaire to be mounted on most existing drill hole patterns. This "no-drill" solution provides significant labor savings. An easy-access door on the bottom of mounting arm allows for wiring without opening the electrical compartment. A mast arm adaptor, adjustable integral slipfitter and other mounting configurations are available.

Ordering Information

EXAMPLE: RSX3 LED P4 40K R3 MVOLT SPA DDBXD

RSX3 LED					
Series	Performance Package	Color Temperature	Distribution	Voltage	Mounting
RSX3 LED	P1	30K 3000K	R2 Type 2 Wide	MVOLT (120V-277V) ¹	SPA Square pole mounting (3.0" min. x2 pole for 1 at 90°, 3.5" min. x2 pole for 2, 3, 4 at 90°)
	P2	40K 4000K	R3 Type 3 Wide	MVOLT (240V-480V) ¹	RPA Round pole mounting (3.7" min. dia. NAD pole for 2, 3, 4 at 90°, 3.0" min. dia. NAD pole for 1 at 90°, 2 at 180°, 3 at 120°)
	P3	50K 5000K	R3S Type 3 Short	(see specific voltage for options as noted)	MA Mast arm adaptor (fits 2-3/8" OD horizontal truss)
	P4		R4 Type 4 Wide	120 ¹	IS Adjustable slipfitter (fits 2-3/8" OD truss) ¹
			R4S Type 4 Short	120 ¹	277 ¹
			R5 Type 5 Wide ¹	208 ¹	347 ¹
			R5S Type 5 Short ¹	240 ¹	480 ¹
			AFR Automotive Front Row		WBAC Wall bracket with surface conduit box
			AFR90 Automotive Front Row Right-Rotated		AKSP Adjustable tilt arm square pole mounting ¹
			AFRL90 Automotive Front Row Left-Rotated		AARP Adjustable tilt arm round pole mounting ¹
				AARB Adjustable tilt arm round pole mounting ¹	
				AARB Adjustable tilt arm wall bracket ¹	
				AARWC Adjustable tilt arm wall bracket and surface conduit box ¹	

Options

Shipped Installed		Shipped Separately (requires some field assembly)	
HS House-side shield ¹		EGS External glare shield ¹	
PE Photocell, button style ^{1,2}		EGV External glare full view (360° around light aperture) ¹	
PEL Photocell, external threaded, adjustable ^{1,3}		BS Blind spikes ¹	
PER Green wire-trail kit (replace only two controls) ^{1,4,5,6}			
CE34 Conduit entry 3/4" NPT (Qty 2)			
SF Single fuse (120, 277, 347) ¹			
DF Double fuse (208, 240, 480) ¹			
SPO2WY 20W Surgepeak (20W standard)			
FAO Field adjustable output ^{1,3}			
DWG 0-10V dimming, extend out back of housing for external control (control ordered separate) ^{1,3}			

Finish

DOB10 Dark Bronze	
DBL10 Black	
DNAX0 Natural Aluminum	
DWH10 White	
DBT10 Textured Dark Bronze	
DBL10 Textured Black	
DNAT0 Textured Natural Aluminum	
DWHT0 Textured White	



COMMERCIAL OUTDOOR

One Lithonia Way • Conyers, Georgia 30012 • Phone: 800.705.7378 • www.aaculitybrands.com

© 2019-2020 Acuity Brands Lighting, Inc. All rights reserved.

Lithonia RSX3 Area LED

Rev. 02/17/20

Page 1 of 9

1 | EAI,EWI
6 | SCALE: N/A

SEAL:

FOR AND ON BEHALF OF PROOF CIVIL CO.

REVISIONS

DESCRIPTION

NO.

DATE

PROJ. NO.: 20016

DATE: 08/06/2020

DRAWN BY:

CHECKED BY:

PHOTOMETRIC DETAILS

3250 ABILENE STREET

SITE PLAN AMENDMENT

COLORADO

AURORA

DRAWING NO.

6