



BLUE EAGLE

***OPEN SPACE,
CIRCULATION AND
NEIGHBORHOOD PLAN***

TAB 9

Open Space and Circulation Plan

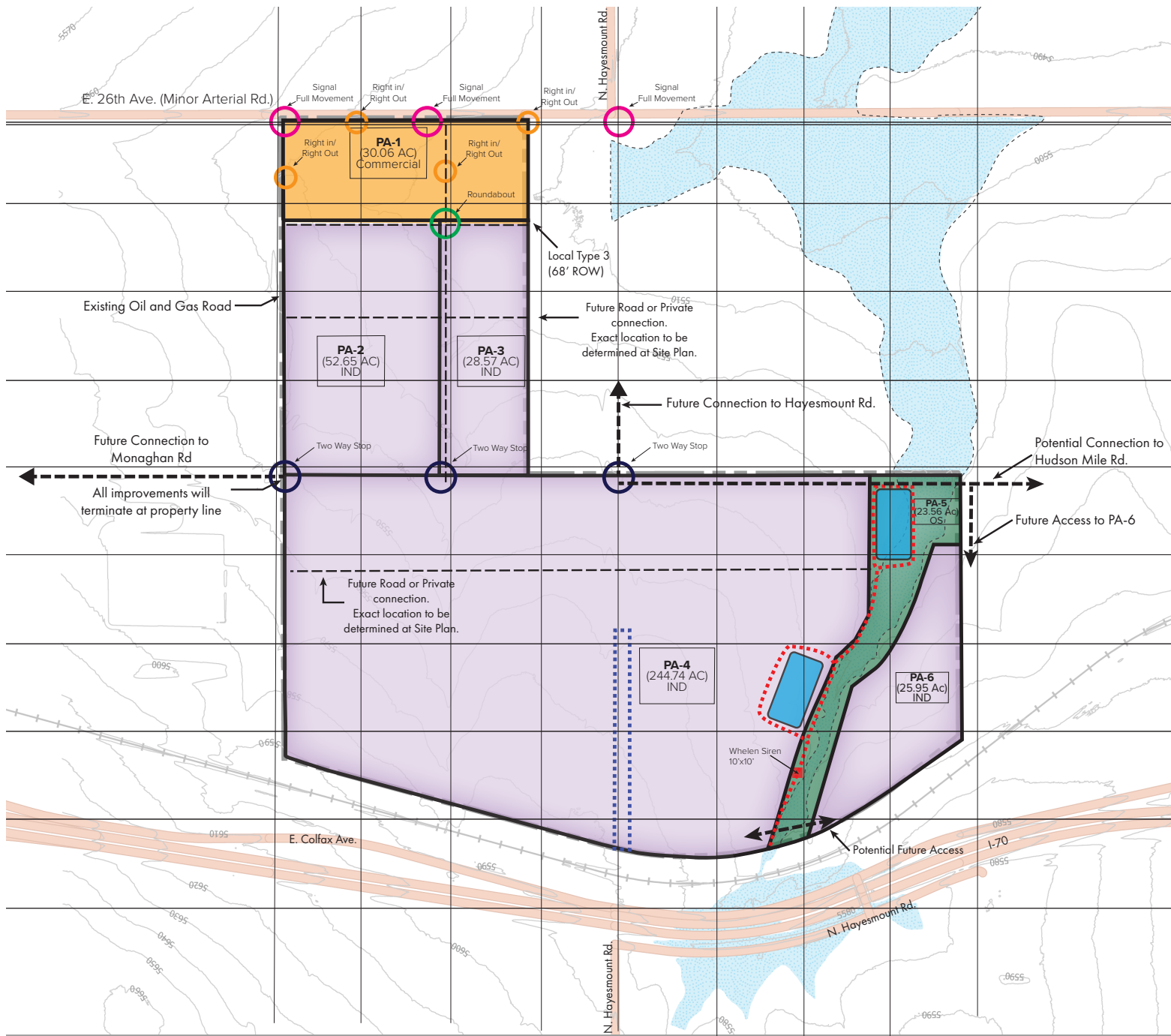

- | | | |
|-----------------|----------------------------------|----------------------|
| Industrial | Hayesmount Rd. Overpass Easement | Signal Full Movement |
| Commercial | Planning Area Boundary | Two-Way Stop |
| Open Space | Three Lane Collector (80' ROW) | Right In/Right Out |
| Detention Ponds | Local Type 3 (68' ROW) | Roundabout |
| | Minor Arterial (114' ROW) | |
| | Pedestrian Trail | |

NOTE:
1. Easement for Hayesmount Road overpass shall be dedicated at time of plat (+/- 4.9 acres).

TAB 9 - OPEN SPACE, CIRCULATION, AND NEIGHBORHOOD PLAN



PROS Matrix (Form J)

Planning Area Designation	Description & Inventory of Facilities	Total Acreage	Parks Dept. Credited Acreage	Facility Funding & Construction Responsibilities	Final Ownership & Maintenance Responsibilities	Trigger for each Phase	Comments
PA-5	Open Space	23.56	9.81	Metro District	Metro District	Will be constructed concurrent with detention and drainage in this planning area.	PA-5 consists of 13.75 acres of floodplain area. This area was subtracted from the gross parcel area. One detention pond at 3.05 acres exists within the open space and has a drain time of under 24 hours. Open space will include 6' wide crusher fines trail, shade structure/public art, benches, picnic tables, and trash receptacles. If intended to double as a maintenance trail, the width shall be 10' minimum.
Total Open Space Acreage			9.81				
Grand Total		23.56	9.81				

Director of Park, Recreation and Open Space

Date

