

COLORADO LAND SURVEY MONUMENT RECORD

Department of Regulatory Agencies
 Board of Licensure for Architects, Professional Engineers and Professional Land Surveyors
 1560 Broadway, Suite 1350
 Denver, CO 80202
 Phone (303) 894-7800; Fax (303) 894-2310; EMAIL aes@dora.state.co.us; V/TDD 711

Report one monument only on this form – Reproduction of this form is authorized.
 All items are to be filled in by the Land Surveyor using PERMANENT BLACK LETTERING and lines which can be reproduced.

- TYPE OF MONUMENT: ☐ SECTION CORNER ☒ QUARTER CORNER ☐ SIXTEENTH CORNER ☐ OTHER_____
- DESCRIPTION AND DATE OF MONUMENT FOUND:
 MONUMENT AND ACCESSORIES SET BY PLS 25369 OF CVL CONSULTANTS OF COLORADO AND BEING A 3-1/4 INCH ALUMINUM CAP SET FLUSH WITH GROUND WERE DESTROYED BY CONSTRUCTION OPERATIONS. THE POSITION OF THIS MONUMENT WAS RE-ESTABLISHED TO THE ORIGINAL POSITION FROM COMPANY FIELD NOTES AND RECORDS.
- DESCRIPTION OF MONUMENT SET BY YOU TO PERPETUATE THE LOCATION OF THIS POINT:
 SET A NO. 6 REBAR WITH A 3-1/4 INCH DIAMETER ALUMINUM CAP FLUSH WITH GROUND MARKED AS SHOWN BELOW AT THE LOCATION OF THE PREVIOUSLY LOCATED MONUMENT ALONG WITH NEW ACCESSORY POINTS AS SHOWN BELOW ON SEPTEMBER 26, 2022.
- SKETCH SHOWING RELATIVE LOCATION OF MONUMENT, ACCESSORIES AND REFERENCE POINTS STATING WHETHER FOUND OR SET, SHOW SUPPORTING AND/OR CONTRADICTORY EVIDENCE WHERE APPLICABLE:

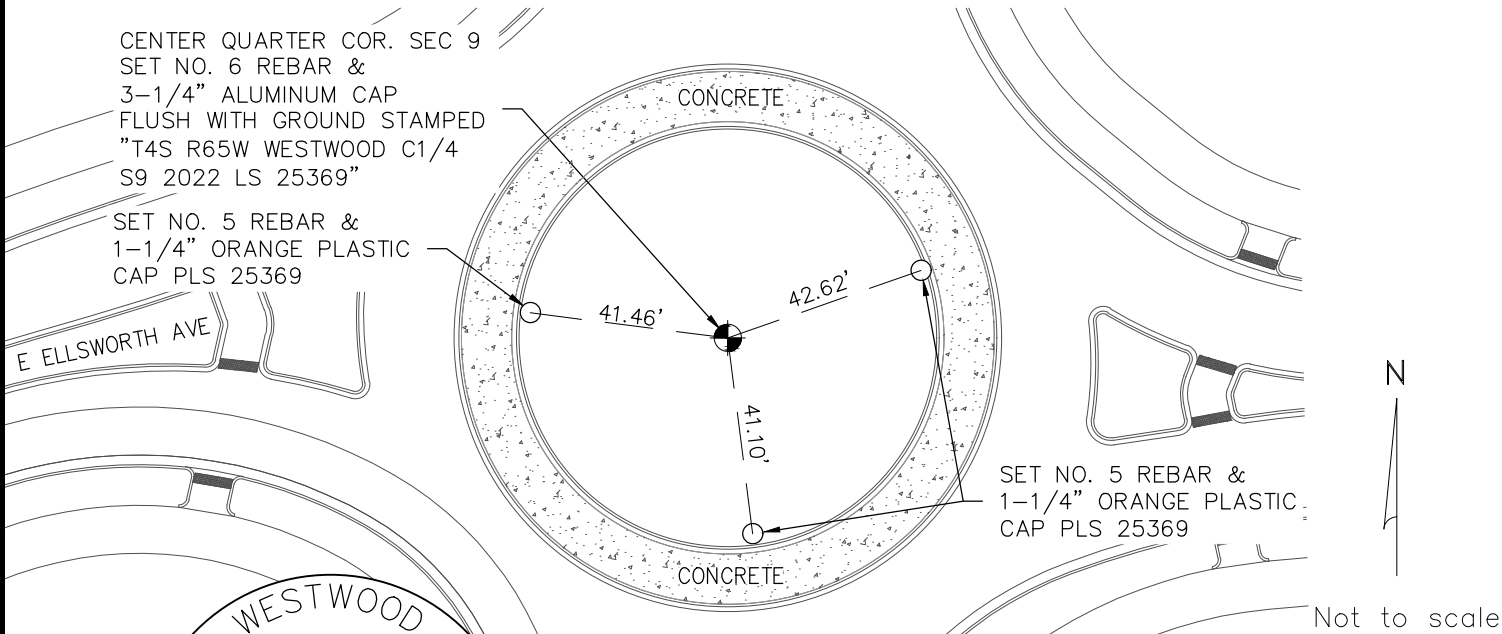

5. CERTIFICATION

This is to certify that I was in responsible charge of the surveying work described in this record and that to the best of my knowledge the information presented herein is true and correct.

Name (Please Print): WILLIAM F. HESSELBACH JR.
 Firm Name: WESTWOOD PROFESSIONAL SERVICES, INC.
 Firm Address: 10333 E. DRY CREEK RD, SUITE 240
ENGLEWOOD, CO 80112
 Phone: (720) 249-3584

6. LOCATION DIAGRAM

1" = 1 Mile

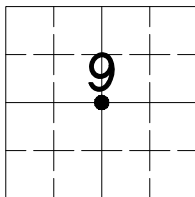

● = Location of Monument

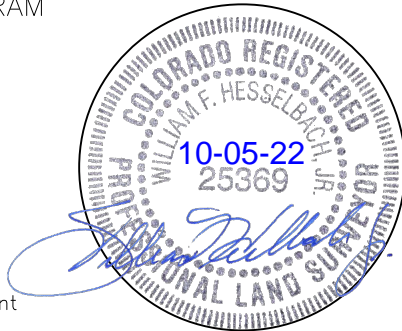

Signature/Date through Seal

7. SEC 9 T 4 S R 65 W, 6th P.M.
 COUNTY ARAPAHOE INDEX REF NUMBER 11-T

**8. SEC _____ T _____ R _____, _____ P.M.
 COUNTY _____ INDEX REF NUMBER _____

** To be used only for monuments located on county lines



Dora
 Department of Regulatory Agencies

Rev.05/23/2019

(Surveyor, do not fill in)

RECEIVED AT OFFICE OF THE COUNTY CLERK _____ COUNTY

BY: _____

DATE: _____

Record to be filed numerically by Index Reference Number, then alphabetically by letter in the index reference number, then under appropriate Township, Range, and Meridian.