



KINGS POINT FILING 1 OVERALL BOUNDARY

March 21, 2017

Prepared under the supervision of Stephen H. Harding, PLS 29040 for and on behalf of EMK Consultants, Inc.

POINT OF BEGINNING

North: 172826.97' East: 202233.13'

Segment #1: Line

Course: N89°34'42"E Length: 2631.52'

North: 172846.34' East: 204864.58'

Segment #2: Line

Course: N89°35'50"E Length: 2661.35'

North: 172865.05' East: 207525.86'

Segment #3: Line

Course: N89°36'13"E Length: 2127.50'

North: 172879.77' East: 209653.31'

Segment #4: Line

Course: N88°25'33"E Length: 25.03'

North: 172880.45' East: 209678.33'

Segment #5: Line

Course: S04°19'21"E Length: 136.69'

North: 172744.15' East: 209688.63'

Segment #6: Line

Course: S49°19'21"E Length: 51.19'

North: 172710.79' East: 209727.46'

Segment #7: Line

Course: S80°34'31"E Length: 189.48'

North: 172679.76' East: 209914.38'

Segment #8: Line

Course: S09°25'29"W Length: 42.20'

North: 172638.13' East: 209907.47'

Segment #9: Curve

Length: 215.95' Radius: 482.00'

Delta: 025°40'12" Tangent: 109.82'

Chord: 214.15' Course: S03°24'38"E

Course In: S80°34'31"E Course Out: S73°45'16"W

RP North: 172559.20' East: 210382.96'

End North: 172424.36' East: 209920.21'

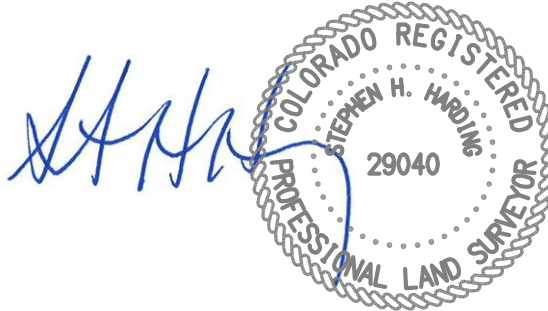

Segment #10: Line

Course: S16°14'44"E Length: 47.11'

North: 172379.13' East: 209933.39'

Segment #11: Line

Course: S21°49'40"W Length: 31.49'

North: 172349.90' East: 209921.68'

Segment #12: Curve

Length: 31.49' Radius: 537.00'

Delta: 003°21'35" Tangent: 15.75'

Chord: 31.49' Course: S57°09'25"W

Course In: S31°09'48"E Course Out: N34°31'23"W

RP North: 171890.39' East: 210199.57'

End North: 172332.82' East: 209895.22'

Segment #13: Line

Course: S55°28'37"W Length: 101.25'

North: 172275.44' East: 209811.80'

Segment #14: Curve

Length: 87.79' Radius: 463.00'

Delta: 010°51'49" Tangent: 44.03'

Chord: 87.66' Course: S60°54'32"W

Course In: N34°31'23"W Course Out: S23°39'34"E

RP North: 172656.90' East: 209549.40'

End North: 172232.82' East: 209735.20'

Segment #15: Line

Course: S66°20'26"W Length: 42.09'

North: 172215.92' East: 209696.65'

Segment #16: Line

Course: S23°46'59"E Length: 86.01'

North: 172137.22' East: 209731.34'

Segment #17: Line

Course: S59°17'39"E Length: 24.00'

North: 172124.96' East: 209751.97'

Segment #18: Line

Course: N74°28'49"E Length: 40.00'

North: 172135.67' East: 209790.51'

Segment #19: Line

Course: S16°19'10"E Length: 61.00'

North: 172077.12' East: 209807.65'

Segment #20: Line

Course: N72°31'43"E Length: 173.23'

North: 172129.13' East: 209972.89'

Segment #21: Line
Course: S58°56'08"E Length: 41.89'
North: 172107.52' East: 210008.77'

Segment #22: Line
Course: N80°40'12"E Length: 11.76'
North: 172109.42' East: 210020.38'

Segment #23: Line
Course: S62°06'45"E Length: 170.48'
North: 172029.68' East: 210171.06'

Segment #24: Line
Course: S00°04'38"W Length: 238.75'
North: 171790.93' East: 210170.74'

Segment #25: Curve
Length: 433.74' Radius: 2141.83'
Delta: 011°36'10" Tangent: 217.61'
Chord: 433.00' Course: S64°27'00"W
Course In: N31°21'05"W Course Out: S19°44'55"E
RP North: 173620.04' East: 209056.38'
End North: 171604.18' East: 209780.08'

Segment #26: Line
Course: S70°15'05"W Length: 95.13'
North: 171572.04' East: 209690.55'

Segment #27: Line
Course: S74°00'05"W Length: 1352.59'
North: 171199.25' East: 208390.34'

Segment #28: Line
Course: S71°45'05"W Length: 102.96'
North: 171167.00' East: 208292.56'

Segment #29: Curve
Length: 1832.46' Radius: 3969.72'
Delta: 026°26'54" Tangent: 932.85'
Chord: 1816.23' Course: S58°31'38"W
Course In: S18°14'55"E Course Out: N44°41'49"W
RP North: 167396.93' East: 209535.64'
End North: 170218.76' East: 206743.52'

Segment #30: Line
Course: S89°38'25"W Length: 1891.72'
North: 170206.89' East: 204851.84'

Segment #31: Line
Course: S89°35'36"W Length: 2636.79'
North: 170188.17' East: 202215.11'

Segment #32: Line
Course: S89°35'33"W Length: 465.26'
North: 170184.86' East: 201749.87'

Segment #33: Line
Course: N28°10'15"W Length: 1163.29'
North: 171210.35' East: 201200.67'

Segment #34: Line
Course: N31°58'54"W Length: 150.16'
North: 171337.72' East: 201121.14'

Segment #35: Line
Course: N28°04'39"W Length: 181.76'
North: 171498.09' East: 201035.59'

Segment #36: Line
Course: N89°31'11"E Length: 1188.66'
North: 171508.05' East: 202224.21'

Segment #37: Line
Course: N00°23'11"E Length: 1318.92'
North: 172826.94' East: 202233.11'

Perimeter: 22082.70' Area: 18655795 Sq. Ft.
Error Closure: 0.04 Course: S39°19'40"W
Error North: -0.027 East: -0.022
Precision 1: 551594.75