

KINGS POINT CONTEXTUAL SITE PLAN NO. 1
CONTEXTUAL SITE PLAN WITH WAIVER
A PART OF SECTIONS 33 AND 34, TOWNSHIP 5 SOUTH, RANGE 66 WEST OF THE 6TH P.M.
CITY OF AURORA, COUNTY OF ARAPAHOE, STATE OF COLORADO

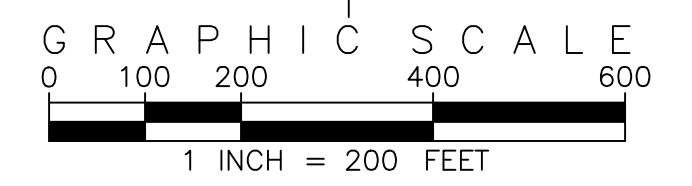
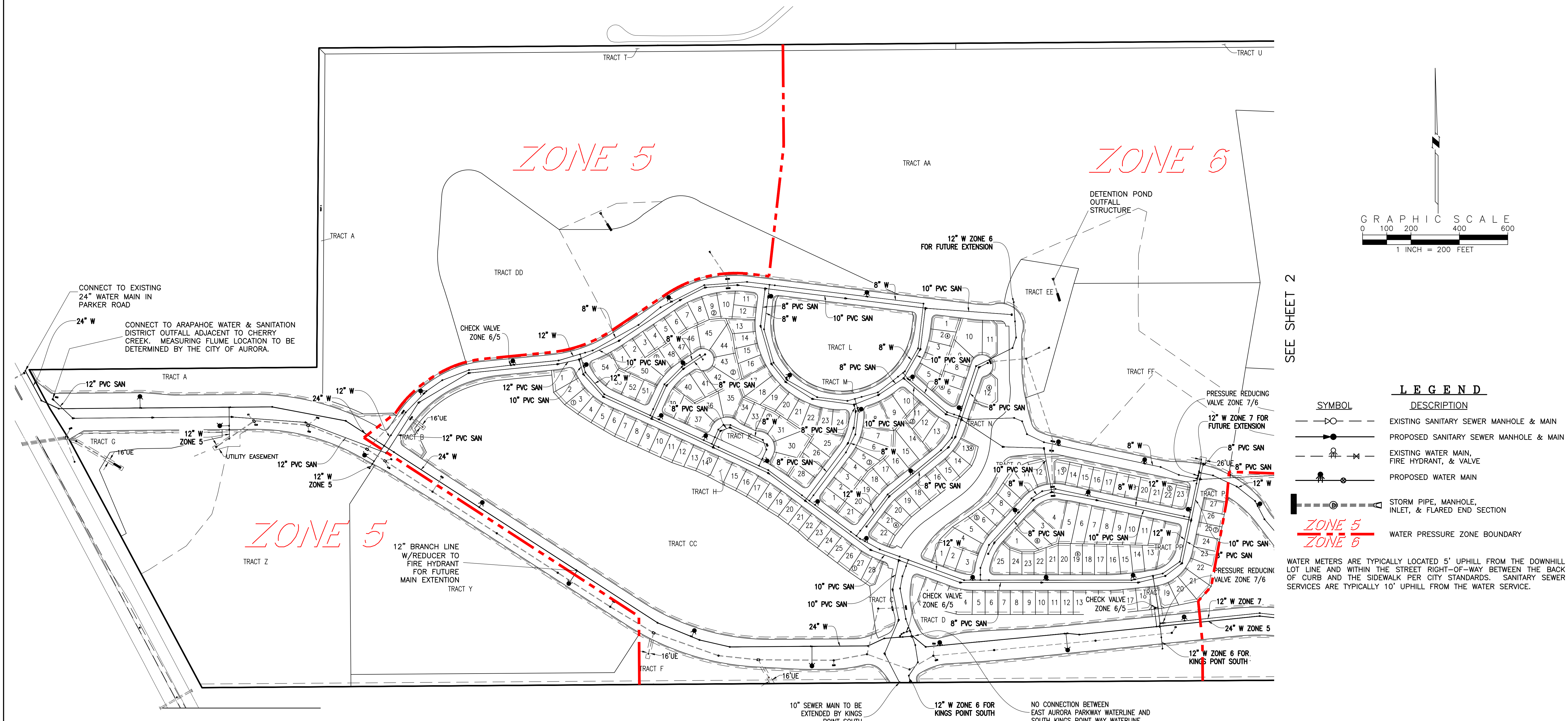
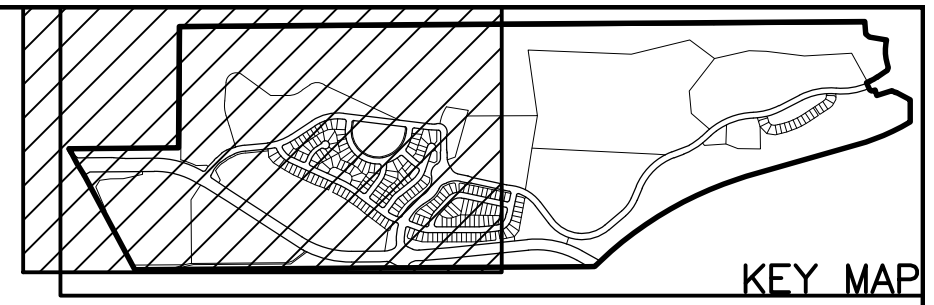

SEE SHEET 2

LEGEND

SYMBOL	DESCRIPTION
	EXISTING SANITARY SEWER MANHOLE & MAIN
	PROPOSED SANITARY SEWER MANHOLE & MAIN
	EXISTING WATER MAIN, FIRE HYDRANT, & VALVE
	PROPOSED WATER MAIN
	STORM PIPE, MANHOLE, INLET, & FLARED END SECTION
	WATER PRESSURE ZONE BOUNDARY

WATER METERS ARE TYPICALLY LOCATED 5' UPHILL FROM THE DOWNHILL LOT LINE AND WITHIN THE STREET RIGHT-OF-WAY BETWEEN THE BACK OF CURB AND THE SIDEWALK PER CITY STANDARDS. SANITARY SEWER SERVICES ARE TYPICALLY 10' UPHILL FROM THE WATER SERVICE.

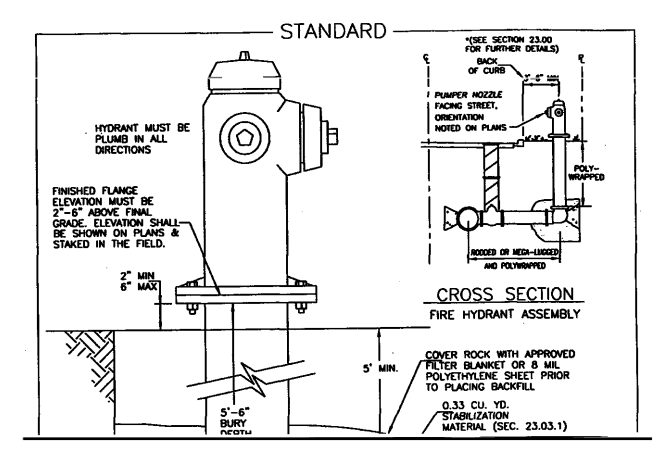

FIRE HYDRANT PLACEMENT DETAIL



EMK CONSULTANTS, INC.
ENGINEERING/SURVEYING
LAND DEVELOPMENT
SERVICES AND SOLUTIONS
7006 SOUTH ALTON WAY, BLDG. F
CENTENNIAL, COLORADO 80112-2019
(303)694-1520 www.EMKC.com

DEVELOPER
KINGSPPOINT LLC
c/o CASTLE ROCK DEVELOPMENT COMPANY
3033 E FIRST AVENUE, SUITE 410
DENVER, COLORADO 80206
PHONE: (303) 394-5525
CONTACT: BRUCE STOKES

PRELIMINARY SANITARY
SEWER AND WATERMAIN
PLAN-WEST
KINGS POINT FILING
NO. 1 CONTEXTUAL SITE PLAN
PREPARED: 03.14.17
REVISED: 06.15.17
SHEET 1 OF 2

EMK JOB No. 12187.17

KEY MAP

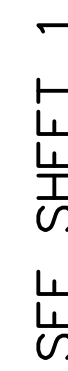

PRELIMINARY SANITARY
SEWER AND WATERMAIN
PLAN-EAST
KINGS POINT FILING
NO. 1 CONTEXTUAL SITE PLAN
PREPARED: 03.14.17
REVISED: 06.15.17