

1x1 STEEL MESH

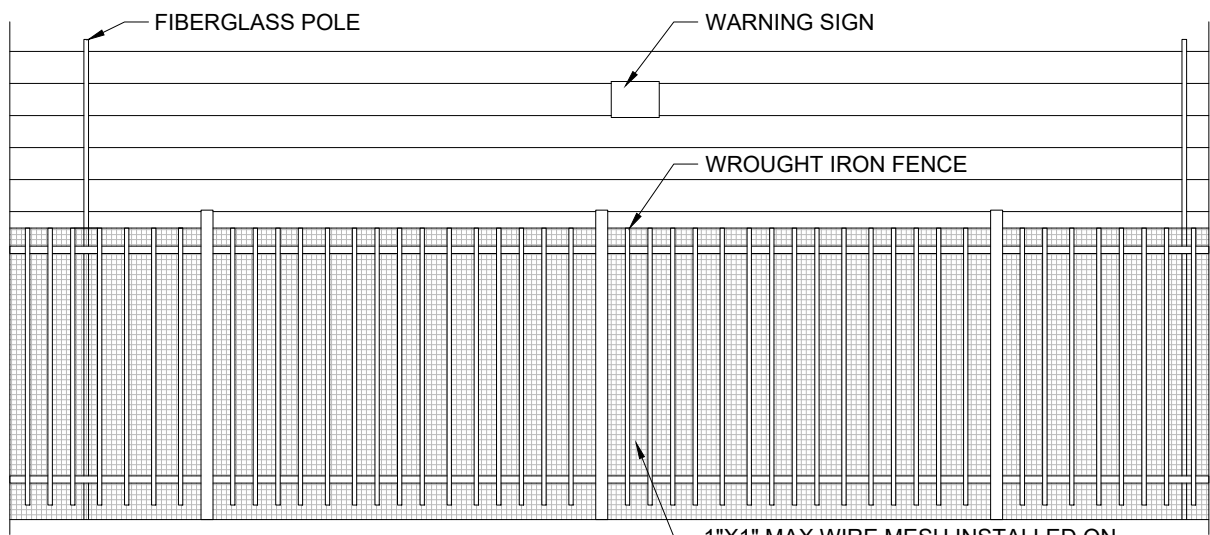

WROUGHT IRON FENCE ELEVATION - NTS
4" OPENINGS BETWEEN RODS - ADD MESH TO DECREASE OPENING TO 1" MAX

PROPERTY OWNER
SFG AURORA CO LLC
3280 PEACHTREE RD NE STE 2770
ATLANTA, GA 30305

PROJECT DATA
APN: R0212551
ZONING: AD - AIRPORT DISTRICT
ACRES: 65.53

SITE PLAN
REQUEST TO AUTHORIZE A
SECURITY FENCE FOR:
FEDEX GROUND
5805 N JACKSON GAP ST
AURORA, CO 80019

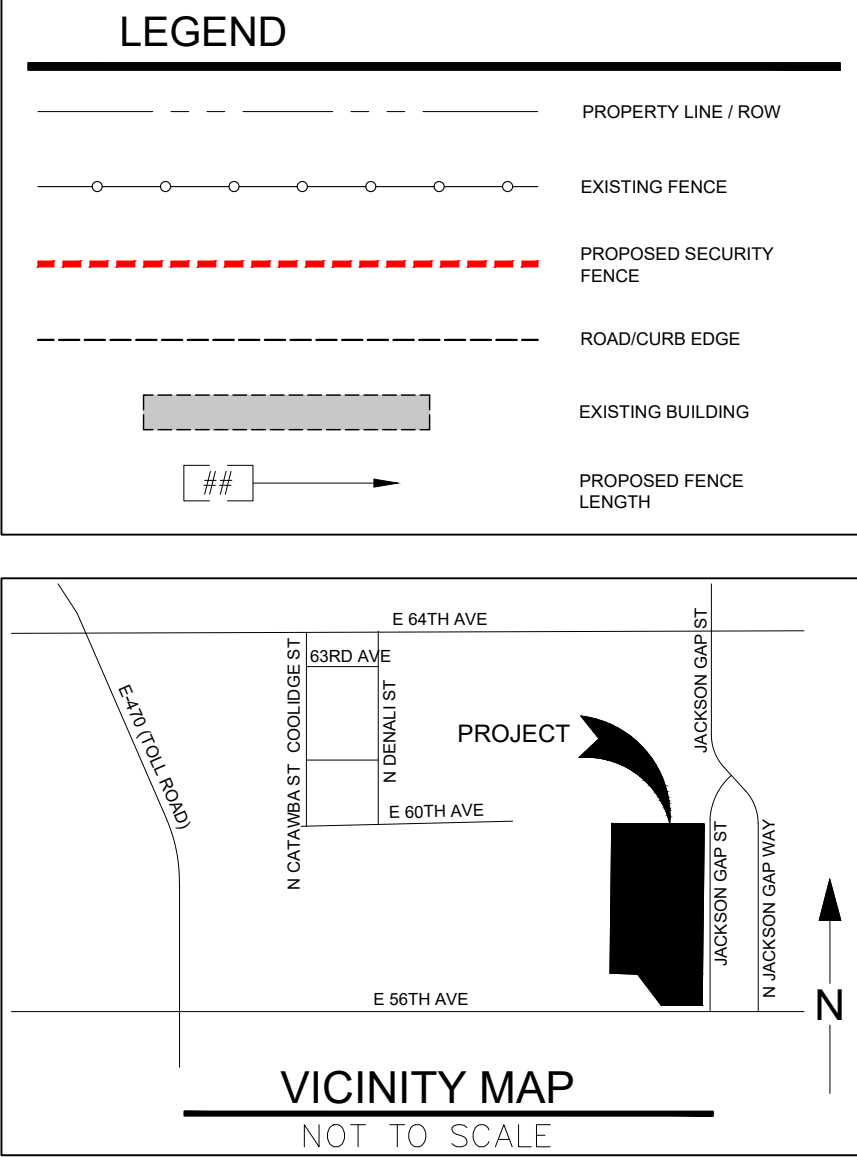

#	DATE / DESCRIPTION



NOTES

POLE LOCATIONS:
STEEL POLES: TO BE LOCATED APPROXIMATELY ON EACH SIDE OF GATE(S) & EVERY 90° (OR GREATER) TURN IN FENCE LINE.
FIBERGLASS/INTERMEDIATE POLES: TO BE LOCATED APPROXIMATELY EVERY 30'

DISCLAIMER:
POLE LOCATIONS MAY SLIGHTLY DEVIATE FROM STIPULATIONS ABOVE DUE TO ON-SITE CONDITIONS

STORM DRAIN:
NO STORM DRAIN IS BEING PROPOSED AS PART OF THIS PROJECT

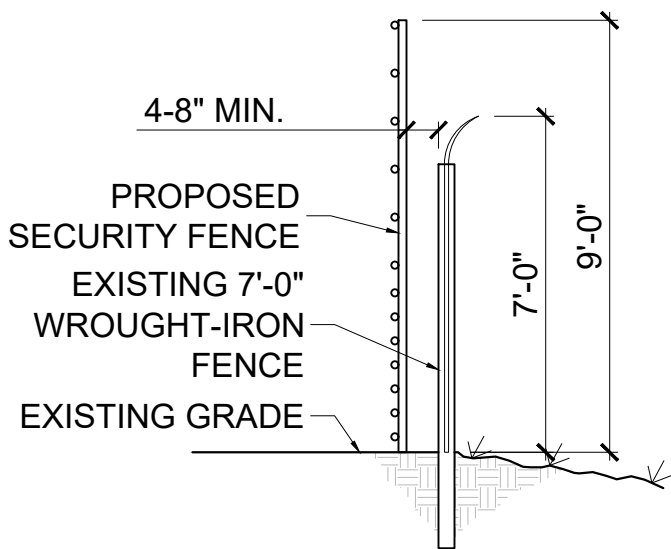

1 C1 PERIMETER FENCE SECTION
NTS

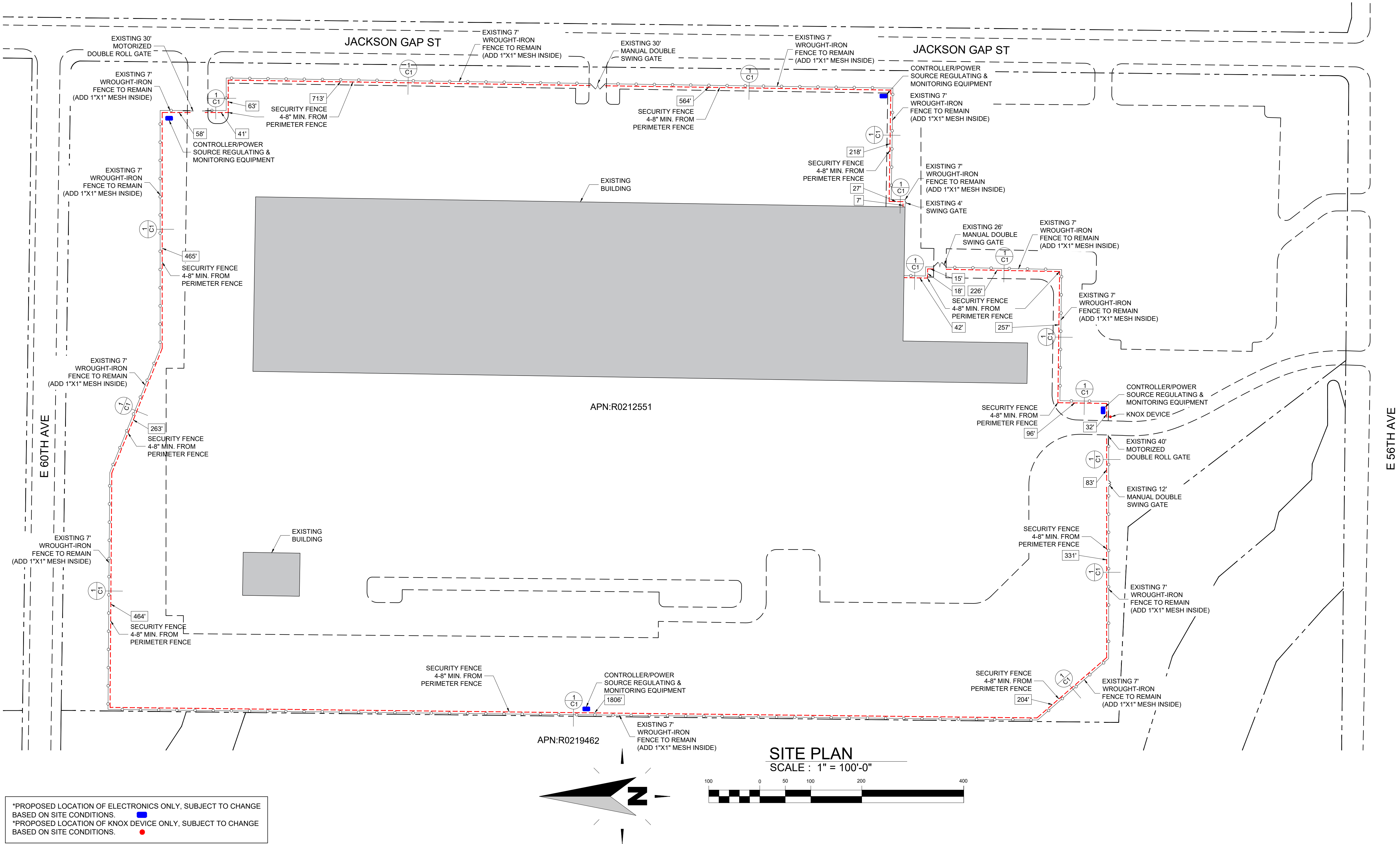

*PROPOSED LOCATION OF ELECTRONICS ONLY, SUBJECT TO CHANGE BASED ON SITE CONDITIONS.
*PROPOSED LOCATION OF KNOX DEVICE ONLY, SUBJECT TO CHANGE BASED ON SITE CONDITIONS.

PROJECT:
FEDEX GROUND
5805 N JACKSON GAP ST
AURORA, CO 80019

SHEET TITLE: SITE PLAN

APPLICANT: AMAROK
550 ASSEMBLY ST 5TH FL
COLUMBIA SC 29201
803-404-6189

DATE: 10/17/2024
DRAWN BY: RLR
SCALE: SEE PLAN

SHEET
C1
of 3

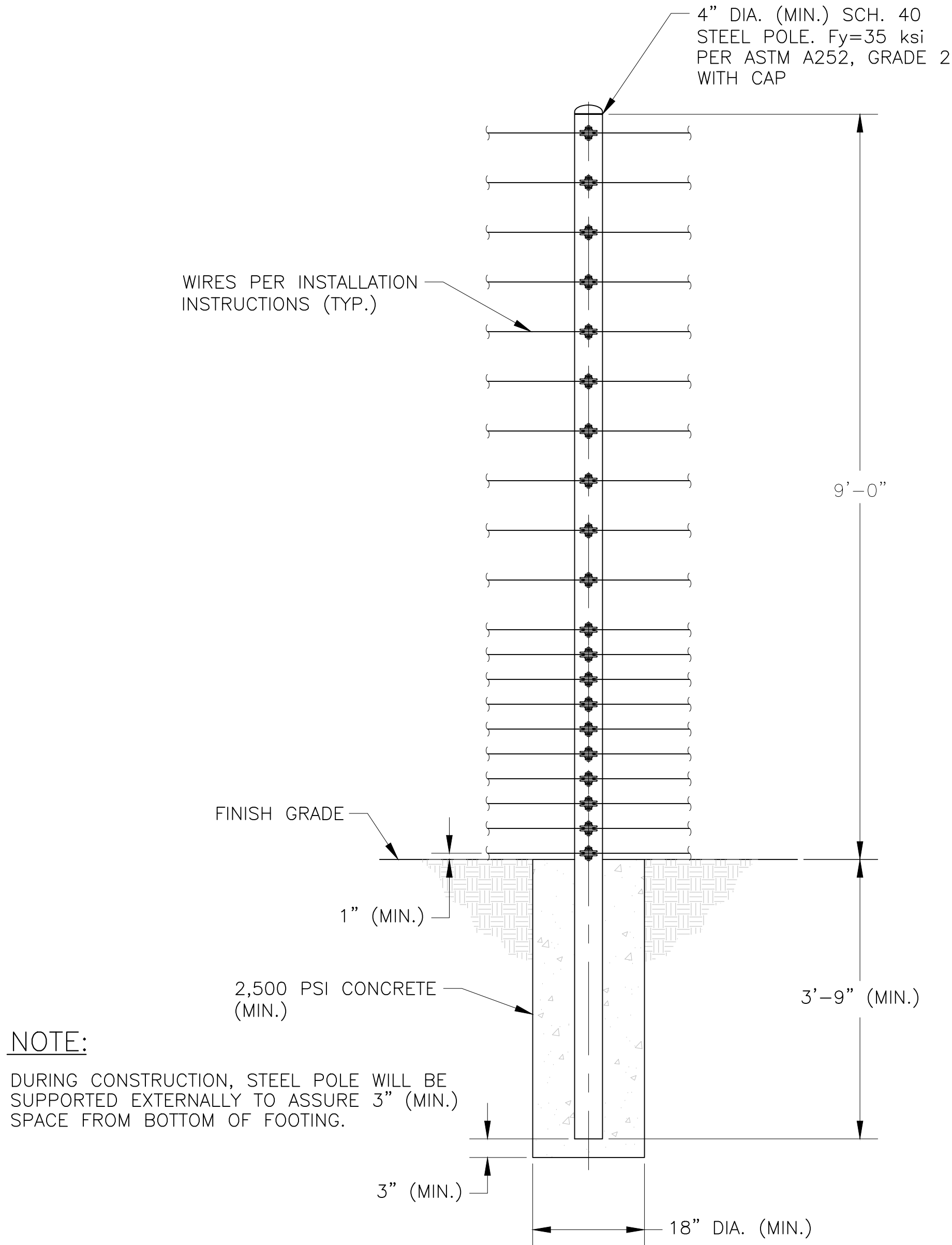

STEEL POLE DETAIL

SCALE: NONE
(STRUCTURAL)



WARNING SIGNS SHALL BE PLACED AT EACH ENTRANCE OF THE PROPERTY AND MAX 30 FEET ON CENTER THEREAFTER

EXAMPLE WARNING SIGN @ 9"x12"

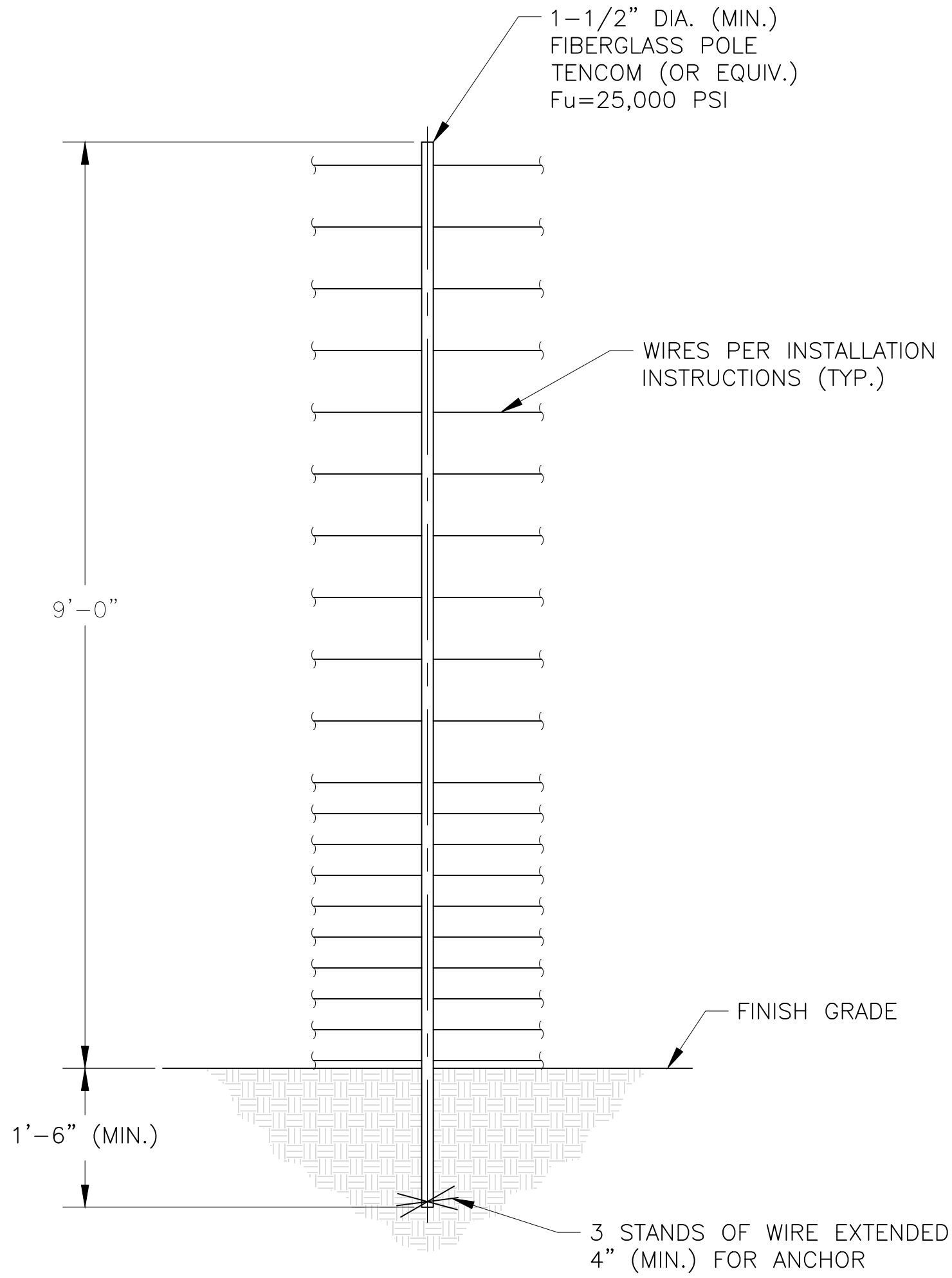

FIBERGLASS POLE DETAIL

SCALE: NONE
(NON-STRUCTURAL, NON-LOAD BEARING WIRE SEPARATOR)

GATE DETAIL NOTES:

- BRACE BANDS ARE INSTALLED AS HIGH AS POSSIBLE UNDER #3 AND #9, 2" (MIN.) UNDER #12, #15, AND #17, UNDER #19 AND AS HIGH ON THE GATE AS POSSIBLE. MAXIMUM DISTANCE OF 2' BETWEEN BRACE BANDS.
- SPRINGS ARE LOCATED ON HINGE SIDE OF SWING GATE AND REAR OF SLIDE GATE.
- ALL CONTACTS MUST INCLUDE SPRINGS.
- ALL CONTACTS MUST HAVE BOLT THROUGH FIBERGLASS (NO SET SCREWS).
- ALL BRACE BANDS HOOKED TO CHAIN LINK MUST HAVE SET SCREW.
- EVERY GATE PANEL MUST HAVE A SIGN.
- ALL GATE CONTACTS MUST BE SECURE IN A MANNER THAT ENSURES CONTACT WILL EASILY BE MADE.
- GATE MOUNTS WILL NOT IMPACT THE FUNCTIONALITY OF THE GATE.

RAPID TIGHTENERS

RAPID TIGHTENERS ARE INSTALLED IN EVERY SECTION - BETWEEN 6" INCHES AND 3 FEET FROM A FIBERGLASS POLE - TOWARD THE CENTER OF THE RUN.

THE TIGHTENERS ARE ALTERNATED ON OPPOSITE SIDES OF THE POLE TO PREVENT GROUNDS FROM HITTING WIRES WITH CURRENT.

WIRE SHOULD BE WRAPPED TWO OR THREE TIMES AROUND EACH TIGHTENER.

WARNING SIGNS

WARNING SIGNS MUST BE INSTALLED EVERY 30 FEET, WHICH IS THE MAXIMUM DISTANCE BETWEEN SIGNS.

ALL WARNING SIGNS SHOULD BE MOUNTED EITHER BETWEEN WIRES 15 & 16 OR AT BEST VISIBLE HEIGHT.

IF INSTALLED BEHIND A SOLID FENCE, WARNING SIGNS SHOULD ALSO BE PLACED ON OR ABOVE THE PERIMETER FENCE.

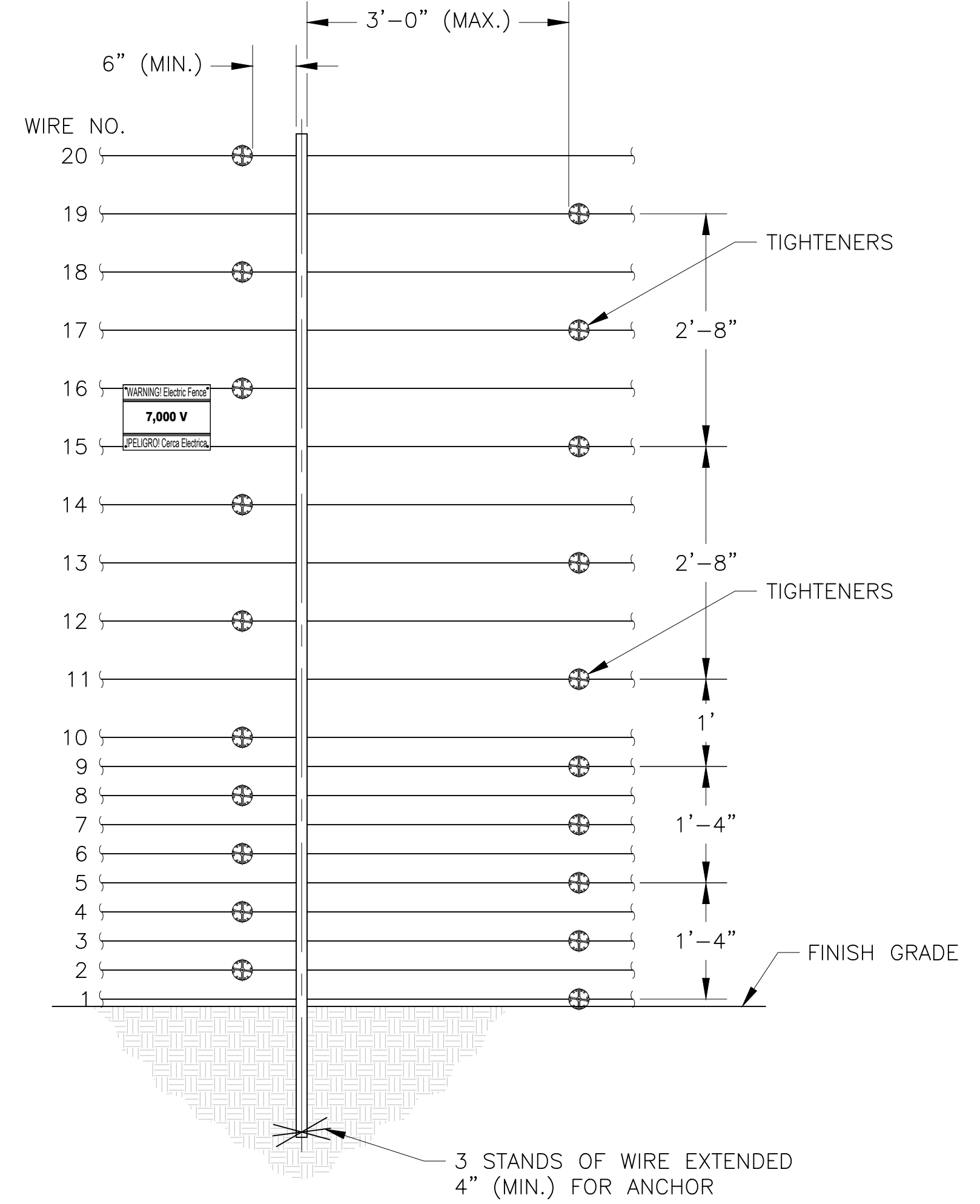

WIRE CONNECTIONS

SCALE: NONE
(FIBERGLASS POLE)

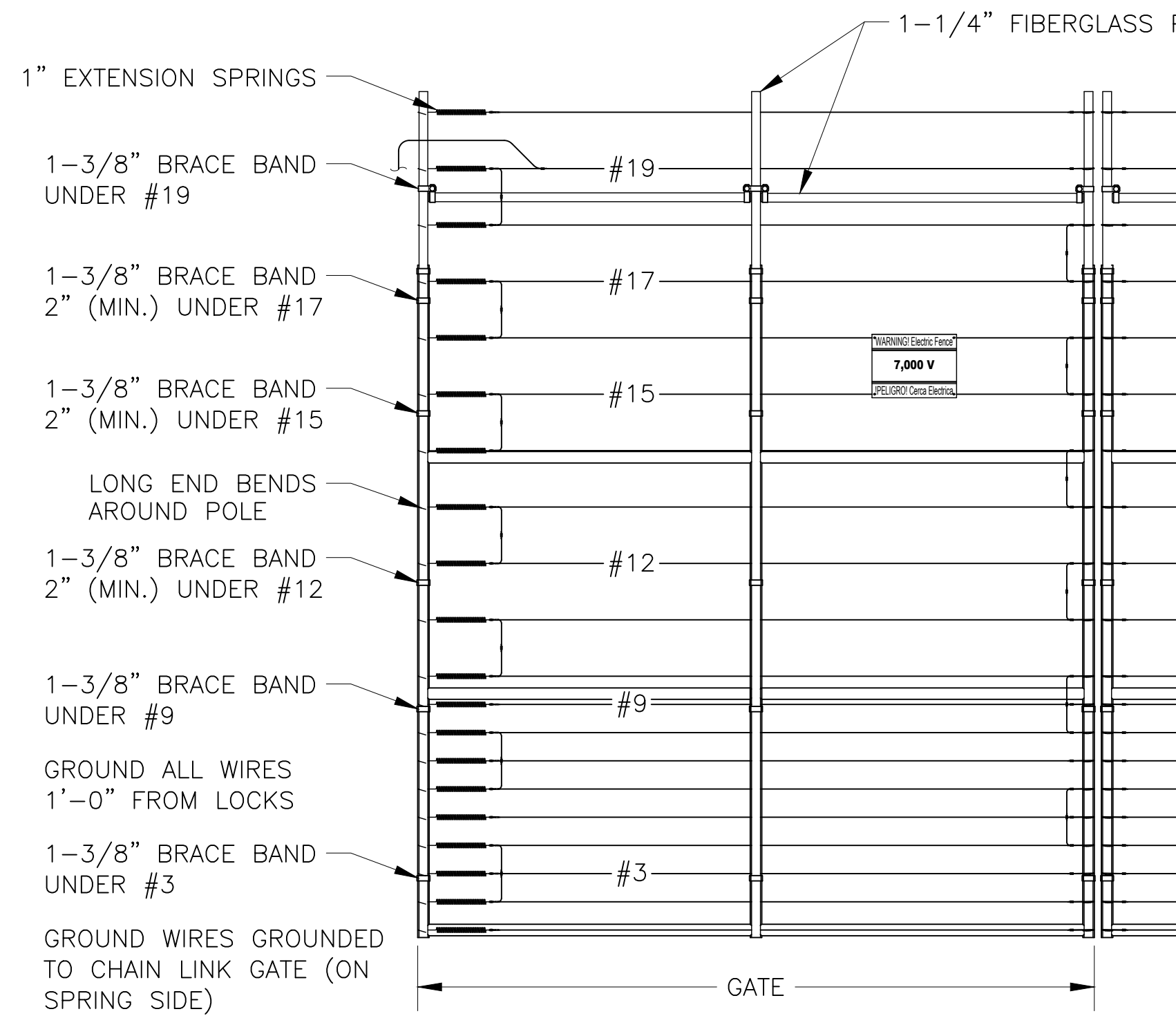

DOUBLE PANEL GATE

GATE DETAIL

SCALE: NONE

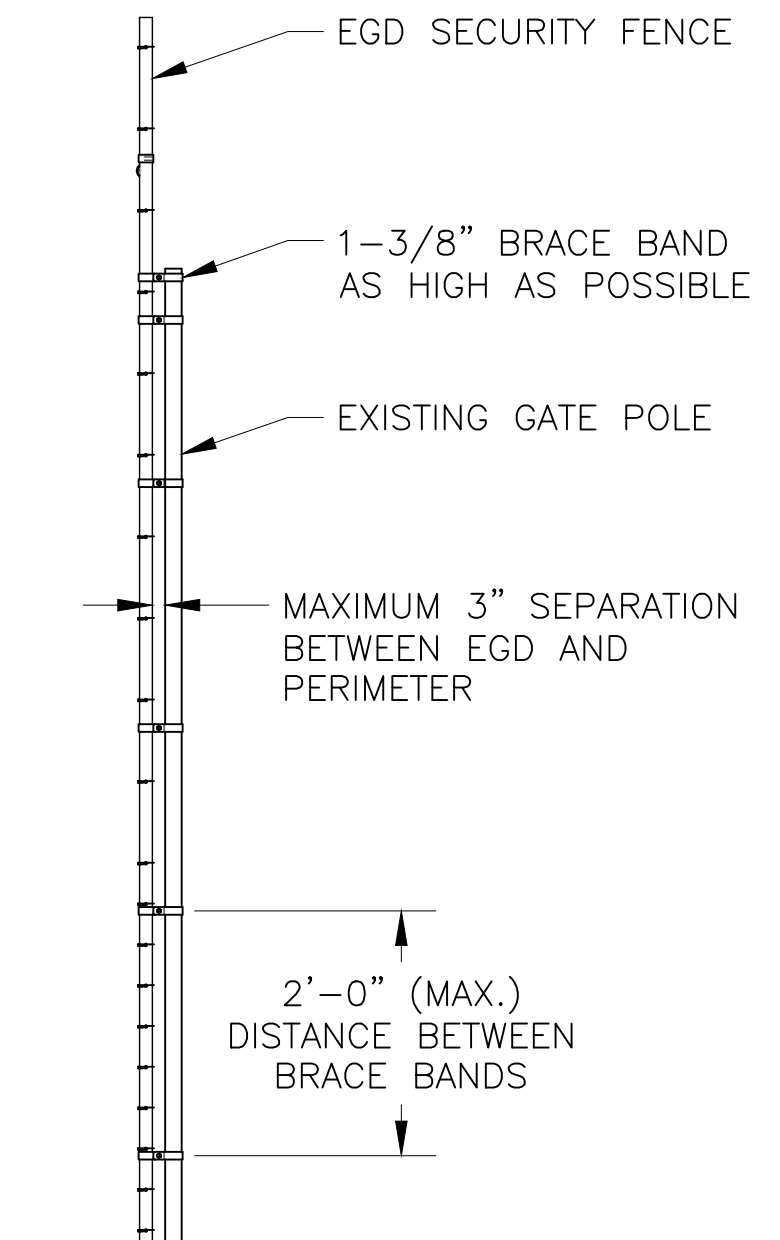

SIDE VIEW



PROJECT:

SHEET TITLE: TYPICAL DETAILS

APPLICANT: AMAROK
550 ASSEMBLY ST 5TH FL
COLUMBIA SC 29201
803-404-6189

DATE:
DRAWN BY:
SCALE: SEE PLAN

SHEET

C2

WIRE RUN DETAILS & OUTSIDE MOUNTED ELECTRONICS/CONTROLLER WITH STEEL POLE DETAIL

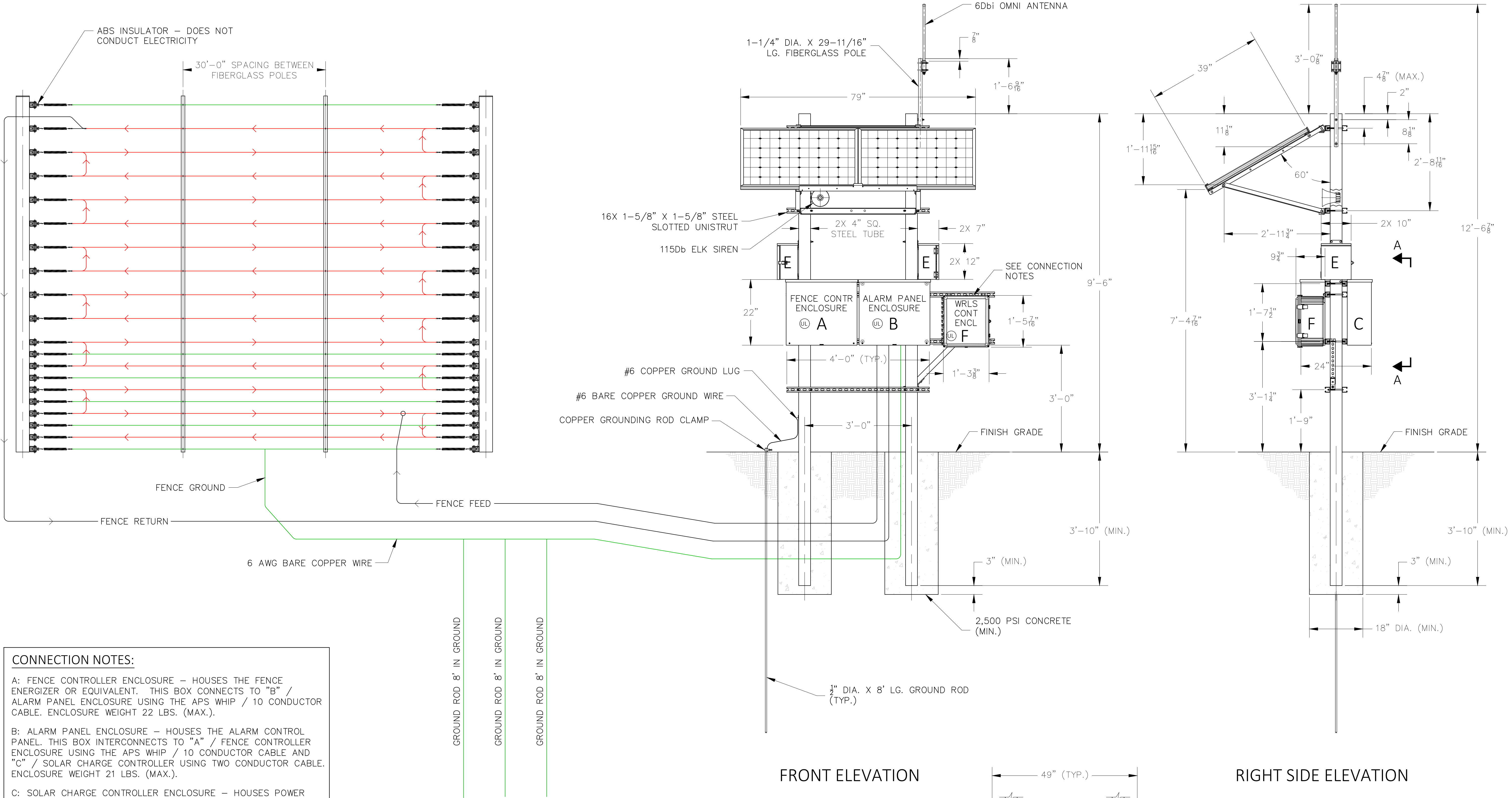

CONNECTION NOTES:

- A: FENCE CONTROLLER ENCLOSURE — HOUSES THE FENCE ENERGIZER OR EQUIVALENT. THIS BOX CONNECTS TO "B" / ALARM PANEL ENCLOSURE USING THE APS WHIP / 10 CONDUCTOR CABLE. ENCLOSURE WEIGHT 22 LBS. (MAX.).
- B: ALARM PANEL ENCLOSURE — HOUSES THE ALARM CONTROL PANEL. THIS BOX INTERCONNECTS TO "A" / FENCE CONTROLLER ENCLOSURE USING THE APS WHIP / 10 CONDUCTOR CABLE AND "C" / SOLAR CHARGE CONTROLLER USING TWO CONDUCTOR CABLE. ENCLOSURE WEIGHT 21 LBS. (MAX.).
- C: SOLAR CHARGE CONTROLLER ENCLOSURE — HOUSES POWER ELEMENTS FOR SOLAR CHARGE CONTROLLER AND DISCONNECTS FOR SOLAR, BATTERY, AND LOAD CONNECTIONS. POWER UP PROCEDURE: TURN ON BATTERY BREAKER FIRST, THEN TURN ON SOLAR BREAKER. THE ELECTRONICS POWER IS CONTROLLED BY BY THE LOAD BREAKER. ENCLOSURE WEIGHT 25 LBS. (MAX.).
- D: BATTERY ENCLOSURE — HOUSES THE BATTERIES (12V/DC MAX) AND INTER- CONNECTS TO "C" / SOLAR CHARGE CONTROLLER ENCLOSURE USING TWO CONDUCTOR 14G AND 10G THWN WIRES. ENCLOSURE WEIGHT 50 LBS. (MAX.).
- E: KEYPAD ENCLOSURE — HOUSES THE KEYPAD. THIS BOX INTERCONNECTS TO "A" USING 10 CONDUCTOR / 18 AWG WIRE. ENCLOSURE WEIGHT 12 LBS. (MAX.).
- F: WIRELESS CONTROLLER ENCLOSURE — HOUSES THE WIRELESS RADIO CONTROLLER AND RELAYS. CONNECTS TO "C" / SOLAR CHARGE CONTROLLER ENCLOSURE USING TWO CONDUCTOR 14G THWN WIRES. ENCLOSURE WEIGHT 21 LBS. (MAX.).

GENERAL NOTE:

EQUIPMENT ARRANGEMENT AND ELEVATION SHOWN ARE FOR REFERENCE ONLY. ACTUAL EQUIPMENT ARRANGEMENT, SHAPE, SIZE, LOCATION, AND QUANTITY ARE CUSTOMER SITE SPECIFIC AND CAN VARY FROM DRAWING DEPICTION.

NOTES:

MOUNT 4 SILVER BOXES TO A PAIR OF HSS TUBE 4"x4"x10GA. (0.134" WALL THICKNESS) ASTM A500 GRADE B OR C 55KSI YIELD (MIN.) STEEL POLES. BOTTOM OF THE LOWEST BOX MUST BE A MINIMUM OF 3 FEET ABOVE GROUND LEVEL. THE SUPPORT POLES MUST BE EMBEDDED AT A MINIMUM OF 3'-10" BELOW GROUND LEVEL.

FRONT ELEVATION

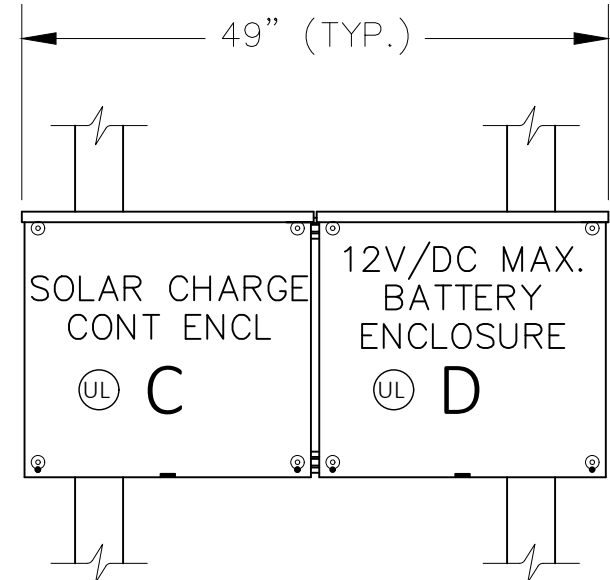

VIEW A-A
(KEYPAD ENCLOSURES REMOVED FOR CLARITY)

RIGHT SIDE ELEVATION

ASSEMBLY WEIGHT CHART	
DESCRIPTION	WEIGHT (LBS.)
SOLAR PANELS	61.6
SOLAR PANEL MTG. KIT	27.0
UNISTRUT	108.8
OMNI ANTENNA ASSEMBLY	3.59
SIREN	1.5

ELECTRONICS ARMATURE	
LOCATION	DESCRIPTIVE NAME
MAIN GATE	HEAD-END ELECTRONICS

#	DATE / DESCRIPTION



PROJECT:	SHEET TITLE: TYPICAL DETAILS
----------	------------------------------

APPLICANT: AMAROK
550 ASSEMBLY ST 5TH FL
COLUMBIA SC 29201
803-404-6189

DATE:
DRAWN BY:
SCALE: SEE PLAN

SHEET
C3