

WB-67 - Interstate Semi-Trailer
Overall Length 73.501ft
Overall Width 8.500ft
Overall Body Height 13.500ft
Min Body Ground Clearance 1.334ft
Max Track Width 8.500ft
Lock-to-lock time 8.00s
Max Steering Angle (Virtual) 28.40°

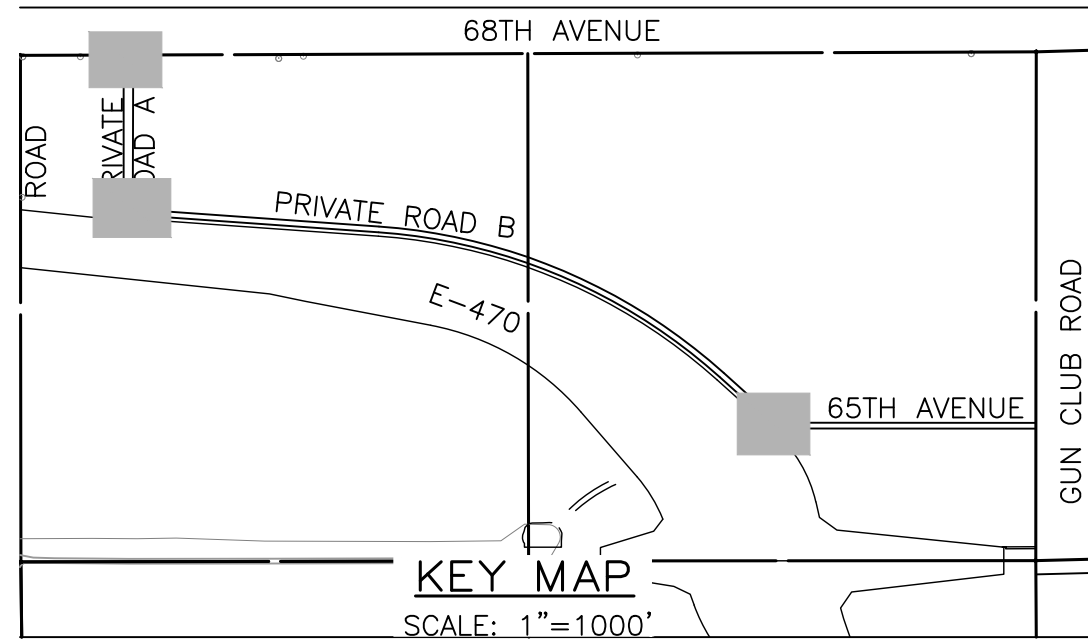

KEYMAP
SCALE 1"=1000'

68TH AVENUE LOOP

WB-67 AUTOTURN

EXHIBIT

No.	Issue / Revision	Date	Name
1	AUTOTURN WB-67 EXHIBIT	06/16/25	M/W

Job Number 19.1043	Project Manager G. PROULX
Design By DBEJARANO	Drawn By DBEJARANO
Principal In Charge DLE	

Sheet Number:

1