

COLORADO LAND SURVEY MONUMENT RECORD

Department of Regulatory Agencies
Board of Registration for Professional Engineers and Professional Land Surveyors
1560 Broadway, Suite 1370, Denver, CO 80202
Phone (303)894-7788 Fax (303)894-7790 V/TDD (303)894-7780

DECEMBER

DEC 01 1995

COLO. ST. BD. OF REG.
FOR PE AND PLS

REPORT ONE MONUMENT ONLY ON THIS FORM - REPRODUCTION OF THIS FORM IS AUTHORIZED
All items to be filled in by the Land Surveyor using PERMANENT BLACK LETTERING and lines which can be reproduced

1. TYPE OF MONUMENT: ☐ SECTION CORNER ☒ QUARTER CORNER ☐ BENCH MARK ☐ OTHER _____

2. DESCRIPTION OF MONUMENT FOUND:

FOUND A #3 REBAR BENT OVER TO WEST, 0.2' BELOW SURFACE.

3. DESCRIPTION OF MONUMENT ESTABLISHED BY YOU TO PERPETUATE THE LOCATION OF THIS POINT:

REPLACED THE EXISTING MONUMENT WITH A #6 REBAR 30" LONG, WITH A 2" DIA. ALUMINUM CAP, 0.6' BELOW SURFACE.

4. SKETCH SHOWING RELATIVE LOCATION OF MONUMENT, ACCESSORIES AND REFERENCE POINTS STATING WHETHER FOUND OR SET, SHOW SUPPORTING AND/OR CONTRADICTORY EVIDENCE WHERE APPLICABLE:

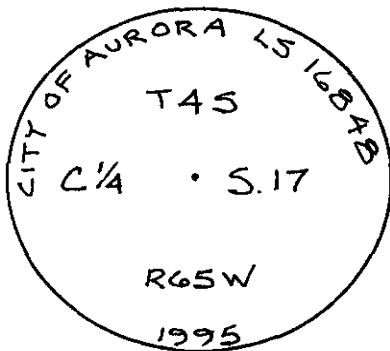
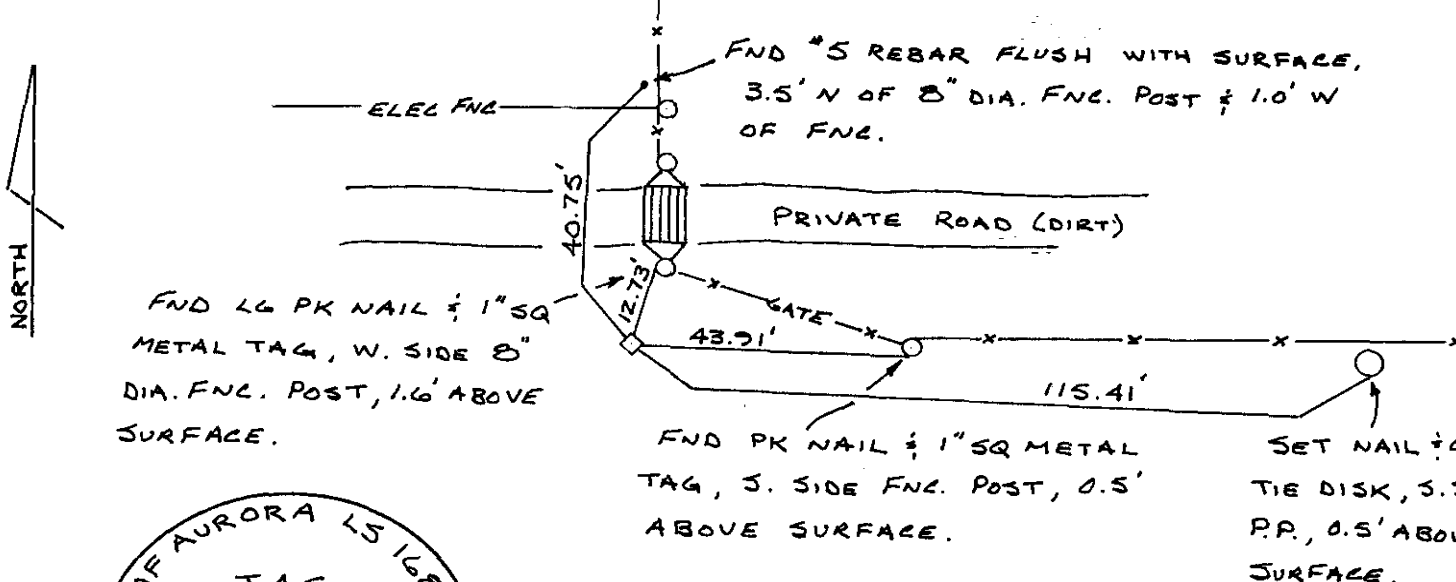

Stamping on Cap

Date of Field Work 10-31-95

(Do not fill in)

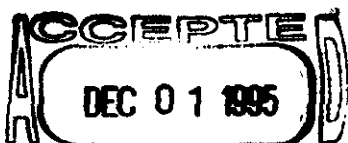

COLO. ST. BD. OF REG.
FOR PE AND PLS

RECEIVED AT OFFICE OF THE COUNTY CLERK
_____ COUNTY

BY: _____

DATE: _____

5. CERTIFICATION

This is to certify that I was in responsible charge of the surveying work described in this record and that to the best of my knowledge the information presented herein is true and correct.

Name (Please Print): STEVEN L. WEMLINGER

Firm Name: CITY OF AURORA

Firm Address: 13645 E. ELLSWORTH AVE.

Phone: 303-341-7237

6. LOCATION DIAGRAM

1" = 1 Mile

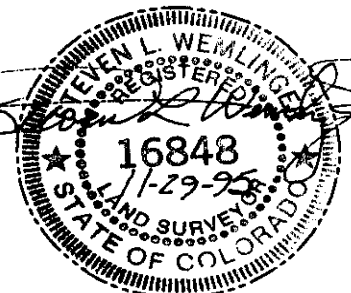
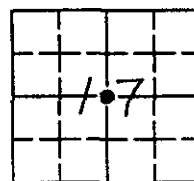

● = Location of Monument Signature/Date through Seal

7. SEC 17 T 45 R 65W 6TH P.M.
COUNTY ARAPAHOE INDEX REF NUMBER 7-P

**8. SEC _____ T _____ R _____ P.M.

COUNTY _____ INDEX REF NUMBER _____

COLORADO LAND SURVEY MONUMENT RECORD

Department of Regulatory Agencies
Board of Licensure for Architects, Professional Engineers and Professional Land Surveyors
1560 Broadway, Suite 1350
Denver, CO 80202
Phone (303) 894-7800; Fax (303) 894-2310; EMAIL aes@dora.state.co.us

NOV 13 2017

OLD. 67.00. 01.11.11

Report one monument only on this form - Reproduction of this form is authorized.
All items are to be filled in by the Land Surveyor using **PERMANENT BLACK LETTERING** and lines which can be reproduced.

1. TYPE OF MONUMENT: ☐ SECTION CORNER ☒ QUARTER CORNER ☐ SIXTEENTH CORNER ☐ OTHER _____

2. DESCRIPTION AND DATE OF MONUMENT FOUND:

3" Brass Cap in Range Box dated 1993

3. DESCRIPTION OF MONUMENT SET BY YOU TO PERPETUATE THE LOCATION OF THIS POINT:

4. SKETCH SHOWING RELATIVE LOCATION OF MONUMENT, ACCESSORIES AND REFERENCE POINTS STATING WHETHER FOUND OR SET, SHOW SUPPORTING AND/OR CONTRADICTORY EVIDENCE WHERE APPLICABLE:

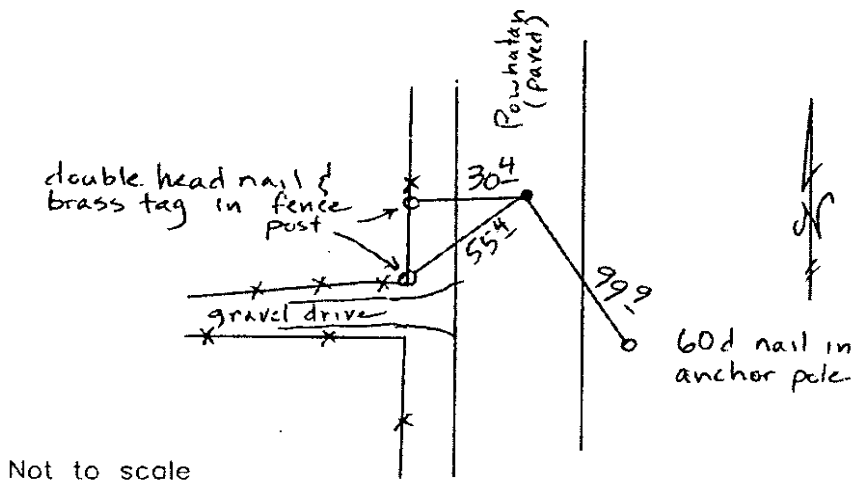

Not to scale

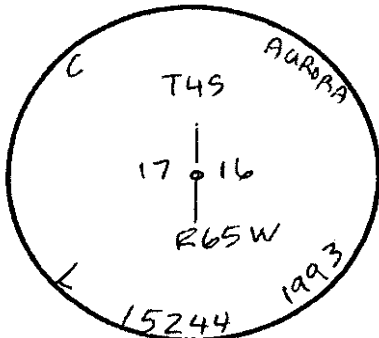

Stamping on Cap

a. Date of field Work to Establish, Restore or Rehabilitate Monument: _____

b. Date Monument was used as a Control corner: 10-10-17

(Surveyor, do not fill in)

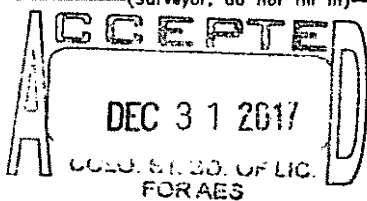

RECEIVED AT OFFICE OF THE COUNTY CLERK
_____ COUNTY

BY: _____

DATE: _____

Record to be filed numerically by Index Reference Number, then alphabetically by letter in the index reference number, then under appropriate Township.

5. CERTIFICATION

This is to certify that I was in responsible charge of the surveying work described in this record and that to the best of my knowledge the information presented herein is true and correct.

Name (Please Print): Thomas G Carlson

Firm Name: Encompass Energy Services

Firm Address: 350 Interlocken Blvd., # 350

Broomfield, CO 80021

Phone: (303) 955-6080

6. LOCATION DIAGRAM

1" = 1 Mile

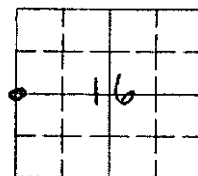

● = Location of Monument



Signature/Date through Seal

7. SEC 16 T 4S R 65W, 6th P.M.
COUNTY Arapahoe INDEX REF NUMBER 9P

**8. SEC _____ T _____ R _____ P.M.
COUNTY _____ INDEX REF NUMBER _____

** To be used only for monuments located on county lines



Dora

COLORADO LAND SURVEY MONUMENT RECORD

Department of Regulatory Agencies
Board of Licensure for Architects, Professional Engineers and Professional Land Surveyors
1560 Broadway, Suite 1350
Denver, CO 80202
Phone (303) 894-7800; Fax (303) 894-2310; EMAIL aes@dora.state.co.us; V/TDD 711
NOV 13 2017
COLO. ST. BD. OF LIC.

Report one monument only on this form - Reproduction of this form is authorized FOR AES
All items are to be filled in by the Land Surveyor using **PERMANENT BLACK LETTERING** and lines which can be reproduced.

1. TYPE OF MONUMENT: ☒ SECTION CORNER ☐ QUARTER CORNER ☐ SIXTEENTH CORNER ☐ OTHER _____

2. DESCRIPTION AND DATE OF MONUMENT FOUND:

3/4" Aluminum Cap in Range Box dated 2011

3. DESCRIPTION OF MONUMENT SET BY YOU TO PERPETUATE THE LOCATION OF THIS POINT:

4. SKETCH SHOWING RELATIVE LOCATION OF MONUMENT, ACCESSORIES AND REFERENCE POINTS STATING WHETHER FOUND OR SET, SHOW SUPPORTING AND/OR CONTRADICTORY EVIDENCE WHERE APPLICABLE:

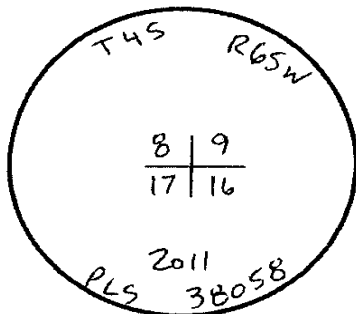
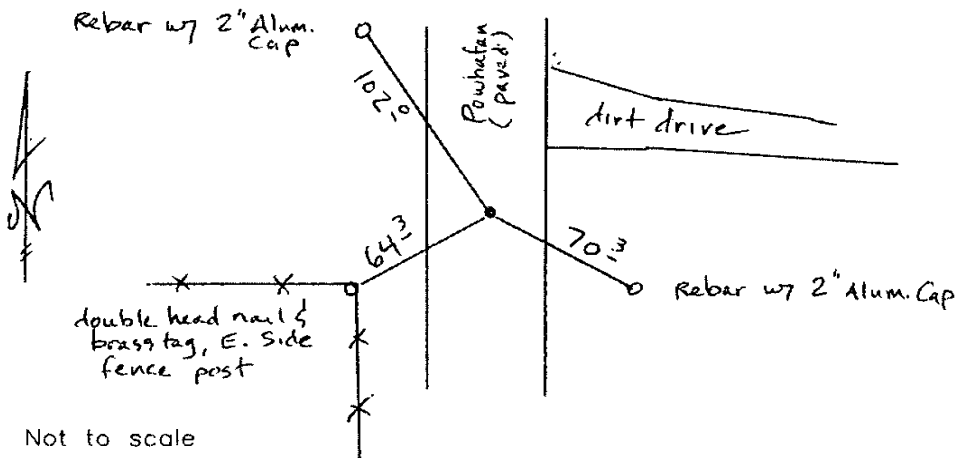

Stamping on Cap

a. Date of field Work to Establish, Restore or Rehabilitate Monument: _____

b. Date Monument was used as a Control corner: 10-10-17

(Surveyor, do not fill in)

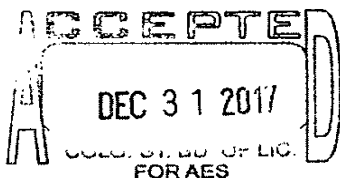

RECEIVED AT OFFICE OF THE COUNTY CLERK
_____ COUNTY

BY: _____

DATE: _____

Record to be filed numerically by Index Reference Number, then alphabetically by letter in the index reference number, then under appropriate Township, Range, and Meridian.

5. CERTIFICATION

This is to certify that I was in responsible charge of the surveying work described in this record and that to the best of my knowledge the information presented herein is true and correct.

Name (Please Print): Thomas G Carlson

Firm Name: Encompass Energy Services

Firm Address: 350 Interlocken Blvd., # 350
Broomfield, CO 80021

Phone: (303) 955-6080

6. LOCATION DIAGRAM

1" = 1 Mile

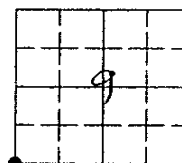

● = Location of Monument



Signature/Date through Seal

7. SEC 9 T 4S R 65W 6th P.M.
COUNTY Arapahoe INDEX REF NUMBER 9R

**8. SEC _____ T _____ R _____ P.M.
COUNTY _____ INDEX REF NUMBER _____

** To be used only for monuments located on county lines



Dora
Department of Regulatory Agencies

Rev.02/01/2011

COLO. ST. BD. OF LIC.



Dora