

COLORADO LAND SURVEY MONUMENT RECORD

Department of Regulatory Agencies

Board of Licensure for Architects, Professional Engineers and Professional Land Surveyors
1560 Broadway, Suite 1350

Denver, CO 80202

Phone (303) 894-7800; Fax (303) 894-2310; EMAIL aes@dora.state.co.us; V/TDD 711

RECEIVED

OCT 14 2022

Report one monument only on this form - Reproduction of this form is authorized.
All items are to be filled in by the Land Surveyor using PERMANENT BLACK LETTERING and lines which can be reproduced. State Bd of ARC, PE & PLS

1. TYPE OF MONUMENT: ☐ SECTION CORNER ☒ QUARTER CORNER ☐ SIXTEENTH CORNER ☐ OTHER _____

2. DESCRIPTION AND DATE OF MONUMENT FOUND:

MONUMENT AND ACCESSORIES SET BY PLS 25369 OF CVL CONSULTANTS OF COLORADO AND BEING A 3-1/4 INCH ALUMINUM CAP SET FLUSH WITH GROUND WERE DESTROYED BY CONSTRUCTION OPERATIONS. THE POSITION OF THIS MONUMENT WAS RE-ESTABLISHED TO THE ORIGINAL POSITION FROM COMPANY FIELD NOTES AND RECORDS.

3. DESCRIPTION OF MONUMENT SET BY YOU TO PERPETUATE THE LOCATION OF THIS POINT:

SET A NO. 6 REBAR WITH A 3-1/4 INCH DIAMETER ALUMINUM CAP FLUSH WITH GROUND MARKED AS SHOWN BELOW AT THE LOCATION OF THE PREVIOUSLY LOCATED MONUMENT ALONG WITH NEW ACCESSORY POINTS AS SHOWN BELOW ON SEPTEMBER 26, 2022.

4. SKETCH SHOWING RELATIVE LOCATION OF MONUMENT, ACCESSORIES AND REFERENCE POINTS STATING WHETHER FOUND OR SET, SHOW SUPPORTING AND/OR CONTRADICTORY EVIDENCE WHERE APPLICABLE:

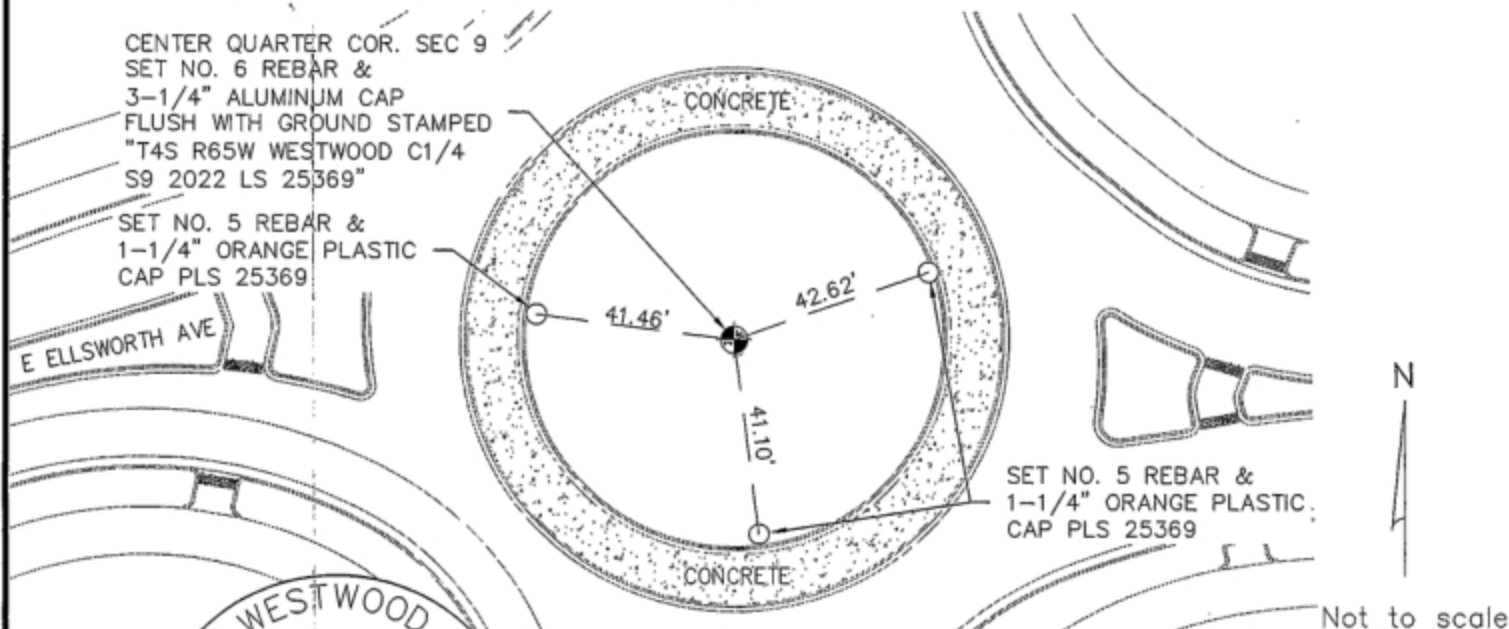

5. CERTIFICATION

This is to certify that I was in responsible charge of the surveying work described in this record and that to the best of my knowledge the information presented herein is true and correct.

Name (Please Print): WILLIAM F. HESSELBACH JR.

Firm Name: WESTWOOD PROFESSIONAL SERVICES, INC.

Firm Address: 10333 E. DRY CREEK RD, SUITE 240

ENGLEWOOD, CO 80112

Phone: (720) 249-3584

LOCATION DIAGRAM

1" = 1 Mile

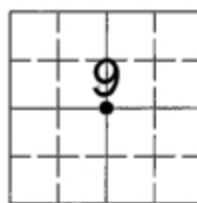

● = Location of Monument



Signature/Date through Seal

7. SEC 9 T 4 S R 65 W, 6th P.M.
COUNTY ARAPAHOE INDEX REF NUMBER 11-T

**8. SEC _____ T _____ R _____, _____ P.M.
COUNTY _____ INDEX REF NUMBER _____

** To be used only for monuments located on county lines



Rev.05/23/2019

CENTER QUARTER COR. SEC 9
SET NO. 6 REBAR &
3-1/4" ALUMINUM CAP
FLUSH WITH GROUND STAMPED
"T4S R65W WESTWOOD C1/4
S9 2022 LS 25369"

SET NO. 5 REBAR &
1-1/4" ORANGE PLASTIC
CAP PLS 25369

E ELLSWORTH AVE



Stamping on Cap

a. Date of field Work to Establish, Restore or Rehabilitate Monument: 09/26/2022

b. Date Monument was used as a Control corner: 09/27/2022

(Surveyor, do not fill in)

ACCEPTED

DEC 31 2022

COLO. ST. BD. OF LIC.
FOR ARC, PE & PLS

RECEIVED AT OFFICE OF THE COUNTY CLERK
_____ COUNTY

BY: _____

DATE: _____

Record to be filed numerically by Index Reference Number, then alphabetically by letter in the index reference number, then under appropriate Township, Range, and Meridian.